



LINK

LIFTABLE

SUSPENSIONS

INSTALLATION INSTRUCTIONS

PARTS LIST

DURAMAX INTEGRATED AIR WITH GT
CONTROL MODULE (800A0265)

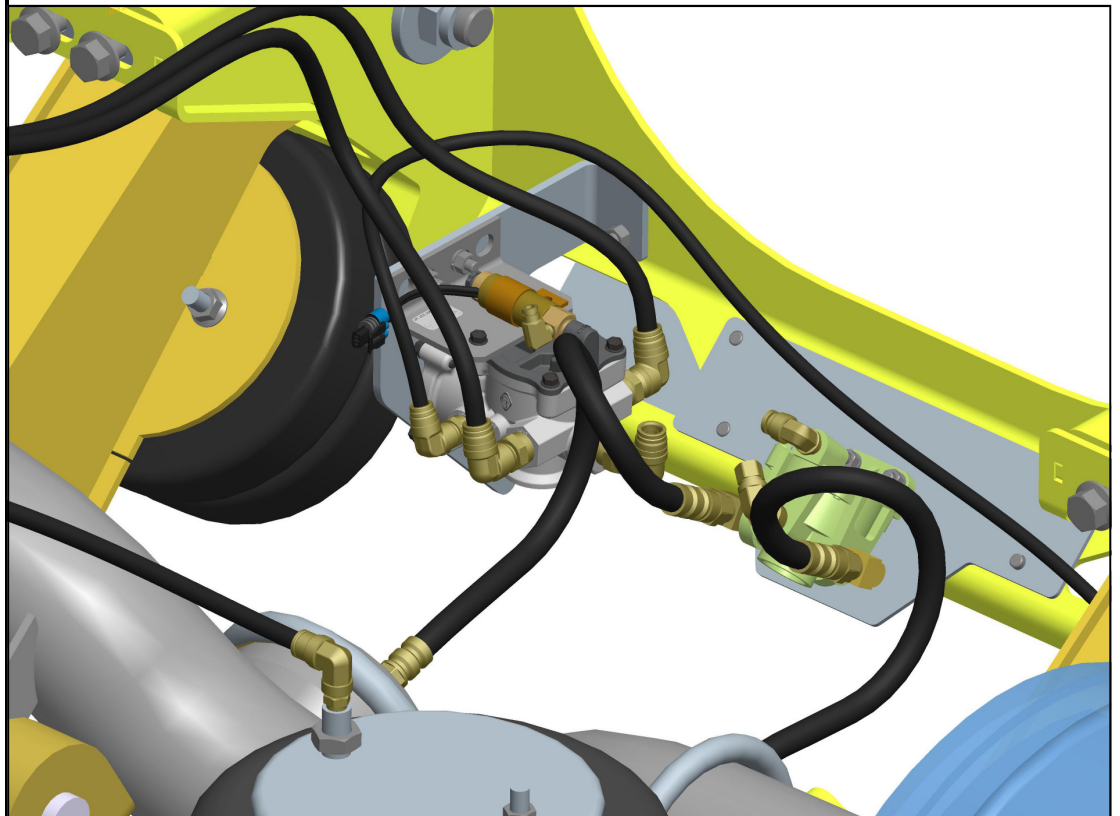

Link Mfg. Ltd.
223 15th St. N.E.
Sioux Center, IA USA
51250-2120

(712) 722-4874
Fax (712) 722-4876

**QUESTIONS?
CALL CUSTOMER
SERVICE
1-800-222-6283**

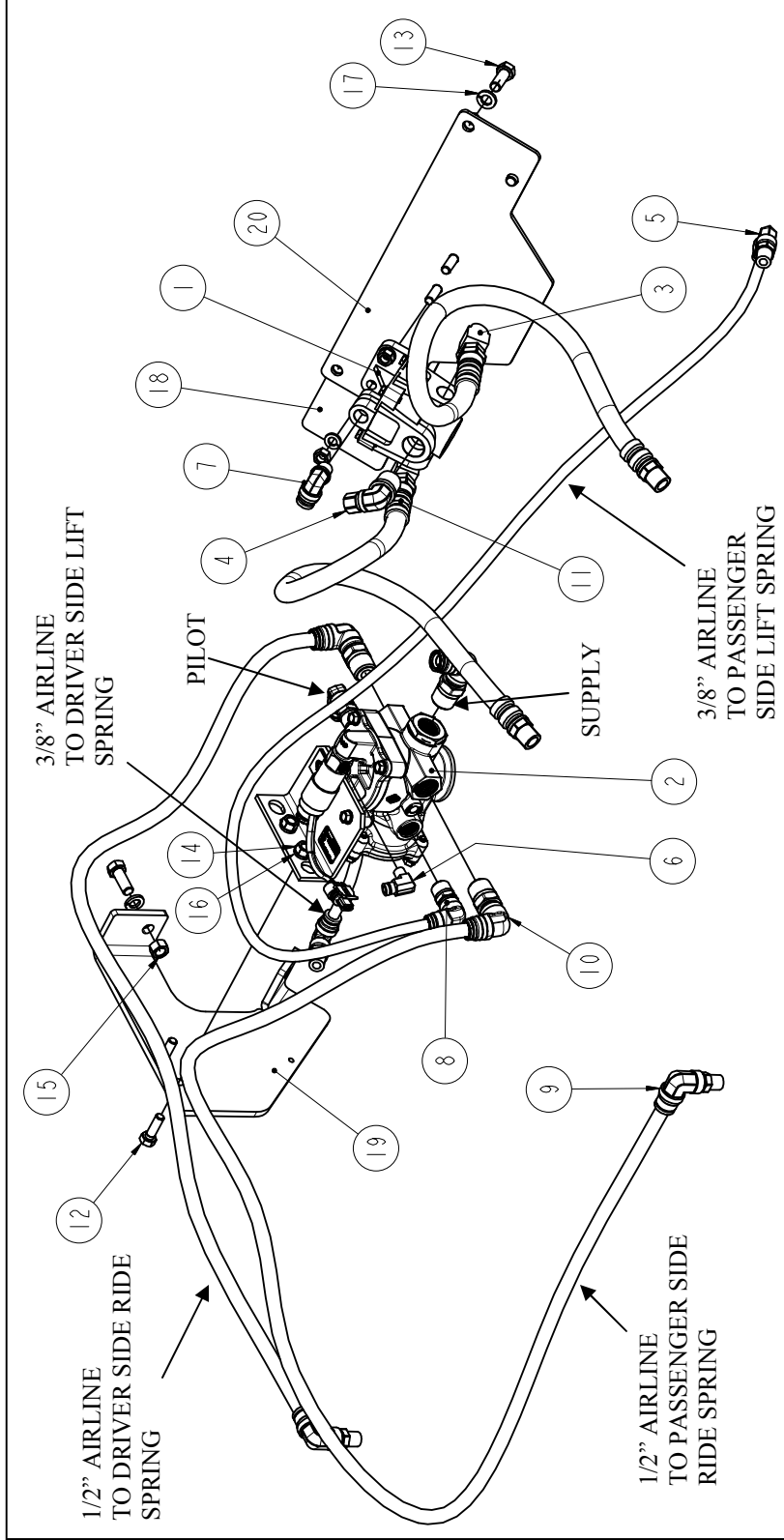

ITEM	PART NUMBER	DESCRIPTION	QTY
1	1301-0508	RELAY VALVE, RG-2, MIDLAND	1
2	13010571	LIFT AXLE CONTROL MODULE	1
3	1302-2102	ELBOW, 90 STREET (3/8-NPT)	2
4	1302-4041	ELBOW-3/8 TB, 1/2 M-NPT	1
5	1302-5094	ELBOW-SWIV, 3/8 TB, 1/4 M-NPT	2
6	1302-5100	ELBOW, 1/4 TB 1/8 M-NPT, PUSH-IN DOT	1
7	1302-5104	ELBOW-3/8 TB, 1/4 M-NPT	1
8	13025095	ELBOW-SWIV 90 - 3/8" TB X 3/8" MNPT DOT	2
9	13025097	ELBOW-SWIV, 1/2 TB, 1/4 M-NPT	2
10	13025099	ELBOW-SWIV 90 - 1/2" TB X 1/2" MNPT DOT	3
11	13029972	ASSEMBLY-AIR BRAKE HOSE (26 IN.)	2

12	140B-1008	5/16 X 1 UNC HEX CAP SCR (GR 8) O&P	4
13	140B-1208	3/8 X 1 UNC HEX CAP SCR (GR 8) O&P	6
14	1470-1000	5/16 UNC HEX NUT (GR B)	4
15	1470-1200	3/8 UNC HEX NUT (GR B)	2
16	1485-1000	5/16 LOCK WASHER	4
17	1485-1200	3/8 LOCK WASHER	6
18	80002131	MOUNT PLATE, BRAKE VALVE	1
19	80002133	BRACKET, VALVE MOUNTING	1
20	800A0262	MOUNT PLATE WELDMENT, BRAKE VALVE	1

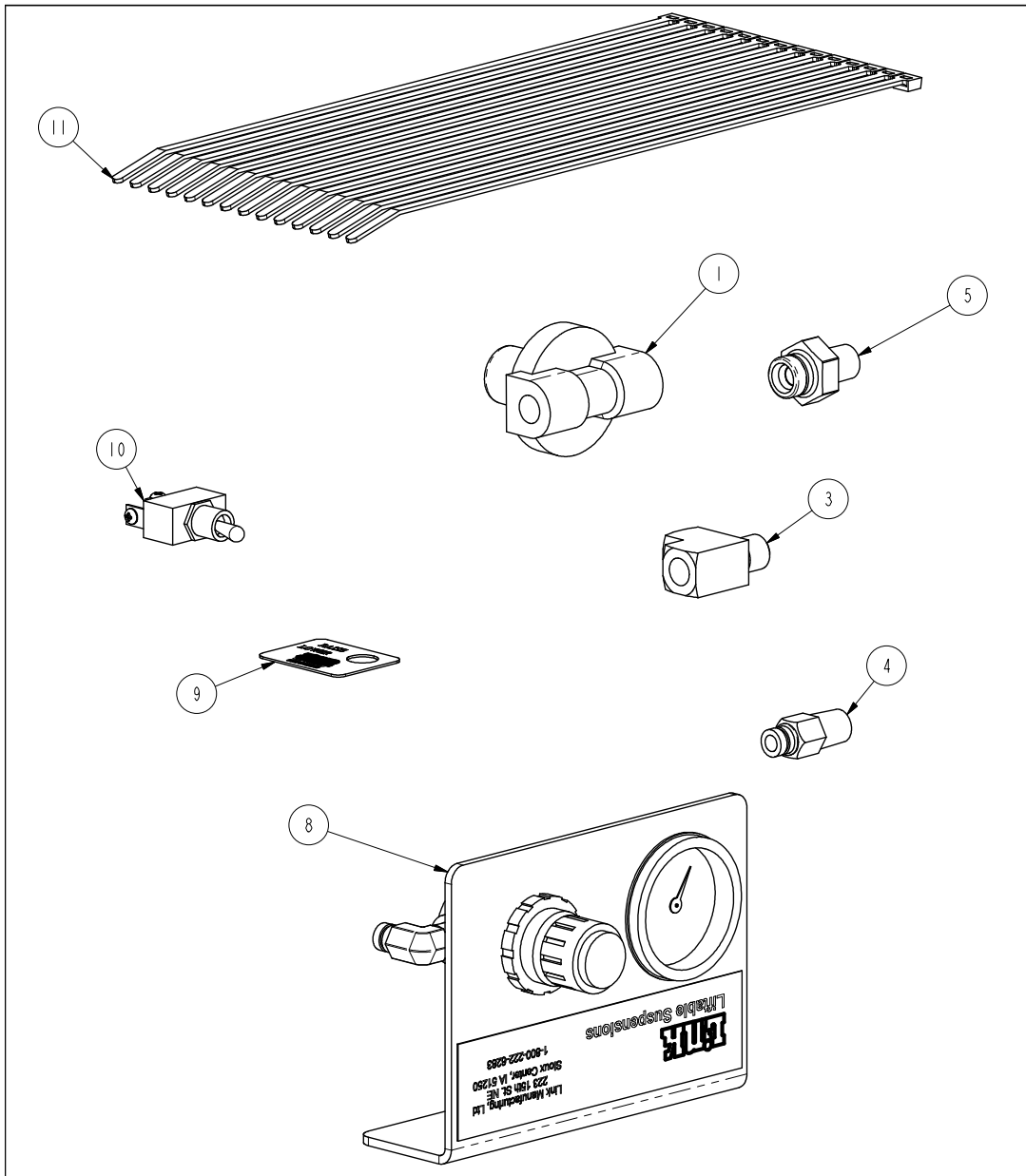

ITEM	PART NUMBER	DESCRIPTION	QTY
1	1301-0084	VALVE-PRESSURE PROTECTION	1
2	1302-0090	AIRLINE-NYLON, .250 O.D., BULK (NOT SHOWN)	30 FT
3	1302-2123	STREET TEE, 1/4 F-NPT 1/4 M-NPT	1
4	13025046	CONNECTOR, 1/4 TB 1/4 M-NPT	1
5	13025051	CONNECTOR-MALE, 1/2 TB, 1/4 NPT	1
6	1303-4000	AIRLINE-NYLON, .375 O.D., BULK (NOT SHOWN)	20 FT
7	1303-5000	AIRLINE-NYLON, .500 O.D., BULK (NOT SHOWN)	25 FT
8	13501018	AIR CONTROL ASSEMBLY	1
9	1500-1318	PLATE-SWITCH, LIFT	1
10	1505-0350	SWITCH-TOGGLE	1
11	1506-0081	NYLON CABLE TIE, 11" LONG	14
12	1509-2000	0.375 CORRUGATED LOOM, BULK (NOT SHOWN)	10 FT

NOTES:

- 1) Use 1/4", 3/8", and 1/2" DOT airline for all plumbing between fittings as shown per figure 2. Use brass DOT fittings for all plumbing connections. Use 14-gage primary wire for all electrical connections.
- 2) Considerations should be made to route all wiring and airline in protective locations away from any moving parts.
- 3) Cable ties or other fastening devices may be required to secure airline, wire and/or fittings to truck/suspension.
- 4) Apply Permatex #807 or comparable anaerobic pipe thread sealant to fill three exterior pipe threads on brass fittings and tighten 1-1/2 revolutions beyond hand tight.

Non-Steer suspension with lift axle up when ignition is off.

FIG. 1

PLUMBING INSTRUCTIONS

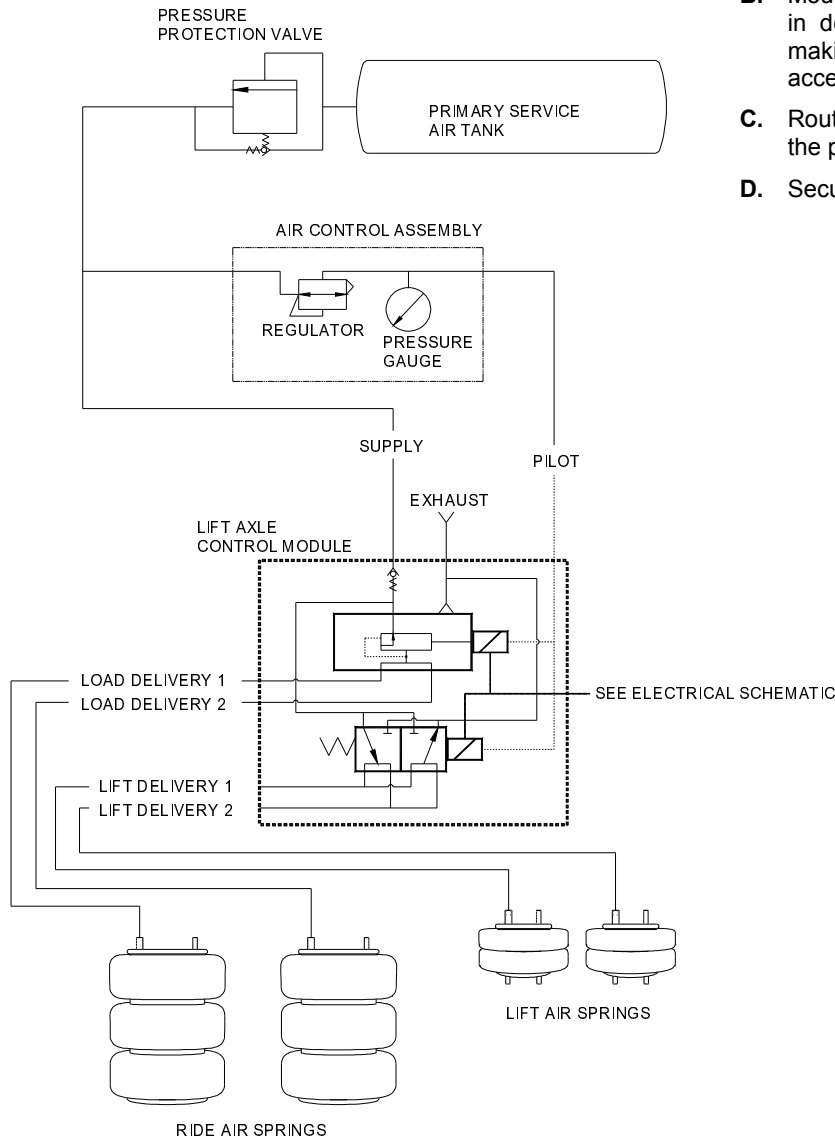

- A. Connect the pressure protection valve directly to the air supply tank on the truck. **IMPORTANT:** Make sure direction of flow for the system matches flow indicator on the pressure protection valve.
- B. Mount the Air Control Assembly to the truck in desired location for driver convenience, making sure the air controls are easily accessible.
- C. Route all airlines to you suspension using the plumbing schematics in Figures 1 and 2.
- D. Secure any loose components to the truck..

ITEM	PART DESCRIPTION
1	VALVE-PRESSURE PROTECTION
2	REGULATOR—AIR PRESSURE
3	GAUGE—AIR PRESSURE
4	LIFT AXLE CONTROL MODULE

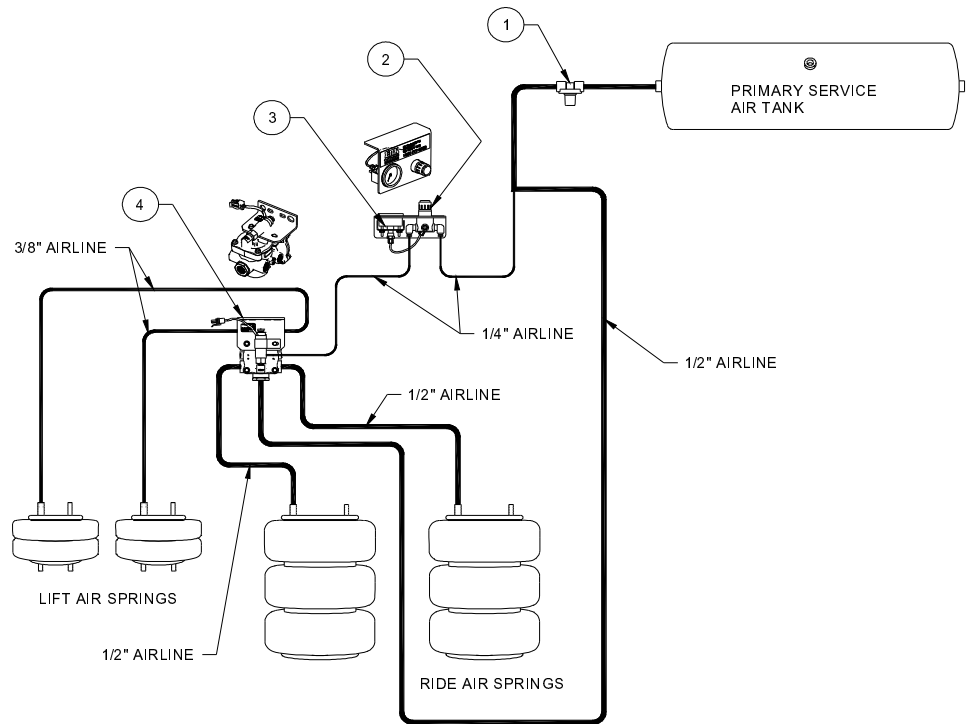

FIG. 2

ELECTRICAL INSTRUCTIONS

CAUTION: Always disconnect the battery while working with the vehicle's electrical system.

- A. Make all wiring connections to fuse, truck, and toggle switch as shown in Figure 3. **IMPORTANT:** Make sure that the toggle switch is wired so that the lift axle is down when the switch is on.
- B. Ground one of the white wires from the solenoid valve. **NOTE:** Make sure the 12VDC source is switched (turns off with the key).
- C. Mount the toggle switch and toggle switch plate to the interior of the truck in a desired location. **NOTE:** Make sure that lift axle position correlates with "Raise"/"Lower" position on toggle switch plate (tab on toggle switch plate may need to be removed).
- D. When all electrical connections have been made, reconnect the battery, pressurize the system and tighten any fittings that are leaking.

ELECTRICAL SCHEMATIC

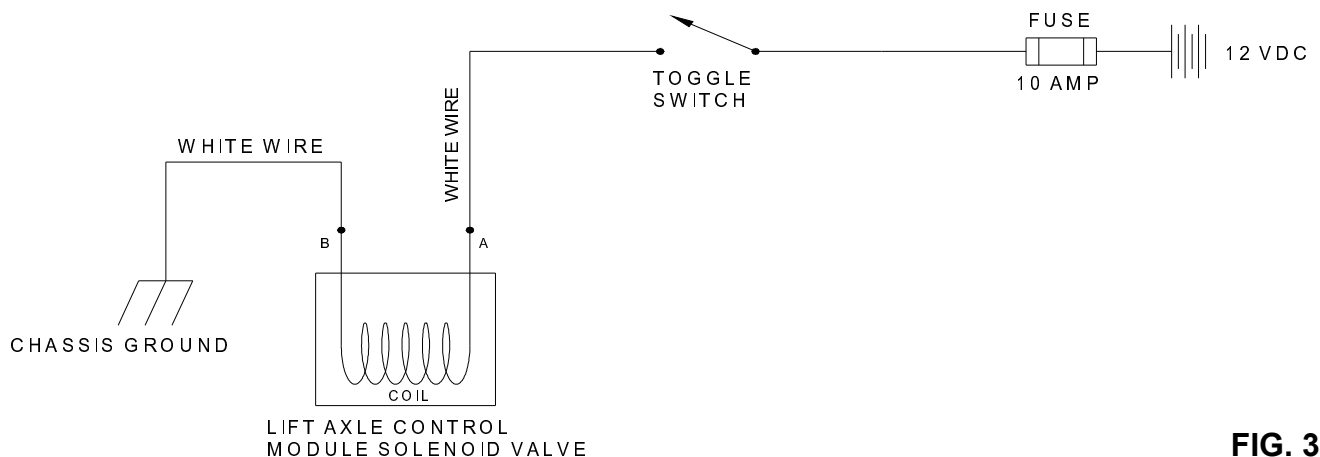

FIG. 3