

**SmartValve™**  
Electronic Height Control

**Link®**

Link Mfg. Ltd.  
223 15th St. N.E.  
Sioux Center, IA USA  
51250-2120  
[www.linkmfg.com](http://www.linkmfg.com)

**QUESTIONS?  
CALL CUSTOMER  
SERVICE  
1-800-222-6283**

# INSTALLATION INSTRUCTIONS

## SMARTVALVE 6X4 TWO BUTTON

FREIGHTLINER—H00700R21A  
KENWORTH—H00700R22A  
INTERNATIONAL—H00700R23A  
PETERBILT—H00700R24A  
VOLVO—H00700R25A  
MACK—H00700R26A  
HINO—H00700R28A



**IMPORTANT:** IT IS IMPORTANT THAT THE ENTIRE INSTALLATION INSTRUCTIONS BE READ THOROUGHLY BEFORE PROCEEDING WITH THE INSTALLATION.





## 1. INTRODUCTION

Thank you for choosing a Link SmartValve. We want to help you get the best results from this height control valve and to operate it safely. This instruction contains information to assist in the installation of the SmartValve. This instruction is intended solely for use with this product.

All information in this instruction is based on the latest information available at the time of printing. Link Manufacturing reserves the right to change its products or manuals at any time without notice.

Damaged components should be returned to Link with a pre-arranged Returned Materials Authorization (RMA) number through the Customer Service Department. The damaged component may then be replaced if in compliance with warranty conditions.

## 2. SAFETY SYMBOLS, TORQUE SYMBOL, and NOTES

	<b>DANGER</b> indicates a hazardous situation which if not avoided, will result in death or serious injury.
	<b>WARNING</b> indicates a potentially hazardous situation which, if not avoided, could result in death or serious injury.
	<b>CAUTION</b> indicates a potentially hazardous situation which, if not avoided, could result in minor or moderate injury.
	<b>NOTICE</b> indicates a potentially hazardous situation which, if not avoided, may result in property damage.
	<b>TORQUE</b> indicates named fasteners are to be tightened to a specified torque value.
<b>NOTE:</b>	A Note provides information or suggestions that help you correctly perform a task.

## 3. SAFE WORKING PRACTICES

### CAUTION

When handling parts, wear appropriate gloves, eye-glasses, ear protection, and other safety equipment.

### CAUTION

Proper tightening of fasteners is important to the performance and safety of the suspension. Follow all torque specifications throughout the instructions.

## 4. CAN BUS AND SETUP TOOL NOTICE

### 4.1

The vehicle must be equipped with a functioning J1939 CAN BUS (250KBPS) network for proper operation of the SmartValve Kit.

### 4.2

A Link H00700PK kit is required to properly install the SmartValve.

### 4.3

The SmartValve setup tool must be pre-installed on a Windows based computer.

### 4.4

If in doubt, consult with a local dealer or SmartValve service for more information.

## 5. TOOLS REQUIRED

- Wire Cutter
- Wire Stripper
- Drill bits 3/5/64": Pushbutton, Letter "D": LED
- Drill
- Tubing Cutter
- Screwdriver
- Tape Measure
- Wrenches 7/16", 1/2"
- Multi-meter Volt-Ohm Tester
- Crimping Tool (Red Barrel Connector)
- Center Punch
- Soap Solution (For Leak Tests)
- Deburring Tool (For Pushbutton Switch Holes)
- Torque Wrench With 7/16" Socket

## 6. MATERIALS REQUIRED

- Nylon cable ties
- Electrical tape
- Heat shrink tubing (if required)
- Misc. air fittings
- Dielectric grease (recommended: DeoxIT grease Type L260Np)-for electrical connections.
- Alcohol cleaner- for cleaning of dash surface prior to installation of decal detail.

## 7. SYSTEM OVERVIEW

The H00700R2xA series of kits provide control of the chassis suspension for Class 8 trucks in a 6X4 configuration that is not equipped with a rear suspension dump switch. The following features are provided:

- Accurate maintenance of Standard Ride height with reduced air consumption relative to mechanical valves.
- Dump the rear suspension for trailer coupling operations.
- Raise the rear suspension to a settable height above standard height to improve trailer pick up and drop off.
- Two momentary push buttons (Raise and Lower) are used to control the system and a LED provides status.

The SmartValve system limits the dump and raise features to when the truck is stopped or moving at slow speeds. The system will automatically return from the over-height setting to standard height when wheel speed exceeds 7 mph. The SmartValve system can be set to automatically return to vehicle standard ride height from the dump position when wheel speed exceeds 17 mph.

## 8. VEHICLE PREPARATION PROCEDURE

### 8.1

#### Suspension Ride Height

1. Measure tractor suspension ride height per manufacturer's instructions.
2. Compare to manufacturers recommended dimension.
3. Measure tractor ride height at lowered (dumped) position.
4. These dimensions will be used in later adjustments.

### 8.2

#### Air Leak Check

1. Check for air leaks at the tube ends and air spring connections using a soap solution before removing the air lines.

### 8.3

#### Valve Removal

**⚠WARNING** Vehicle must be in park and the engine turned off.

**NOTE:** Before removing the airlines, mark or label each line (supply, air springs, dump pilot, etc.)

For vehicles equipped with a dash mounted suspension dump switch:

1. Exhaust the air from the suspension air springs using the "Dump" control switch.
2. Exhaust all air from the reservoir that supplies air pressure to the height control valve.

**⚠CAUTION**

3. Make sure the tractor suspension is fully lowered to the stops and all suspension air springs are unpressurized before continuing.
4. Disconnect and plug the dump pilot line at the height control valve.
5. Disconnect the supply and suspension air lines from the height control valve.
6. Remove the linkage bolt at the end of the height control valve lever (Save this fastener)
7. Remove the valve mounting fasteners. (Usually two)
8. Remove the valve from the mounting bracket.
9. Set the valve aside for reference.

For vehicles without a suspension dump valve:

1. Exhaust all air from the reservoir that supplies air pressure to the height control valve.
2. Remove the linkage bolt at the end of the height control valve lever (Save this fastener)
3. Push the end of the valve lever downward to exhaust the suspension air springs.

**⚠CAUTION**

4. Make sure the tractor suspension is fully lowered to the stops and all suspension air springs are unpressurized before continuing.
5. Disconnect the supply and suspension air lines from the height control valve.
6. Remove the valve mounting fasteners. (Usually two)
7. Remove the valve from the mounting bracket.
8. Set the valve aside for reference.

### 8.4

#### Harness Routing

1. Locate harness, on "material supplied page" for your truck brand for part number.
2. Cover or tape loose wires at the end of the harness to make the wires easier to route.
3. Route the harness along the inside of the tractor frame from the valve bracket to the cab firewall.

**⚠CAUTION**

The harness must be routed away from moving parts. Avoid any pinch points or heat sources that may damage the harness.

## 8.5

### Valve Air Line Preparation

- Inspect the valve air lines for damage and replace if necessary.
- Using a tubing cutter, squarely trim about ½" length from the end of each tube.
- Make sure the end of the airline tubes are clean and cut squarely on the ends.

**NOTE:** Preparing the tube ends is required to create a good seal between the airline tubing and valve fittings.

## 9. SMARTVALVE INSTALLATION

### 9.1

**NOTE:** Refer to the installation diagram

- FREIGHTLINER
- KENWORTH-OPTION 1 & 2
- INTERNATIONAL
- PETERBILT-OPTION 1 & 2
- VOLVO
- MACK.
- HINO

### 9.2

1. Install the SmartValve Assembly to the existing valve bracket.
2. Torque the mounting studs between 70 to 80 in-lbs using a 7/16" wrench or socket.
3. Clean the ends of the air tubes before assembly into the new valve.
4. The supply line from the reservoir connects to the port at the end of the valve labeled "SUPPLY".
5. There are two ports labeled "SUSP". The suspension air spring lines will be inserted into these ports.

**NOTE:** It may be necessary to change direction of linkage bolt/pin for added clearance or for straighter alignment of the linkage rod.

### 9.2

#### Electrical/Harness Connections

**NOTE:** Refer to page 7 to connect the SmartValve and auxiliary components to the harness.

**NOTE:** Apply DeoxIT Grease Type L260Np or equivalent to the 12 pin valve connector as shown in figure 1.

1. Plug the 12 pin gray SmartValve electrical connector into the gray connector at the end of the harness – Be sure to push the connectors completely together until they "click".
2. Wrap electrical tape around the connector seam.

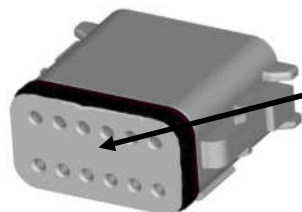

**Figure 1.**  
Apply grease on the socket and pin area of the connector.

## 9.3

### Dash Preparation: LED and Switch Mounting

**NOTE:** Prepare the dash in the cab as shown on page 7.

1. Locate a convenient place on the dash to mount the LED and two switches.
2. Drill the hole for the dual LED using drill size D (.246")
3. Drill the holes for the pushbutton switches below the LED hole using a 35/64" drill bit

**NOTE:** If necessary use a de-burring tool to clean the holes.

**NOTE:** Allow room for the decals in figure 2 (H17082) between the drilled holes.

4. Push the LED and switches into the dash until they click into place. (no hardware needed)

**NOTE:** Clean dash surface with alcohol to ensure a good bond between dash and decal.

5. Apply the "SMARTVALVE STATUS" decal above the LED.
6. Apply the "SUSP RAISE" decal above the raise switch.
7. Apply the "SUSP LOWER" decal above the lower switch.
8. Apply the "SmartValve Instructions" decal within view of the driver.

**NOTE:** If a standard dump switch is installed on the dash, it may be desirable to tape or label it as inactive to avoid driver confusion.



**Figure 2.**  
Decal Detail

Includes 4 Decals

SMARTVALVE  
STATUS

Decal PN:  
H17082

SUSP RAISE

SUSP LOWER

## 9.4

### Cab Wiring: Interface Box Connections

**NOTE:** Refer to the wiring drawing on page 8 for these connections.

#### Pin terminal information:

1. The red pin terminals are crimped to the ends of the SmartValve harness and hook-up wires. The terminals are used to connect the harness and other wires to the interface box. The wires, with terminals attached, are pushed into the appropriate contacts on the front of the green connectors as shown on the interface box wire drawing.
2. The pin terminals can be disconnected from the green connectors by fully depressing the release tab on the top of the connector.

**NOTE:** All wires should be stripped 1/4" to accommodate the pin terminals (H18195) and splice terminals.

## 9.5

### Harness Wiring

1. Locate the end of the main SmartValve harness. Cut the harness to desired length or coil up the excess length. Leave enough length to connect to the interface module.
2. Prepare the SmartValve harness wires and attach the pin terminals.
3. Attach the SmartValve harness wires to the proper connector locations on the interface module.

## 9.6

### Dash Control Wiring

Use the hook-up wire (H18211) for the following steps:

1. Locate the pushbutton switches and LED assembly as shown in the drawing.
2. Use the pin terminals, hook-up wire, and wire splices to complete the wiring to the interface module (H18130SVM1).
3. Locate a convenient place behind the dash or lower trim for the interface module (H18130SVM1). Secure the interface module using the included cable ties or other fasteners.

## 9.7

### Power and Ground Wiring

**NOTE:** Refer to page 8 for connections.

Using the splices, H17641 and M15724 provided in the HPB700-28 kit, wire the following:

**NOTE:** If auxiliary circuits are available on the vehicle power panel, they may be used with the appropriate connectors and 10 amp fuses instead of the supplied fuse taps. Use the wire splice connectors if needed to connect the wires to the fuse assembly.

1. Locate the 12-volt fuse panel.
2. A red wire (battery) is spliced to the wire from the fuse tap. This wire connects to the un-switched 12VDC battery power.
3. An orange wire (ignition) is spliced to the wire from the other fuse tap. This wire connects to the switched 12VDC ignition power.
4. Plug the fuses into available/appropriate slots in the 12-volt fuse panel.
5. Note: Battery and ignition power must not time out or drop out during starting
6. Cut the red, orange and black wire to the proper length.
7. Attach the pin terminals to the red, orange, and black hook-up wire.
8. Connect the red wire from pin 1 on the interface panel to fused 12VDC battery power.
9. Connect the orange wire from pin 2 on the interface panel to a fused ignition power signal.
10. Connect the black ground wire from pin 3 on the interface panel to chassis ground\*. A ring terminal is provided if needed.

**NOTE:** The black ground wire must be connected to a known "good" chassis ground. The resistance must be no greater than 2 ohms as measured from the selected ground connection point to the negative battery terminal.

## 9.8

### Can Bus Wiring

**NOTE:** Refer to page 7 for connections.

1. Locate the CAN bus wires on the tractor. SmartValve must be connected to a 250kb rated Can Bus signal. The wire colors are typically yellow and green.
2. Connect the yellow and green (twisted pair) from the harness to these two wires.

**NOTE:** A "Y" harness is included in the kit. This harness can be used on most vehicles to improve the installation process.

**NOTE:** For tractors with 500kb CanBus an additional module is required for the SmartValve to function. Link Manufacturing part number: H00701SDC

For HINO trucks with 500kb CanBus use Link part number: H00701SDCH

**9.9**  
SmartValve Setup Tool

- 1. Refer to H00700PK Instructions (H17640) to install software or set desired ride heights.
  - a. **NOTE:** The SmartValve setup tool must be pre-installed on a Windows based computer before setting these options.



**Figure 3.**  
SmartValve Decal

**9.10**  
SmartValve Decal and Reference Card

A SmartValve decal is included with this kit. The decal may be placed on the outside of the tractor to identify which vehicles are equipped with the SmartValve. Make sure the area is clean and dry before installation.

The SmartValve quick reference card should be placed in an accessible location within the cab of the vehicle. Note: The card is punched for installation into a standard binder.

**Link**

**SmartValve**  
Electronic Height Control

Lowering Rear Suspension

- Press and release the **SUSP LOWER** push button while moving less than 10 MPH<sup>1</sup> to dump the rear suspension.
- Press and release either push button to return to normal height.
- The truck will return to normal height if the truck exceeds 17 MPH<sup>1</sup> while dumped.

Raising Rear Suspension

- Press the **SUSP RAISE** switch while moving less than 10 MPH<sup>1</sup> to raise the rear suspension about 2 inches for increased ground clearance during drop and hook operation.
- To return to normal ride height press either switch for one second.
- The truck will return to standard ride height automatically if the truck speed is greater than 10 MPH<sup>1</sup> when raised.
- If the ignition is turned "off" and the truck is left in the raised mode, the vehicle will remain in the raised mode until the ignition is turned "on" and a pushbutton is pressed.

Reducing Tag Axle Pressure For Traction

- Press and hold the **SUSP LOWER** push button for 3 seconds while moving less than 10 MPH<sup>1</sup> to dump the tag axle suspension only.
- The tag axle will return to normal when the truck exceeds 17 MPH<sup>1</sup>

Operation Summary

Current Status	Desired Mode	Action Required
Normal	Dump	Press SUSP LOWER button
Dump	Normal	Press either switch for about 1 second
Normal	Raise	Press SUSP RAISE button
Raise	Normal	Press either switch for about 1 second
Normal	Tag Axle Dumped	Press SUSP LOWER button until LED is on
Tag Axle Dumped	Normal	Press SUSP LOWER button until LED is off

<sup>1</sup>Note: Speed thresholds are typical but may vary in some cases.

H18023  
LINK MFG. 8/2021

**Figure 4.**  
Quick Reference Card



9.11 Electrical/Harness  
Connections Diagrams

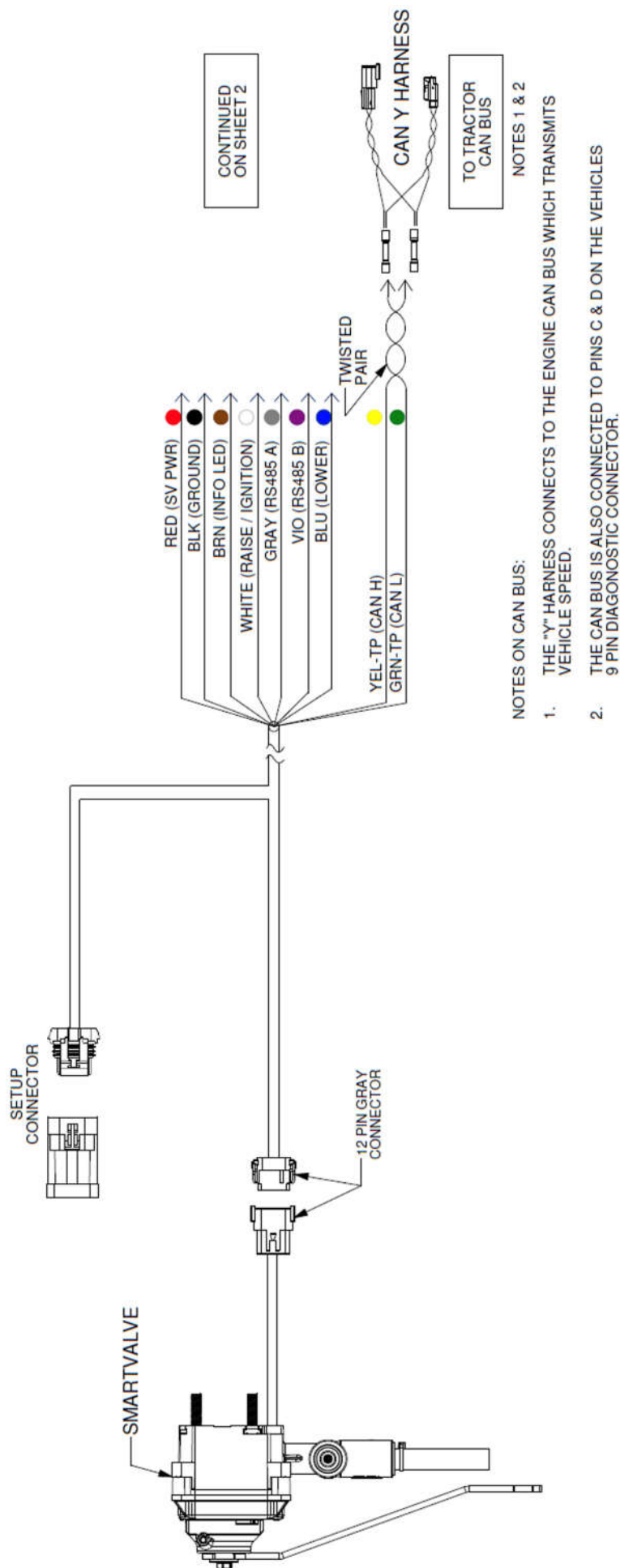
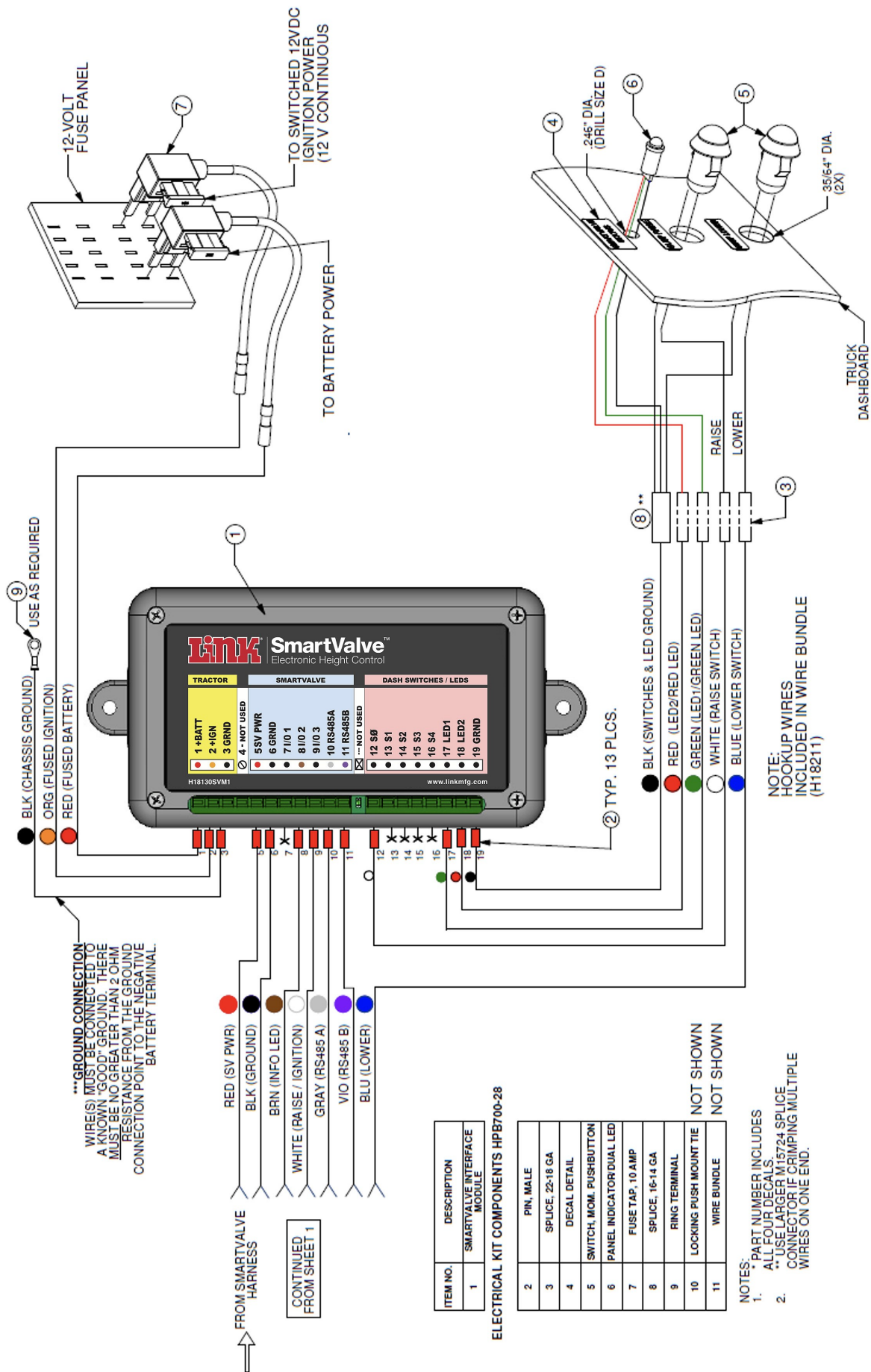

Figure 5.  
Setup Connector

Figure 6. Electrical/Harness Connections





## 10.FREIGHTLINER (H00700R21A) MATERIALS SUPPLIED

H00700R21A (2410 SERIES, EHCV KIT SMARTVALVE & DUMP VALVE)			
ITEM	QTY	LINK PART #	DESCRIPTION
1.1	1	H02410RF-1	2410 SERIES, EHCV VALVE
1.2	1	H18130SVM1	SMARTVALVE INTERFACE MODULE
1.3	1	HPB700-28	ELECTRICAL KIT
1.4	1	HPB700-55	HARDWARE & PLUMBING KIT
1.5	1	H18007	HARNESS, CONTROL
1.6	1	H18087S	CAN Y HARNESS
1.7	1	HPB700-52	INSTALLATION INSTRUCTIONS/DECAL KIT

H02410RF-1 (2400 SERIES, EHCV VALVE)			
ITEM	QTY	LINK PART #	DESCRIPTION
2.1	1	H02410RF-1A	LEVER POS. A. / STUD POS. A, B
2.2	1	H16060-08	SOFTWARE (CURRENT REVISION)

HPB700-28 (ELECTRICAL KIT)			
ITEM	QTY	LINK PART #	DESCRIPTION
3.1	1	H17628	PANEL INDICATOR (DUAL LED)
3.2	2	H17629	SWITCH, MOMENTARY PUSHBUTTON
3.3	8	H17641	BUTT CONNECTOR, 22-18 GA, CLEAR
3.4	4	M15724	BUTT CONNECTOR, 16-14 GA, BLUE
3.5	2	H18776	FUSE TAP, 10 AMP
3.6	2	H18783	MINI FUSE, 10 AMP
3.7	1	H17082	DECAL DETAIL
3.8	16	H18195	PIN, MALE
3.9	1	H14610	RING TERMINAL
3.10	2	H18210	LOCKING PUSH MOUNT TIE
3.11	1	H18211	WIRE BUNDLE

HPB700-55 (HARDWARE & PLUMBING KIT)			
ITEM	QTY	LINK PART #	DESCRIPTION
4.1	3	H16393	STEM, ELBOW – 3/8"
4.2	2	H17055	SMARTVALVE MOUNTING SPACER
4.3	2	H13404	WASHER, 1/4 X 1/2"
4.4	2	H13964	1/4-20 LOCKNUT

Figure 7. Freightliner (H00700R21A)

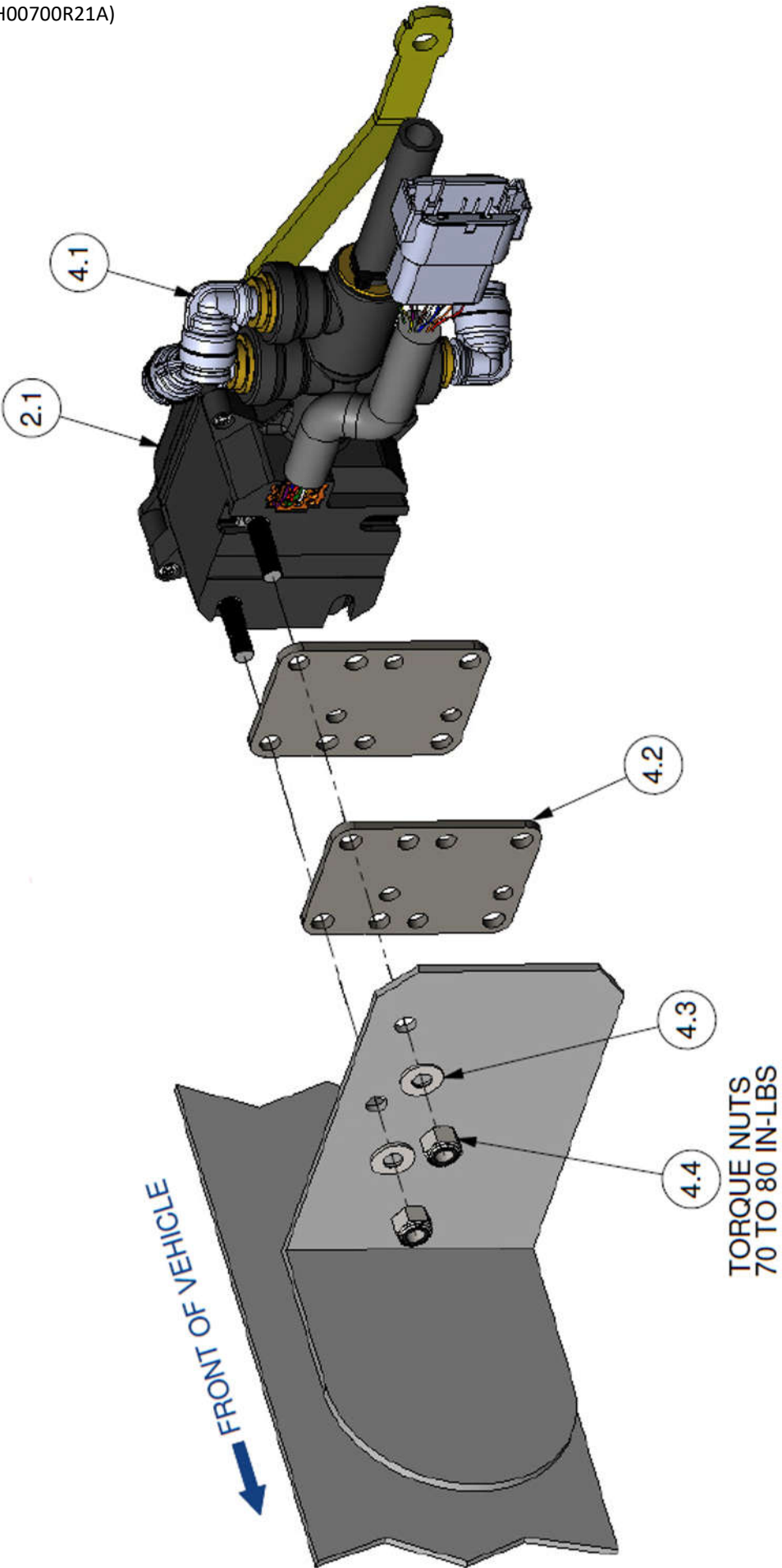

# 11.KENWORTH (H00700R22A)-OPTION 1 & 2 MATERIALS SUPPLIED

H00700R22A (2410 SERIES, EHC V KIT SMARTVALVE & DUMP VALVE)			
ITEM	QTY	LINK PART #	DESCRIPTION
1.1	1	H02410RG-1	2400 SERIES, EHC V VALVE
1.2	1	H18130SVM1	INTERFACE MODULE
1.3	1	HPB700-21	ELECTRICAL KIT
1.4	1	HPB700-56	HARDWARE & PLUMBING KIT
1.5	1	H18007	HARNESS, CONTROL
1.6	1	HPB700-52	INSTALLATION INSTRUCTIONS / DECAL KIT
1.7	1	H18016S	CAN Y HARNESS

H02410RG-1 (2400 SERIES, EHC V VALVE)			
ITEM	QTY	LINK PART #	DESCRIPTION
2.1	1	H02410RG-1A	LEVER POS. A. / STUD POS. B, C
2.2	1	H16060-08	SOFTWARE (CURRENT REVISION)

HPB700-28 (ELECTRICAL KIT)			
ITEM	QTY	LINK PART #	DESCRIPTION
3.1	1	H17628	PANEL INDICATOR (DUAL LED)
3.2	2	H17629	SWITCH, MOMENTARY PUSHBUTTON
3.3	8	H17641	BUTT CONNECTOR, 22-18 GA, CLEAR
3.4	4	M15724	BUTT CONNECTOR, 16-14 GA, BLUE
3.5	2	H18776	FUSE TAP, 10 AMP
3.6	2	H18783	MINI FUSE, 10 AMP
3.7	1	H17082	DECAL DETAIL
3.8	16	H18195	PIN, MALE
3.9	1	H14610	RING TERMINAL
3.10	2	H18210	LOCKING PUSH MOUNT TIE
3.11	1	H18211	WIRE BUNDLE

HPB700-56 (HARDWARE & PLUMBING KIT)			
ITEM	QTY	LINK PART #	DESCRIPTION
4.1	3	H16393	STEM, ELBOW 3/8"
4.2	1	H17055-1	MOUNTING PLATE/STUD ASSY
4.3	4	H13404	WASHER, 1/4 X 1/2"
4.4	4	H13964	1/4-20 LOCKNUT
4.5	1	H17055	SMARTVALVE MOUNTING SPACER

Figure 8. Kenworth (H00700R22A) Option 1

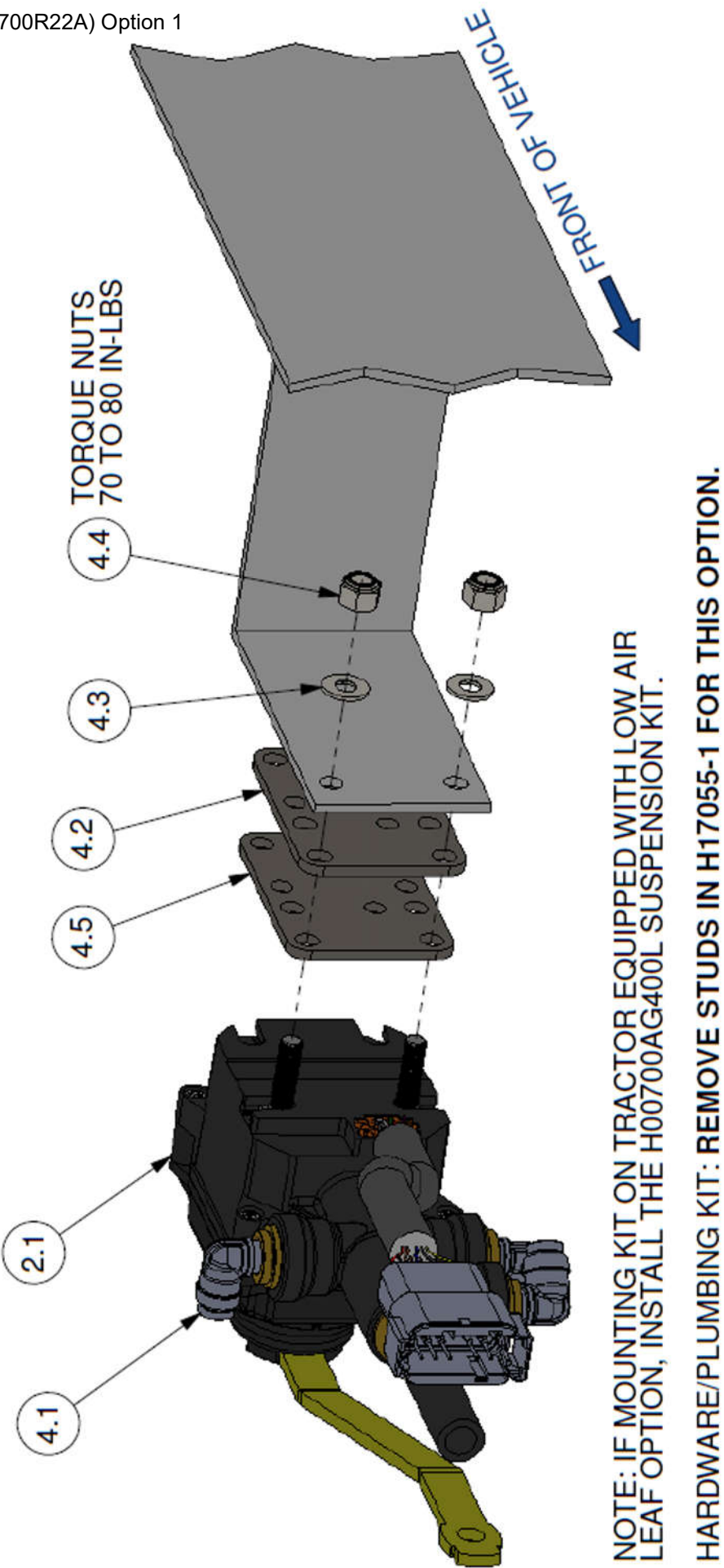
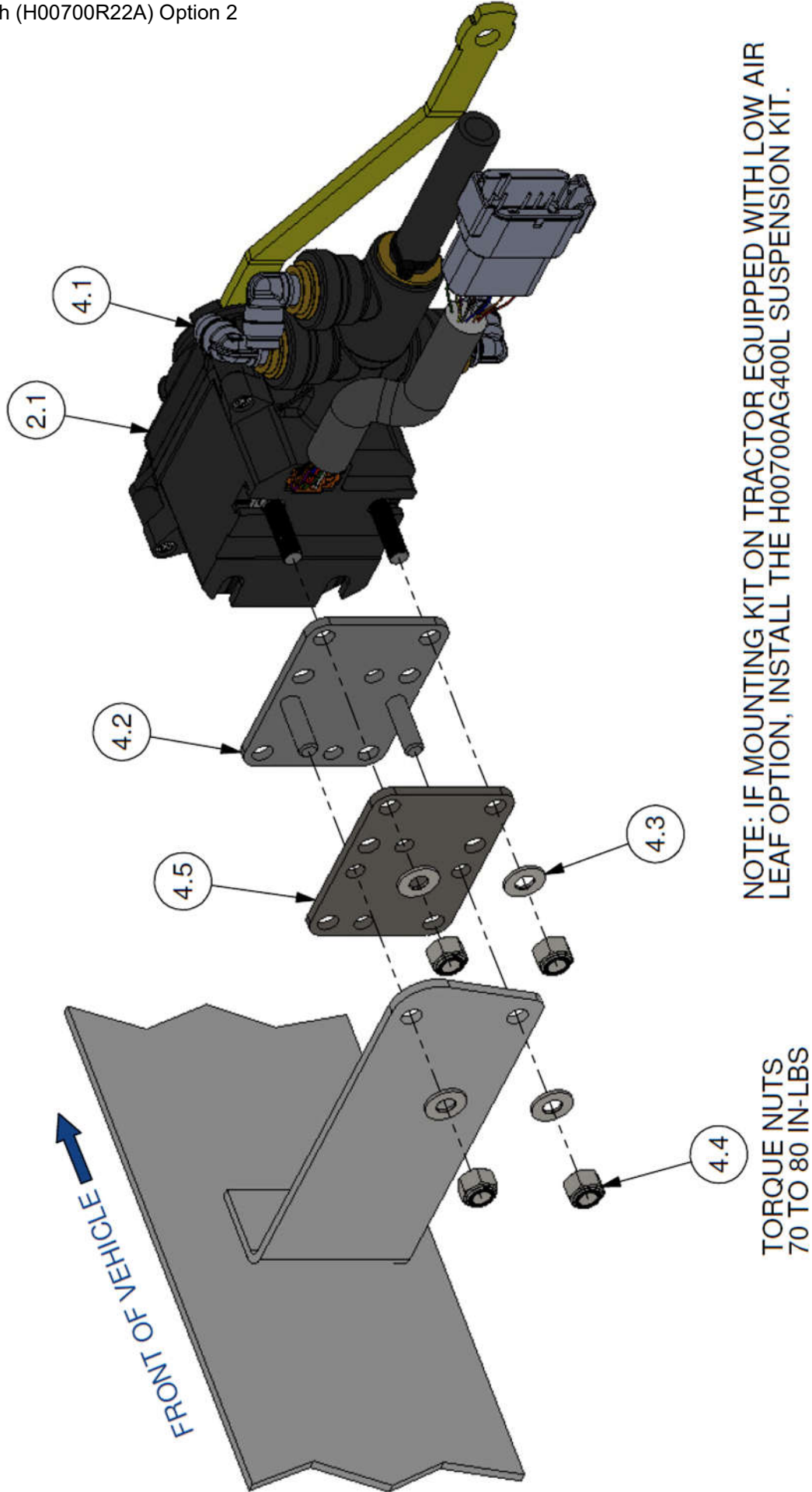

Figure 9. Kenworth (H00700R22A) Option 2



## 12.INTERNATIONAL (H00700R23A) MATERIALS SUPPLIED

H00700R23A (2410 SERIES, EHCV KIT SMARTVALVE & DUMP VALVE)			
ITEM	QTY	LINK PART #	DESCRIPTION
1.1	1	H02410RH-1	2410 SERIES, EHCV VALVE
1.2	1	H18130SVM1	SMARTVALVE INTERFACE MODULE
1.3	1	HPB700-28	ELECTRICAL KIT
1.4	1	HPB700-57	HARDWARE & PLUMBING KIT
1.5	1	H18007	HARNESS, CONTROL
1.6	1	HPB700-52	INSTALLATION INSTRUCTIONS & DECAL KIT
1.7	1	H18015S	CAN Y HARNESS
1.8	1	H18245	CAN Y HARNESS

H02410RH-1 (2400 SERIES, EHCV VALVE)			
ITEM	QTY	LINK PART #	DESCRIPTION
2.1	1	H02410RH-1A	LEVER POS. A. / STUD POS. B, C
2.2	1	H16060-08	SOFTWARE (CURRENT REVISION)

HPB700-28 (ELECTRICAL KIT)			
ITEM	QTY	LINK PART #	DESCRIPTION
3.1	1	H17628	PANEL INDICATOR (DUAL LED)
3.2	2	H17629	SWITCH, MOMENTARY PUSHBUTTON
3.3	8	H17641	BUTT CONNECTOR, 22-18 GA, CLEAR
3.4	4	M15724	BUTT CONNECTOR, 16-14 GA, BLUE
3.5	2	H18776	FUSE TAP, 10 AMP
3.6	2	H18783	MINI FUSE, 10 AMP
3.7	1	H17082	DECAL DETAIL
3.8	16	H18195	PIN, MALE
3.9	1	H14610	RING TERMINAL
3.10	2	H18210	LOCKING PUSH MOUNT TIE
3.11	1	H18211	WIRE BUNDLE

HPB700-57 (HARDWARE & PLUMBING KIT)			
ITEM	QTY	LINK PART #	DESCRIPTION
4.1	3	H16393	STEM, ELBOW 3/8"
4.2	1	H17060-1	MOUNTING PLATE/STUD ASSEMBLY
4.3	4	H13404	WASHER, 1/4 X 1/2"
4.4	1	H13964	1/4-20 LOCKNUT



Figure 10. International (H00700R23A)

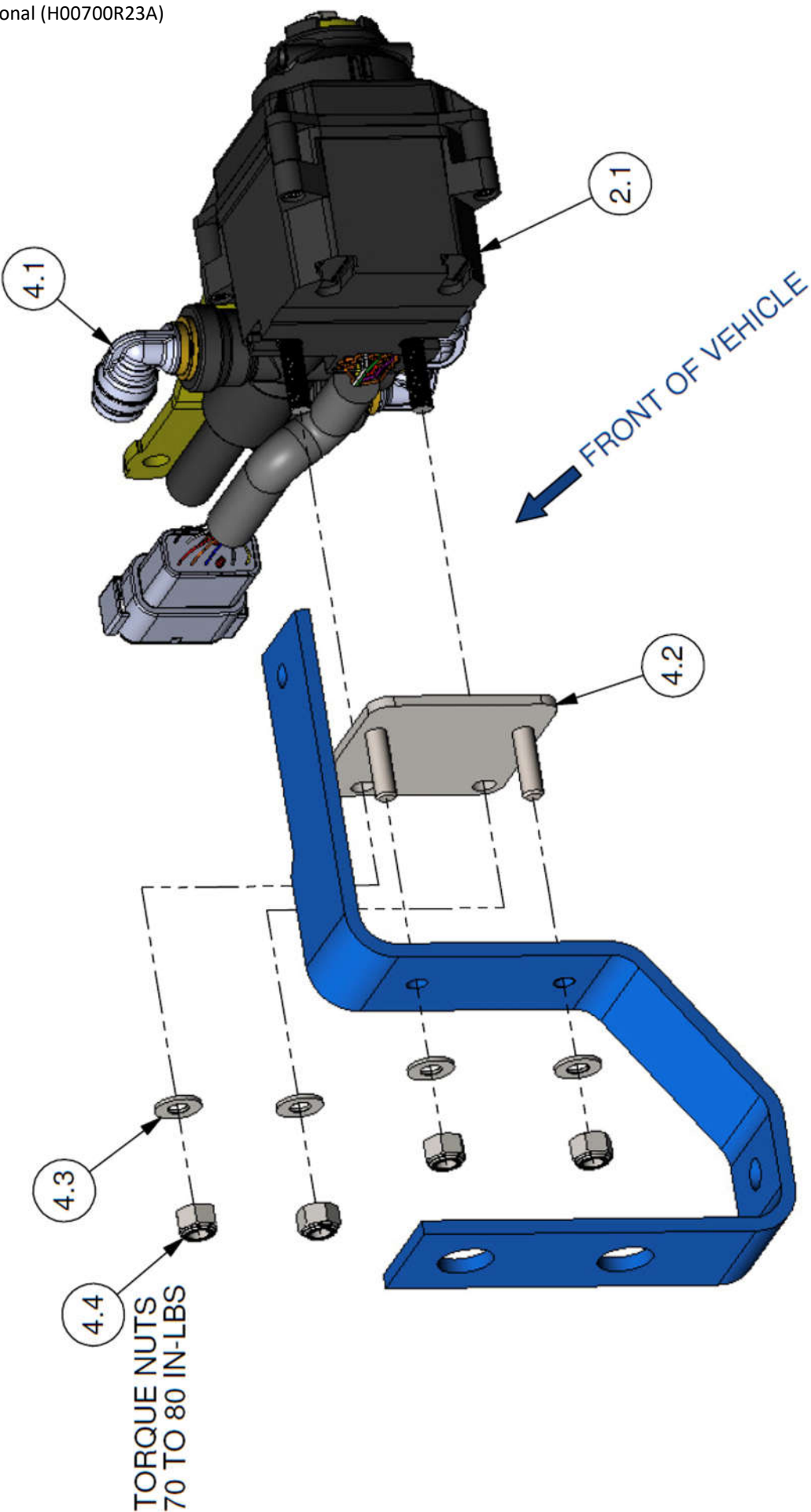

### 13. PETERBILT 386/388 (H00700R24A) - OPTION 1 & 2 MATERIALS SUPPLIED

H00700R24A (2410 SERIES, EHCV KIT SMARTVALVE & DUMP VALVE)			
ITEM	QTY	LINK PART #	DESCRIPTION
1.1	1	H02410RJ-1	2410 SERIES, SMARTVALVE
1.2	1	H18130SVM1	INTERFACE MODULE
1.3	1	H00700SD	DUMP VALVE
1.4	1	HPB700-28	ELECTRICAL KIT
1.5	1	HPB700-58	HARDWARE & PLUMBING KIT
1.6	1	H18007	HARNESS, CONTROL
1.7	1	HPB700-52	INSTALLATION INSTRUCTIONS/DECAL KIT
1.8	1	H18016S	CAN Y HARNESS

H02410RJ-1 (2400 SERIES, EHCV VALVE)			
ITEM	QTY	LINK PART #	DESCRIPTION
2.1	1	H02410RJ-1A	LEVER POS. A. / STUD POS. B, C
2.2	1	H16060-08	SOFTWARE (CURRENT REVISION)

HPB700-28 (ELECTRICAL KIT)			
ITEM	QTY	LINK PART #	DESCRIPTION
3.1	1	H17628	PANEL INDICATOR (DUAL LED)
3.2	2	H17629	SWITCH, MOMENTARY PUSHBUTTON
3.3	8	H17641	BUTT CONNECTOR, 22-18 GA, CLEAR
3.4	4	M15724	BUTT CONNECTOR, 16-14 GA, BLUE
3.5	2	H18776	FUSE TAP, 10 AMP
3.6	2	H18783	MINI FUSE, 10 AMP
3.7	1	H17082	DECAL DETAIL
3.8	16	H18195	PIN, MALE
3.9	1	H14610	RING TERMINAL
3.10	2	H18210	LOCKING PUSH MOUNT TIE
3.11	1	H18211	WIRE BUNDLE

HPB700-58 (HARDWARE & PLUMBING KIT)			
ITEM	QTY	LINK PART #	DESCRIPTION
4.1	3	H17119	STEM, ELBOW - 1/4"
4.2	1	H17055	SMARTVALVE MOUNTING SPACER
4.3	2	H13404	1/4" FLAT WASHER
4.4	2	H13964	1/4-20 LOCKNUT
4.5	1	H17055-1	MOUNTING PLATE/STUD ASSEMBLY
4.6	1	H16393	STEM ELBOW 3/8"

Figure 11. Peterbilt (H00700R24A) Option 1

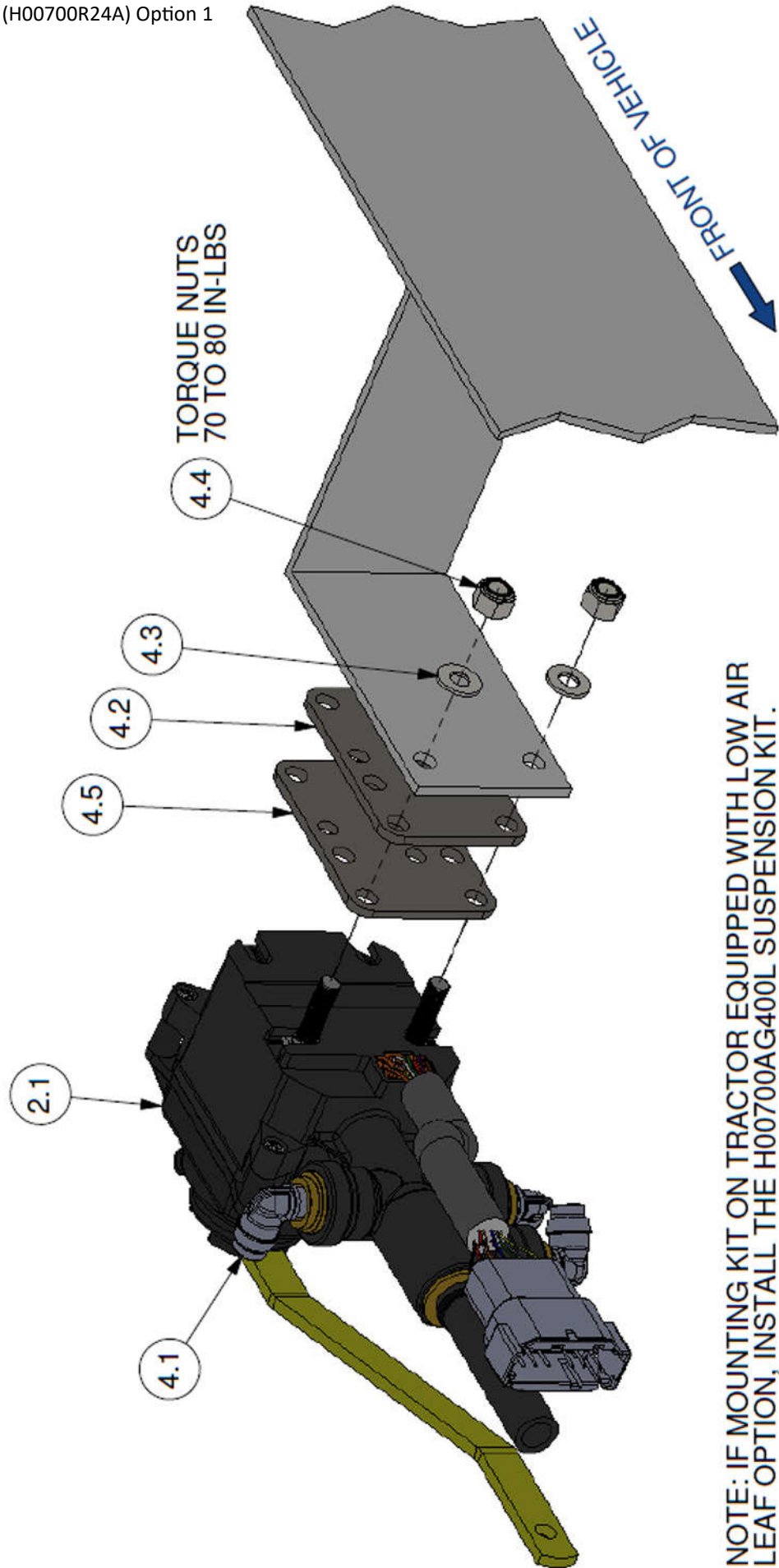
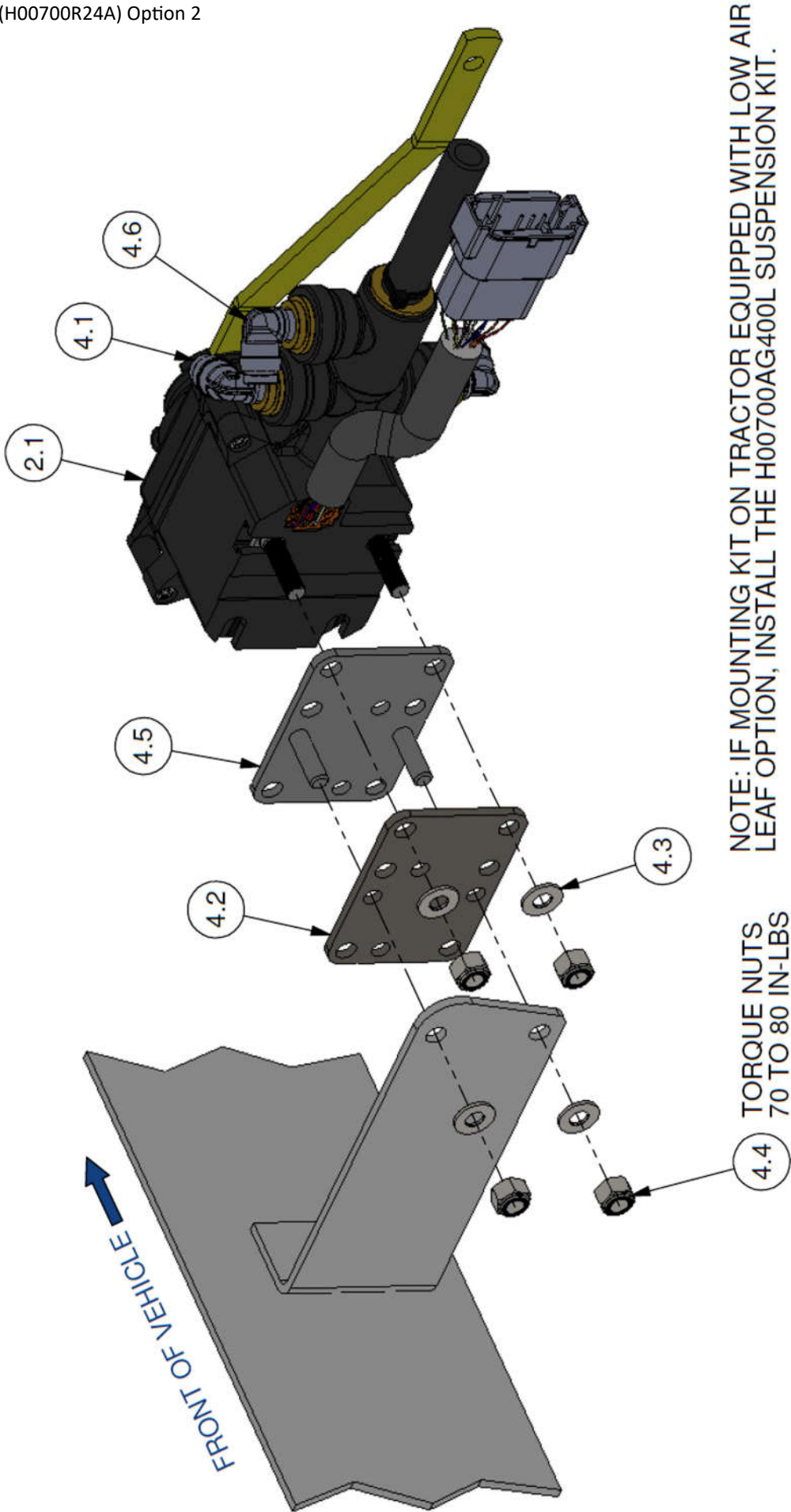

Figure 12. Peterbilt (H00700R24A) Option 2



## 14.VOLVO (H00700R25A) MATERIALS SUPPLIED

<b>H00700R25A (2410 SERIES, EHCV KIT SMARTVALVE &amp; DUMP VALVE)</b>			
ITEM	QTY	LINK PART #	DESCRIPTION
1.1	1	H02410RK-1	2410 SERIES, EHCV VALVE
1.2	1	H18130SVM1	INTERFACE MODULE
1.3	1	HPB700-28	ELECTRICAL KIT
1.4	1	HPB700-59	HARDWARE & PLUMBING KIT
1.5	1	H18007	HARNESS, CONTROL
1.6	1	HPB700-52	INSTALLATION INSTRUCTIONS/DECAL KIT
1.7	1	H18086S	CAN Y HARNESS

<b>H02410RK-1 (2400 SERIES, EHCV VALVE)</b>			
ITEM	QTY	LINK PART #	DESCRIPTION
2.1	1	H02410RK-1A	LEVER POS. A. / STUD POS. A, B, C, D
2.2	1	H16060-08	SOFTWARE (CURRENT REVISION)

<b>HPB700-28 (ELECTRICAL KIT)</b>			
ITEM	QTY	LINK PART #	DESCRIPTION
3.1	1	H17628	PANEL INDICATOR (DUAL LED)
3.2	2	H17629	SWITCH, MOMENTARY PUSHBUTTON
3.3	8	H17641	BUTT CONNECTOR, 22-18 GA, CLEAR
3.4	4	M15724	BUTT CONNECTOR, 16-14 GA, BLUE
3.5	2	H18776	FUSE TAP, 10 AMP
3.6	2	H18783	MINI FUSE, 10 AMP
3.7	1	H17082	DECAL DETAIL
3.8	16	H18195	PIN, MALE
3.9	1	H14610	RING TERMINAL
3.10	2	H18210	LOCKING PUSH MOUNT TIE
3.11	1	H18211	WIRE BUNDLE

<b>HPB700-59 (HARDWARE &amp; PLUMBING KIT)</b>			
ITEM	QTY	LINK PART #	DESCRIPTION
4.1	3	H16393	STEM ELBOW 3/8"
4.2	1	H17055	SMARTVALVE MOUNTING SPACER
4.3	4	H13404	WASHER 1/4" X 1/2"
4.4	4	H13964	LOCK NUT, 1/4-20
4.5	2	H17076	UNION Y, 3/8 TUBE
4.6	2	H15583	UNION, 3/8 TO 3/8
4.7	1	H15526-4	18" OF 3/8" TUBING

Figure 13. Volvo (H00700R25A)

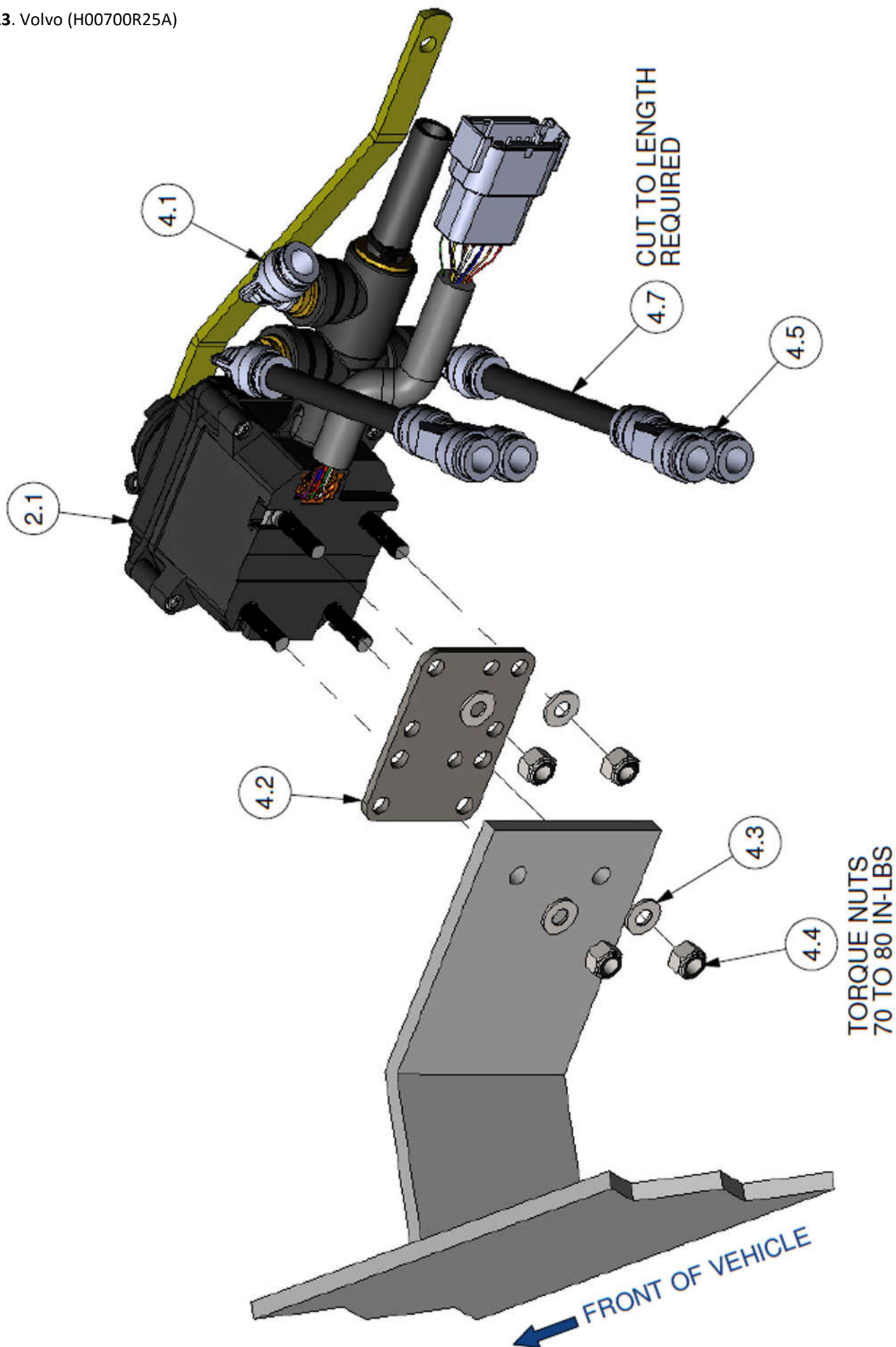



## 15.MACK (H00700R26A) MATERIALS SUPPLIED

H00700R46A (2410 SERIES, EHCV KIT SMARTVALVE & DUMP VALVE)			
ITEM	QTY	LINK PART #	DESCRIPTION
1.1	1	H02410RK-1	2410 SERIES, SMARTVALVE
1.2	1	H18130SVM1	SMARTVALVE INTERFACE MODULE
1.3	1	HPB700-28	ELECTRICAL KIT
1.4	1	HPB700-60	HARDWARE & PLUMBING KIT
1.5	1	H18007	HARNESS, CONTROL
1.6	1	HPB700-52	INSTALLATION INSTRUCTIONS/DECAL KIT
1.7	1	H18086S	CAN Y HARNESS
1.8	1	H18254S	CAN Y HARNESS

H02410RK-1 (2400 SERIES, EHCV VALVE)			
ITEM	QTY	LINK PART #	DESCRIPTION
2.1	1	H02410RK-1A	LEVER POS. A. / STUD POS. A, B, C, D
2.2	1	H16060-08	SOFTWARE (CURRENT REVISION)

HPB700-28 (ELECTRICAL KIT)			
ITEM	QTY	LINK PART #	DESCRIPTION
3.1	1	H17628	PANEL INDICATOR (DUAL LED)
3.2	2	H17629	SWITCH, MOMENTARY PUSHBUTTON
3.3	8	H17641	BUTT CONNECTOR, 22-18 GA, CLEAR
3.4	4	M15724	BUTT CONNECTOR, 16-14 GA, BLUE
3.5	2	H18776	FUSE TAP, 10 AMP
3.6	2	H18783	MINI FUSE, 10 AMP
3.7	1	H17082	DECAL DETAIL
3.8	16	H18195	PIN, MALE
3.9	1	H14610	RING TERMINAL
3.10	2	H18210	LOCKING PUSH MOUNT TIE
3.11	1	H18211	WIRE BUNDLE

HPB700-60 (HARDWARE & PLUMBING KIT)			
ITEM	QTY	LINK PART #	DESCRIPTION
4.1	3	H16393	STEM ELBOW 3/8"
4.2	4	H17055	SMARTVALVE MOUNTING SPACER
4.3	4	H13404	WASHER 1/4" X 1/2"
4.4	1	H13964	LOCK NUT, 1/4-20

Figure 14. Mack (H00700R26A)

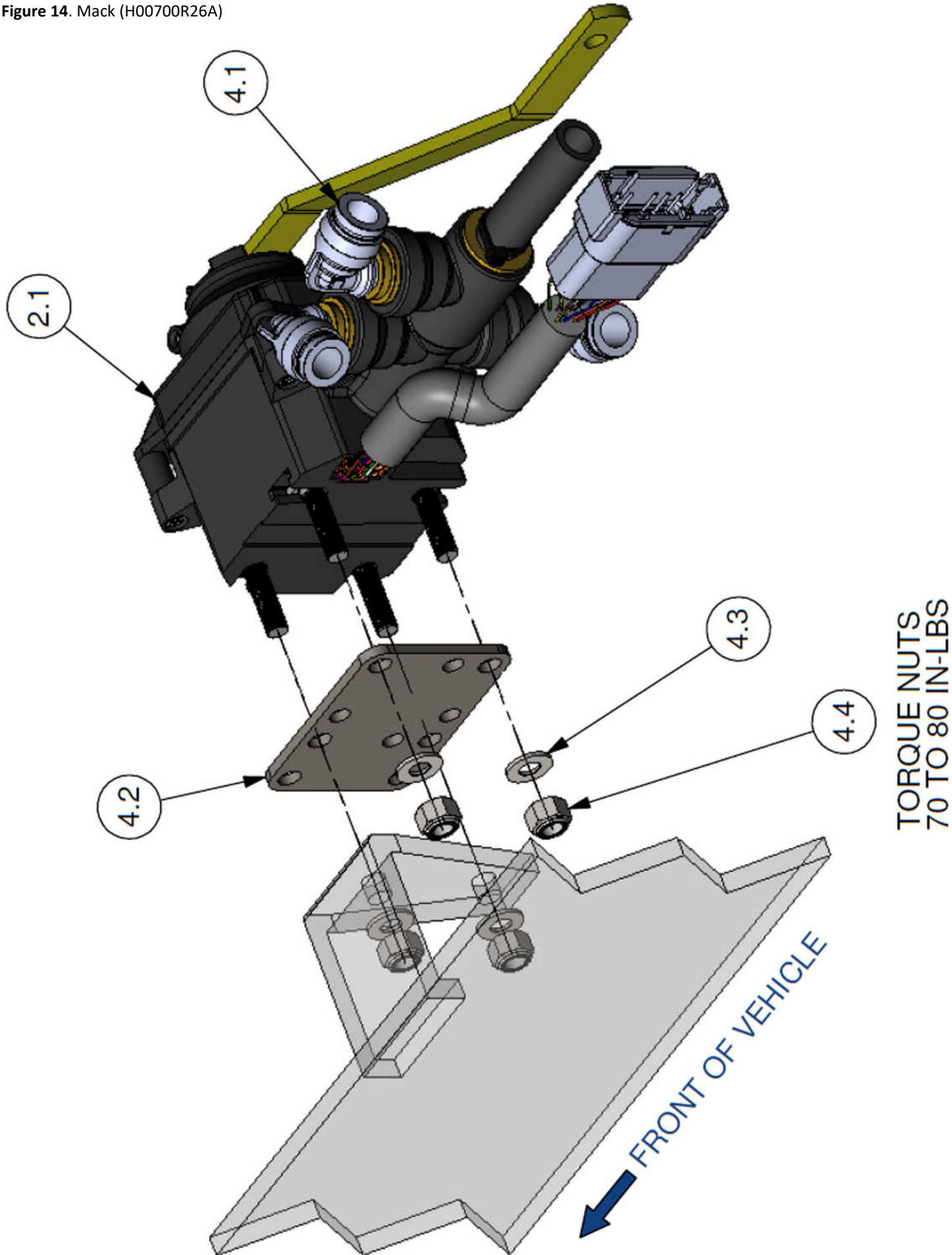

## 16.HINO (H00700R28A) MATERIALS SUPPLIED

<b>H00700R28A (2410 SERIES, EHCV KIT SMARTVALVE)</b>			
ITEM	QTY	LINK PART #	DESCRIPTION
1.1	1	H02410RU-1	2410 SERIES, EHCV VALVE
1.2	1	H18130SVM1	SMARTVALVE INTERFACE MODULE
1.3	1	HPB700-28	ELECTRICAL KIT
1.4	1	HPB700-55	HARDWARE & PLUMBING KIT
1.5	1	H18007	HARNESS, CONTROL
1.6	1	HPB700-52	INSTALLATION INSTRUCTIONS / DECAL KIT
1.7	1	H18869	CAN Y HARNESS

<b>H02410RU-1 (2400 SERIES, EHCV VALVE)</b>			
ITEM	QTY	LINK PART #	DESCRIPTION
2.1	1	H02410RU-1A	LEVER POS. A. / STUD POS. B, C
2.2	1	H16060-08	SOFTWARE (CURRENT REVISION)

<b>HPB700-28 (ELECTRICAL KIT)</b>			
ITEM	QTY	LINK PART #	DESCRIPTION
3.1	1	H17628	PANEL INDICATOR (DUAL LED)
3.2	2	H17629	SWITCH, MOMENTARY PUSHBUTTON
3.3	8	H17641	BUTT CONNECTOR, 22-18 GA, CLEAR
3.4	4	M15724	BUTT CONNECTOR, 16-14 GA, BLUE
3.5	2	H18776	FUSE TAP, 10 AMP
3.6	2	H18783	MINI FUSE, 10 AMP
3.7	1	H17082	DECAL DETAIL
3.8	16	H18195	PIN, MALE
3.9	1	H14610	RING TERMINAL
3.10	2	H18210	LOCKING PUSH MOUNT TIE
3.11	1	H18211	WIRE BUNDLE

<b>HPB700-55 (HARDWARE &amp; PLUMBING KIT)</b>			
ITEM	QTY	LINK PART #	DESCRIPTION
4.1	3	H16393	STEM, ELBOW 3/8"
4.2	2	H17055	SMARTVALVE MOUNTING SPACER
4.3	2	H13404	WASHER, ¼ X ½"
4.4	2	H13964	1/4-20 LOCKNUT

Figure 15. Hino (H00700R28A)

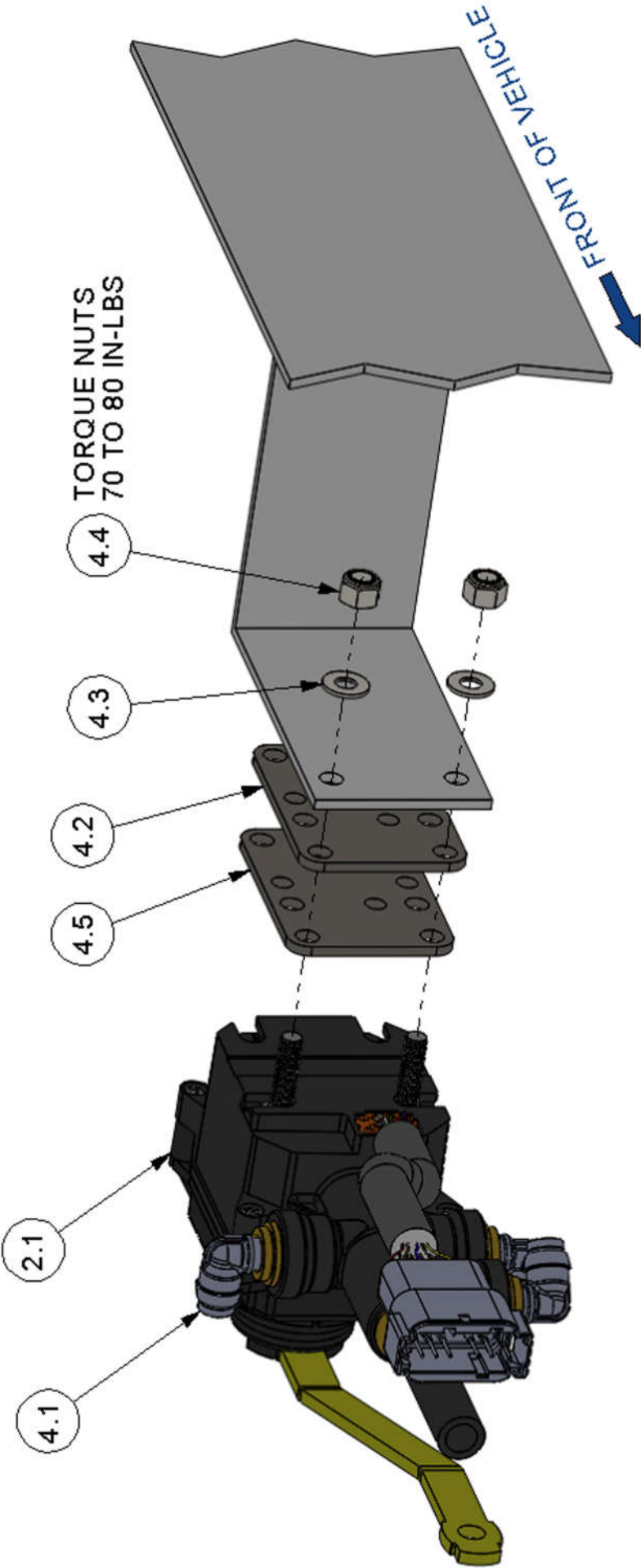

## 17.INSTALLATION TROUBLESHOOTING GUIDE

SmartValve		
Symptom	Cause	Solution
<b>H00700PK data link(no response from SmartValve)</b>	SmartValve "Ride Setup" tool is not running on computer	Start Smart Valve tool
	Vehicle ignition is not switched "on"	Switch ignition to "ON"
	Interface cable not plugged into SmartValve harness	Plug the three pin connector into SmartValve harness. Refer to H00700PK manual
	Interface cable not plugged into computer	Plug USB connector into the computer. Refer to H00700PK manual
	Damaged interface cable (check wires)	Check wire connections or check USB interface cable function on another vehicle if available
	See <b>"Power Issues"</b> section at the end of this guide	
<b>SmartValve will not raise vehicle to "Ride Height" on startup</b>	Vehicle ignition is not switched "on"	Switch ignition to "ON"
	Suspension reservoir air pressure below 90 PSI	Start engine to raise air pressure to greater than 90 PSI
	Vehicle dump switch in "Dump position"	Switch to "OFF" position
	SmartValve clocking is set to wrong direction (clockwise or counterclockwise)	Use H00700PK "Ride Setup" tool to reverse the direction. Refer to H0700PK manual
	See "Power Issues" section at the end of this guide	

SmartValve		
Symptom	Cause	Solution
<b>SmartValve will not raise vehicle to "override height position"</b>	Vehicle ignition is not switched "on"	Switch ignition to "ON"
	J1939 CAN bus wires not connected	Connect CAN bus to the vehicle. Refer to the SmartValve manual for proper connection.
	J1939 CAN bus wires reversed	Refer to the SmartValve manual for proper connection.
	J1939 CAN speed signal not available	Refer to the SmartValve manual for proper connection.
	Suspension reservoir air pressure below 90 PSI	Start engine to raise air pressure to greater than 90 PSI
	Incorrect "raised angle" incorrectly set in SmartValve setup tool	Use H00700PK "Ride Setup" tool to set the raised height. Refer to H00700PK manual
	If vehicle is moving, speed exceeds 10 mph	Reduce speed to below 5 MPH
	See "Power Issues" section at the end of this guide	

SmartValve		
Symptom	Cause	Solution
<b>SmartValve will not lower vehicle to "Dumped position"</b>	Vehicle ignition is not switched "on"	Switch ignition to "ON"
	Suspension reservoir air pressure below 90 PSI	Start engine to raise air pressure to greater than 90 PSI
	Vehicle dump switch not in "Dump position"	Switch to "DUMP" position
	See "Power Issues" section at the end of this guide	
<b>SmartValve constantly exhausts air</b>	SmartValve air lines plumbed incorrectly	Verify all plumbing connections (refer to SmartValve manual for plumbing information)
<b>Vehicle raises to maximum suspension height and stays at this level</b>	SmartValve air lines plumbed incorrectly	Verify all plumbing connections (refer to SmartValve manual for plumbing information)
<b>Vehicle continually raises and lowers the suspension while near the ride height setting</b>	One or more of the air lines or fittings are leaking air.	Verify that all plumbing connections are airtight. Spray a soap and water solution on the suspension fittings and air lines to detect leakage. Tighten or repair as necessary.
<b>Communication failed:</b>	Verify comport is a USB com port	Open file tab, release com port, open drop down menu or refresh, select com port ending in USB, open com port

SmartValve		
Symptom	Cause	Solution
<b>Power Issues</b>		
	Battery voltage low or not present	Voltage reading on battery wire should be greater than 10 VDC
	Ignition voltage low or not present	Voltage reading on the ignition wire should be greater than 10 VDC continuous when the ignition is switched "on"
	Battery fuse not installed or "open"	Check fuse assembly, replace if necessary
	Ignition fuse not installed or "open"	Check fuse assembly, replace if necessary
	Connectors not attached	Check all harness connectors for proper attachment
	Connectors not fully inserted	Check all harness connectors for proper engagement. The connectors should lock together when properly installed.
	Improper grounding	Resistance must be less than 2 ohms from SmartValve ground wire to the negative battery terminal
	Intermittent battery or ignition voltage	Power may be connected to a "timed out" power source on vehicle panel (timeout intervals can be several minutes)



## 18. SMARTVALVE LED OPERATION

### DESCRIPTION – RETROFIT VALVES/ FAULT CODES

The SMARTVALVE STATUS indicator contains both red and green LEDs.

The red LED flashes quickly if power or communication is lost to the valve.

The green LED indicates the mode and faults detected during operation. A repeating pattern indicates a system mode or condition. A series of blinks arranged in pairs of groups are used to indicate system faults. This section summarizes these codes.

See Table 9 for full code summary.

If the red flashing LED or fault codes are present, DO NOT DRIVE until verifying suspension is in a safe state to allow safe travel.

### 18.1

#### Green LED—Mode Indication

A uniformly repeating pattern indicates the current mode of operation.

#### Steady On –SmartValve Initialization, Tag Dump, or Fault

A steady on light indicates the tag axle is dumped. A steady on light also occurs for a short time after initial ECU power is applied. A steady light which does not turn off for even a few seconds after initialization may occur if the processor is not running or a short to ground is present in the LED wiring.

#### Short Blinks – Raise Mode

Steady ¼ second blink every two seconds show the valve is in Raised mode.

#### Long Blinks - Dump Mode

A steady blinking of one second on and one second off shows the valve is in Dump mode.

### 18.2

#### Green LED—Fault Codes

The system identifies several fault conditions using two groups of 1-4 blinks for each condition detected. For example, one blink followed by two blinks indicates fault code 12. All active fault conditions are repeatedly shown one after another. As described below, most faults cause changes in the system operation. All fault codes are initialized to clear during system power up.

## 19. SMARTVALVE OPERATING INSTRUCTIONS

Two momentary pushbutton switches and a LED have been added to the dash to select the valve's operating mode.

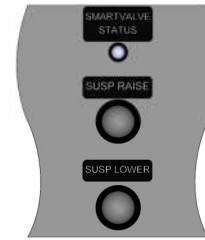

Figure 16.  
Pushbutton Switch

### 19.1

#### Lowering Rear Suspension

- To dump the rear suspension: Press the “SUSP LOWER” pushbutton once.
- To return to standard ride height: Press either pushbutton.
- If the “Auto Return to Ride Height” feature is enabled (default) there are speed restrictions on the dump mode:
  - The vehicle must be moving less than 10 MPH to enter the dump mode.
  - If dumped, the vehicle will return to normal ride height when the speed exceeds 17 MPH for 5 seconds.

### 19.2

#### Raising Rear Suspension

The “SUSP RAISE” switch will raise the rear suspension approximately 2 inches to allow for increased ground clearance during drop and hook operation.

- To raise the vehicle from standard height: Press the “SUSP RAISE” pushbutton.
- To return to standard ride height: Press either pushbutton.
- There are speed restrictions on the raised mode:
  - The speed of the vehicle must be less than 10 MPH to allow switching to the raised mode.
  - If raised, the vehicle will return to standard ride height automatically if the speed is greater than 10 MPH for 5 seconds.

### 19.3

#### Additional Notes

- If the ignition is turned “off” and the truck is left in the raised or lowered mode, the vehicle will remain in that mode until either button is pressed with the ignition on.
- The switches need to be pressed and held for at least a half second to change the mode.

Green LED operation Summary		
Symptom	Description 1	Description 2
<b>Mode Indicators</b>		
Steady On	Initial power on.	Lights during initial power up for approximately 5 seconds.
	Tag axle dumped	Not used.
	Program error	Indicates an error if neither condition above applies.
	Ignition fuse not installed or "open"	Check fuse assembly, replace if necessary
¼ sec. per 2 secs.	Raise mode	Vehicle raised above ride height
1 sec. on - 1 sec. off	Dump mode	Vehicle is lowering or sitting at lower suspension limit.
<b>Fault Codes</b>		
11: 1 blink, 1 blink	Angle sensor error	Internal valve fault or a lever installed 180 degrees out of position
12: 1 blink, 2 blinks	Angle out of range	The lever is more than 65 degrees from center. May be a linkage failure.
13: 1 blink, 3 blinks	Pressure Sensor Fault	The pressure sensor used to sense the dump signal is disconnected, open, or shorted.
14: 1 blink, 4 blinks	5 VDC fault	Indicates internal valve problem.
21: 2 blinks, 1 blink	CAN data missing	No CAN bus signals are being received. Raise feature is disabled.
22: 2 blinks, 2 blinks	Low Supply	Supply voltage is too low to reliably operate valve. Poor ground connection(s).
23: 2 blinks, 3 blinks	Ign/raise signal	Voltage out of range.
24: 2 blinks, 4 blinks	Extreme Board Temperature	Indicates extreme temperature
31: 3 blinks, 1 blink	Motor Feedback Fault	Internal valve fault
32: 3 blinks, 2 blinks	Motor driver fault	Internal valve fault
33: 3 blinks, 3 blinks	Motor not reaching target	Internal valve fault
34: 3 blinks, 4 blinks	Motor Centering out of range	Internal valve fault
41: 4 blinks, 1 blink	Suspension too high	Indicates the suspension is higher than expected. Valve is not able to correct.
42: 4 blinks, 2 blinks	Suspension not raising	Suspension is not rising due to air pressure, leakage, or other issues.
43: 4 blinks, 3 blinks	Unable to close valve	Internal valve fault
44: 4 blinks, 4 blinks	Valve not responding	Internal valve fault