

**Suspension  
Controls**

**LINK<sup>®</sup>**

Link Mfg. Ltd.  
223 15th St. N.E.  
Sioux Center, IA USA  
51250-2120  
[www.linkmfg.com](http://www.linkmfg.com)

**QUESTIONS?  
CALL CUSTOMER  
SERVICE  
1-800-222-6283**

# INSTALLATION INSTRUCTIONS

## ADJUSTABLE LINKAGE (H15428)

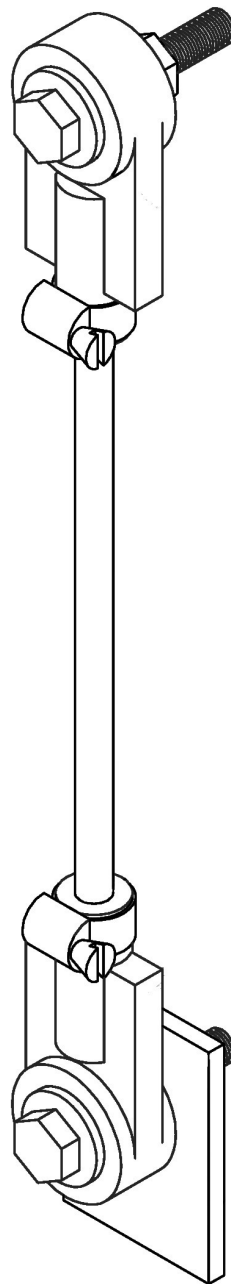

**IMPORTANT:** IT IS IMPORTANT THAT THE ENTIRE INSTALLATION INSTRUCTIONS BE READ THOROUGHLY BEFORE PROCEEDING WITH THE INSTALLATION.





## 1. INTRODUCTION

Thank you for choosing a Link Suspension Control. We want to help you get the best results from this height control valve and to operate it safely. This instruction contains information to assist in the installation of the Height Control Valve. This instruction is intended solely for use with this product.

All information in this instruction is based on the latest information available at the time of printing. Link Manufacturing reserves the right to change its products or manuals at any time without notice.

Damaged components should be returned to Link with a pre-arranged Returned Materials Authorization (RMA) number through the Customer Service Department. The damaged component may then be replaced if in compliance with warranty conditions.

## 2. SAFETY SYMBOLS, TORQUE SYMBOL, and NOTES

	<b>DANGER</b> indicates a hazardous situation which if not avoided, will result in death or serious injury.
	<b>WARNING</b> indicates a potentially hazardous situation which, if not avoided, could result in death or serious injury.
	<b>CAUTION</b> indicates a potentially hazardous situation which, if not avoided, could result in minor or moderate injury.
	<b>NOTICE</b> indicates a potentially hazardous situation which, if not avoided, may result in property damage.
	<b>TORQUE</b> indicates named fasteners are to be tightened to a specified torque value.
<b>NOTE:</b>	A Note provides information or suggestions that help you correctly perform a task.

## 3. SAFE WORKING PRACTICES

### CAUTION

When handling parts, wear appropriate gloves, eye-glasses, ear protection, and other safety equipment.

### CAUTION

Proper tightening of fasteners is important to the performance and safety of the suspension. Follow all torque specifications throughout the instructions.

## 4. SAFE WORKING PRACTICES

### CAUTION

#### 4.1

Air lines are pressurized and may blow debris, USE EYE PROTECTION.

## 5. ROD CUTTING INSTRUCTIONS

#### 5.1

Determine length of linkage by setting chassis at correct ride height. Then measure the distance from center of pinned valve lever to center of linkage mount hole.

Center to center length = X"

#### 5.2

Determine length to be cut off rod by the following calculation:

Rod cut off amount = 20 – X"

#### 5.3

Example:

If center to center length is 16.5" the 3.5" would be cut off end of rod.  
(20-16.5"=3.5")

## 6. ASSEMBLY INSTRUCTIONS

#### 6.1

Linkage must be assembled using the parts supplied, any substitutions will void warranty.

#### 6.2

Remove all burrs and sharp edges from the ends of the rod.

#### 6.3

Slide a rubber rod end onto one side of the rod making sure the rod is pushed in all the way.

#### 6.4

Slide two loose hose clamps onto the other end of the rod.

### 6.5

Slide the other rubber rod end onto the rod keeping in mind the direction of the mounting holes on the rubber rod ends. Make sure rod is pushed in all the way.

### 6.6

Recheck center to center distance "X" as measured in step "a".

### 6.7

Place the hose clamps on the rubber rod ends (as shown) and torque the hose clamps to 15 in.-lb. After the linkage is installed, check for any valve lever or linkage interference through the entire suspension travel.

## 7. PARTS INCLUDED

Figure 1.

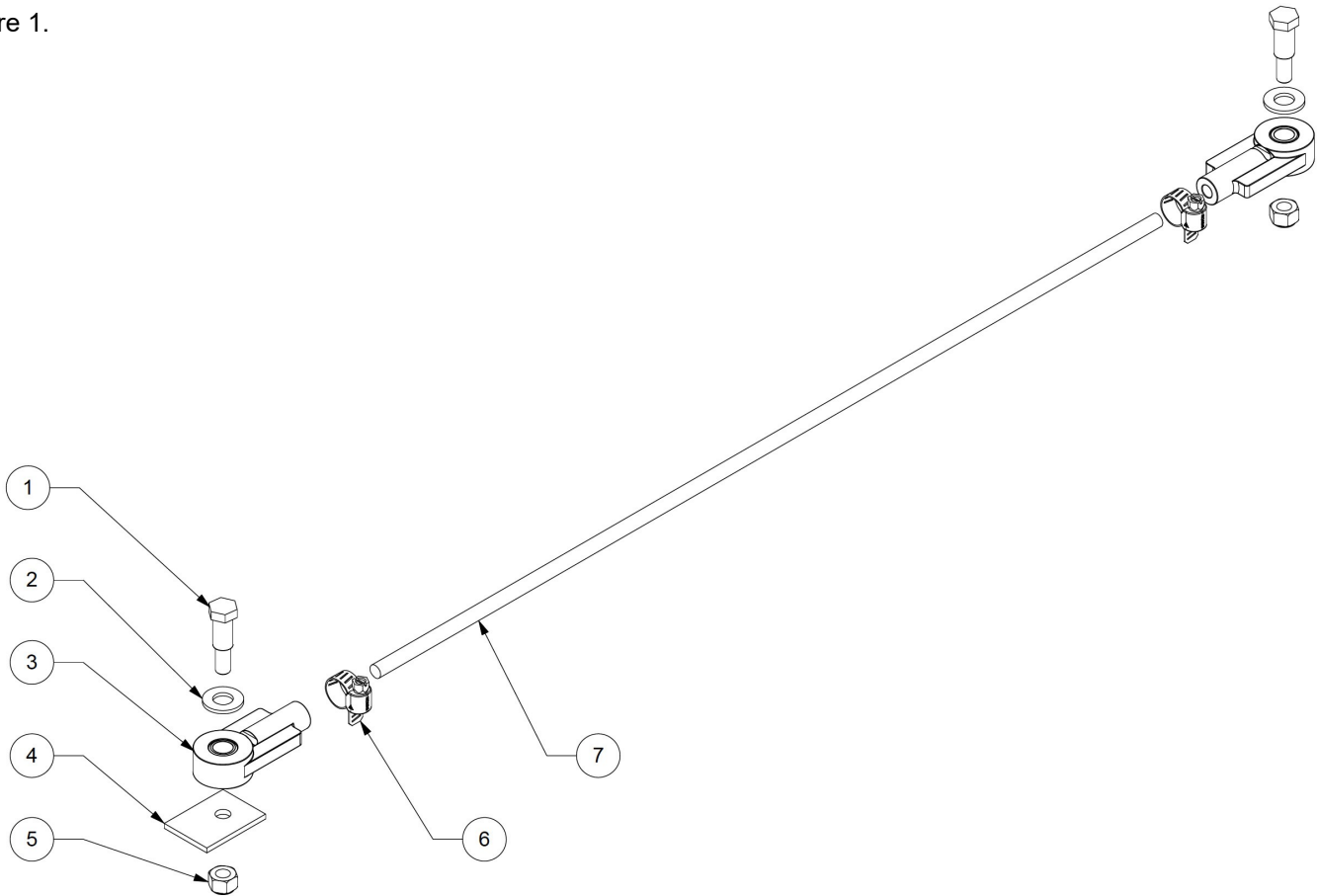

Item No.	Part Number	Description	Qty.
1	H14406	Link Screw (.34 x 1 5/32 long 1/4-20 Shoulder Bolts)	2
2	H14407	Washer (5/16" Flat Washer)	2
3	H14408	Rubber Rod Ends	2
4	H14423	Axle Bracket	1
5	H13964	Lock Nut (1/4-20)	2
6	H14418	#8 Hose Clamp	2
7	H14413-33	Rod (.25 Rod - 18 3/8 long)	1
8	H14421	Plastic Bag (not shown)	1

