

AIR CONTROL KITS

Integrated Air Kit - 800A0174 & 800A0175 - Current

Fits Part Number - 8A000723

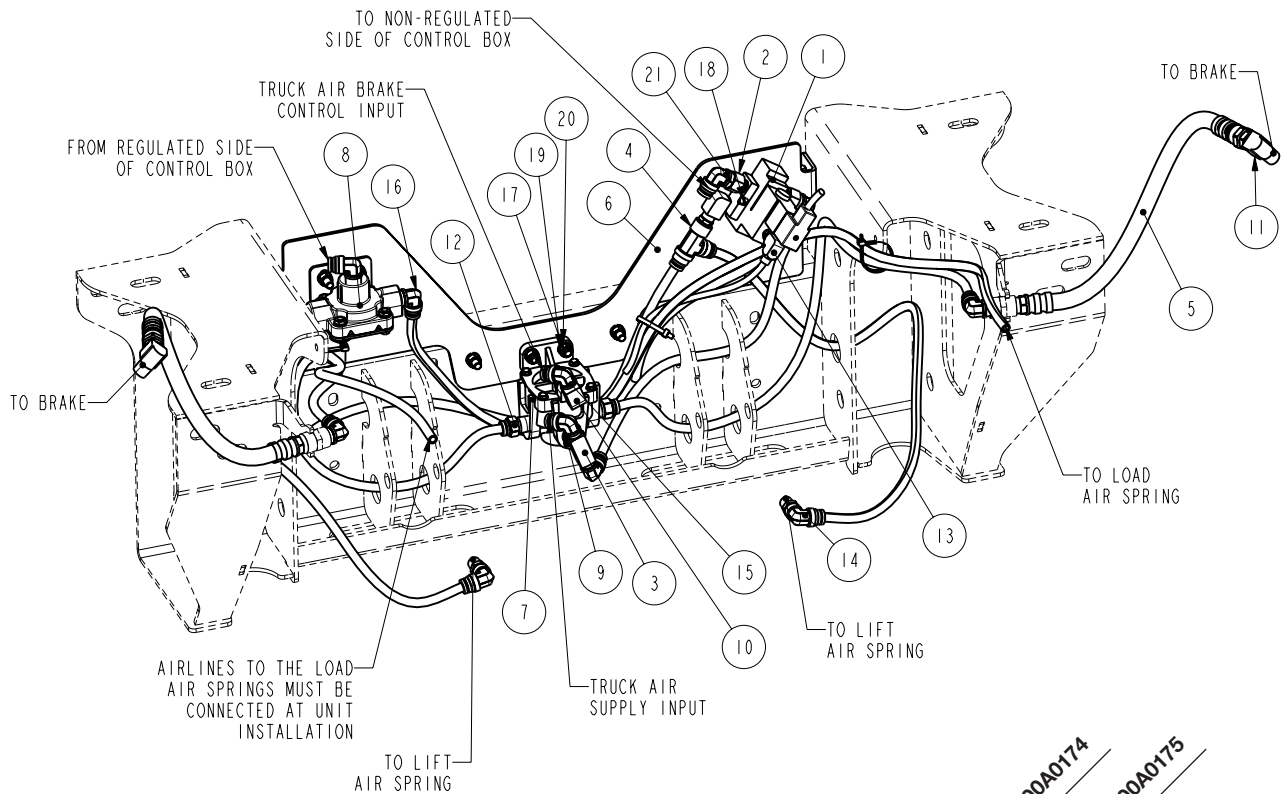

ITEM	PART NO	PART DESCRIPTION	QTY	QTY
1	13010555	VALVE-SOLENOID, 4 WAY, 12 V.....	1.....	1
2	13022127	ADAPTER-3/8 FEMALE X 1/4 MALE, BRASS.....	2.....	2
3	13022128	TEE-1/4", BRASS.....	1.....	1
4	13025132	TEE-RUN, 1/4 M-NPT, 3/8 TUBE.....	1.....	1
5	13029972	ASSEMBLY-AIR BRAKE HOSE (26 IN.).....	2.....	2
6	80002292	PLATE-INTEGRATED AIR MOUNT.....	1.....	1
7	13010508	RELAY VALVE, RG-2, MIDLAND.....	1.....	1
8	13010546	VALVE-QUICK RELEASE.....	1.....	1
9	13022018	BUSHING-REDUCER, 1/2 M-NPT - 1/4 F-NPT.....	1.....	1
10	13022099	ELBOW, 90 STREET (1/4-NPT).....	2.....	2
11	13022102	ELBOW, 90 STREET (3/8-NPT).....	2.....	2
12	13025050	CONNECTOR-MALE, 3/8 TB, 3/8 NPT.....	2.....	2
13	13025090	ELBOW, 1/4 TB 1/8 M-NPT, PUSH-IN DOT.....	1.....	1
14	13025094	ELBOW-SWIV, 3/8 TB, 1/4 M-NPT.....	2.....	2
15	13025104	ELBOW-3/8 TB, 1/4 M-NPT.....	4.....	4
16	13025105	ELBOW-3/8 TB, 3/8 M-NPT.....	7.....	7
17	140B1008	5/16 X 1 UNC HEX CAP SCR (GR 8) O&P.....	8.....	8
18	144N0B16	10-32 X 2 ROUND HEAD MACH. SCREW.....	2.....	2
19	14701004	5/16 UNC HEX NUT (GR B) O&P.....	8.....	8
20	14851004	5/16 LOCK WASHER OIL&PHOS.....	8.....	8
21	15060042	10-32 KEP NUT.....	2.....	2
22	800A0303	KIT-INSTALL, DLII INTEGRATED AIR, STANDARD - LOOSE PARTS KIT (SEE PG 41).....	1.....	-
23	800A0304	KIT-INSTALL, DLII INTEGRATED AIR, SEALED - LOOSE PARTS KIT (SEE PG 41).....	-	1

