



Link Mfg. Ltd.  
223 15th St. N.E.  
Sioux Center, IA USA  
51250-2120  
[www.linkmfg.com](http://www.linkmfg.com)

**QUESTIONS?  
CALL CUSTOMER  
SERVICE  
1-800-222-6283**

# INSTALLATION INSTRUCTIONS

## **4AS00117 8K & 10K WHEEL BEARING AND SEAL ASSEMBLY**

**FOR USE ON SUSPENSIONS BUILT BEFORE 6/7/21**

**FOR SUSPENSIONS BUILT AFTER 6/7/21, USE SERVICE KIT  
4AS00028**



**IMPORTANT:** IT IS IMPORTANT THAT THE ENTIRE INSTALLATION INSTRUCTIONS BE READ THOROUGHLY BEFORE PROCEEDING WITH THE INSTALLATION.

## 1. INTRODUCTION





Thank you for choosing a Link Auxiliary Suspension. We want to help you get the best results from this suspension and to operate it safely. This instruction contains information to assist in the installation of the wheel bearings and seal for your Link Auxiliary Suspension. This instruction is intended solely for use with this product.

All information in this instruction is based on the latest information available at the time of printing. Link Manufacturing reserves the right to change its products or manuals at any time without notice.

Damaged components should be returned to Link with a pre-arranged Returned Materials Authorization (RMA) number through the Customer Service Department. The damaged component may then be replaced if in compliance with warranty conditions.

## 2. SAFETY SYMBOLS, TORQUE SYMBOL, and NOTES

### 3. SAFE WORKING PRACTICES

 <b>DANGER</b>	<b>DANGER</b> indicates a hazardous situation which if not avoided, will result in death or serious injury.
 <b>WARNING</b>	<b>WARNING</b> indicates a potentially hazardous situation which, if not avoided, could result in death or serious injury.
 <b>CAUTION</b>	<b>CAUTION</b> indicates a potentially hazardous situation which, if not avoided, could result in minor or moderate injury.
 <b>NOTICE</b>	<b>NOTICE</b> indicates a potentially hazardous situation which, if not avoided, may result in property damage.
 <b>TORQUE</b>	<b>TORQUE</b> indicates named fasteners are to be tightened to a specified torque value.
<b>NOTE:</b>	A Note provides information or suggestions that help you correctly perform a task.

 **CAUTION** When handling parts, wear appropriate gloves, eyeglasses, ear protection, and other safety equipment.

 **CAUTION** Proper tightening of fasteners is important to the performance and safety of the suspension. Follow all torque specifications throughout the instructions.

## 4. INSTALLATION

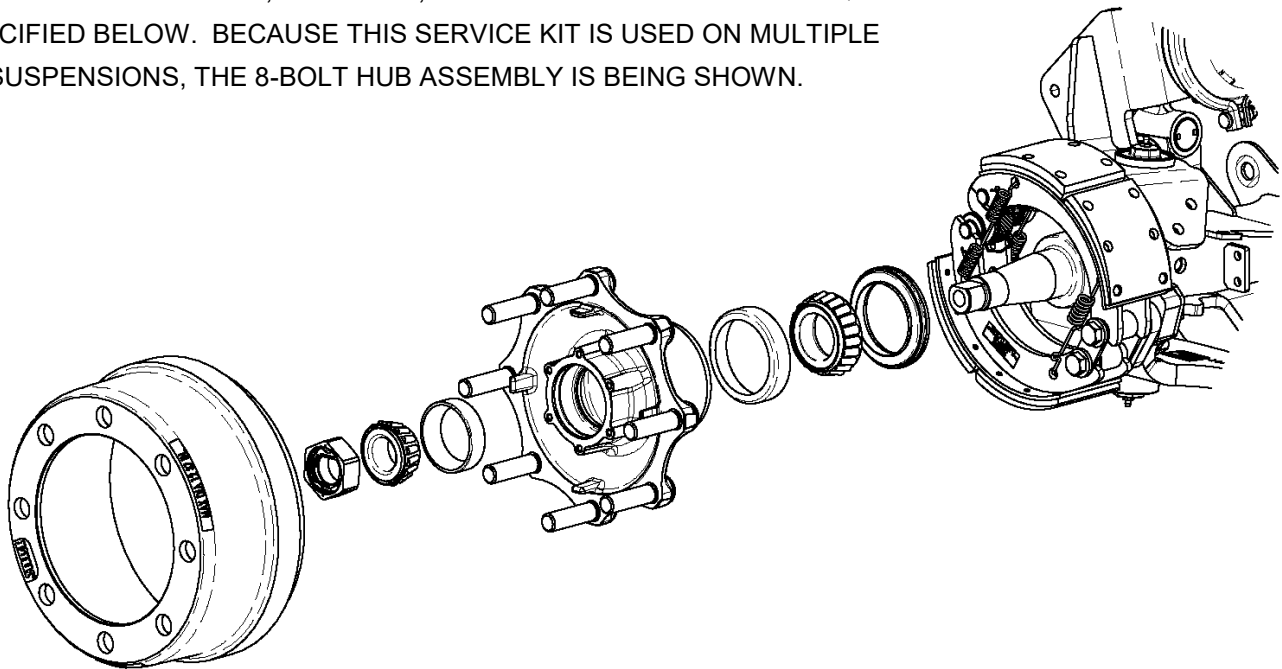

For instructional purposes, the proceeding will show the installation of the left hand side. The installation of the right hand side is the same.

INSTALL WHEEL HUB WITH SEAL, BEARINGS, BEARING RACES AND ZIP-TORQ NUT AS SPECIFIED BELOW. BECAUSE THIS SERVICE KIT IS USED ON MULTIPLE AUXILIARY SUSPENSIONS, THE 8-BOLT HUB ASSEMBLY IS BEING SHOWN.





#### SEAT THE BEARING RACES INTO THE WHEEL HUB

##### SEAT THE BEARING:

- 1)  **TORQUE** THE NUT TO 200 FT-LBS AND SPIN THE HUB AT LEAST ONE FULL ROTATION.
- 2)  **TORQUE** THE NUT AGAIN TO 200 FT-LBS AND SPIN THE HUB AT LEAST ONE FULL ROTATION.
- 3)  **TORQUE** THE NUT TO 200 FT-LBS AND THEN BACK OFF THE NUT UNTIL LOOSE.

##### ADJUST THE BEARING:

- 1)  **TORQUE** THE NUT TO 100 FT-LBS AND SPIN THE HUB AT LEAST ONE FULL ROTATION.
- 2)  **TORQUE** THE NUT AGAIN TO 100 FT-LBS AND SPIN THE HUB AT LEAST ONE FULL ROTATION.
- 3)  **TORQUE** THE NUT TO 100 FT-LBS AND THEN BACK OFF THE NUT SLIGHTLY.
- 4) CHECK FOR ACCEPTABLE END PLAY.

#### INSTALL BRAKE DRUM

##### ACCEPTABLE END PLAY:

- 1) THE DIAL INDICATOR SHOULD BE ATTACHED TO THE HUB OR BRAKE DRUM WITH ITS MAGNETIC BASE. ADJUST THE DIAL INDICATOR SO THAT ITS PLUNGER IS AGAINST THE END OF THE SPINDLE WITH ITS LINE OF ACTION APPROXIMATELY PARALLEL TO THE AXIS OF THE SPINDLE.
- 2) WITH THE DRUM SECURED TO THE HUB, GRASP THE ASSEMBLY AT 3 O'CLOCK AND 9 O'CLOCK POSITIONS. PUSH AND PULL THE ASSEMBLY IN AND OUT WHILE OSCILLATING THE ASSEMBLY APPROXIMATELY 45 DEGREES. STOP OSCILLATING THE HUB SO THAT THE DIAL INDICATOR TIP IS IN THE SAME POSITION AS IT WAS BEFORE OSCILLATING BEGAN. READ THE BEARING END-PLAY AS THE TOTAL INDICATOR MOVEMENT.
- 3) **ACCEPTABLE END PLAY IS .001" - .005".**

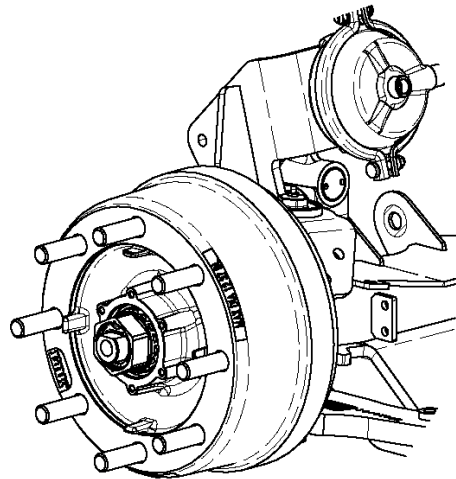

INSTALL HUB CAP WITH GASKET. TIGHTEN FASTENERS WITH A **TORQUE** OF 15 FT-LBS.

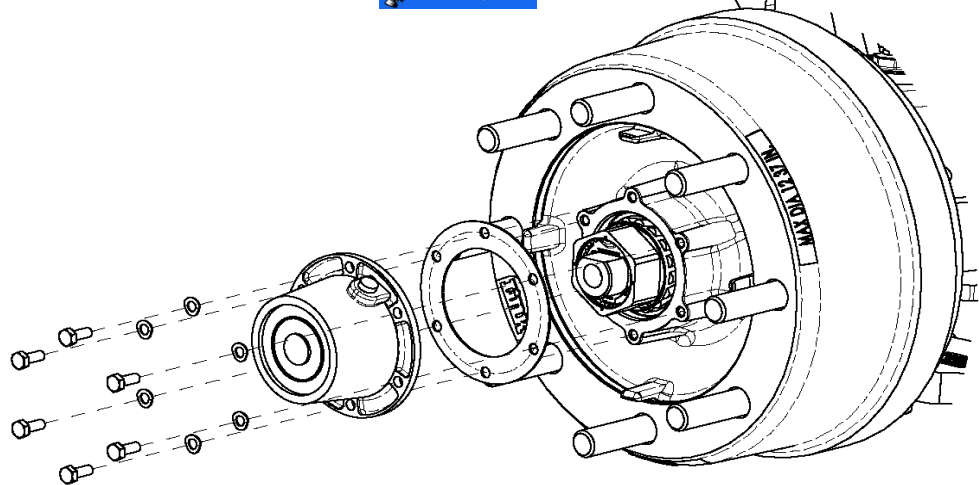

REMOVE OIL FILL PLUG FROM HUB CAP AND FILL WITH OIL (SAE 80W/90 MINERAL BASED) TO THE TOP OF THE OIL LINE. RE-INSTALL OIL PLUG INTO HUB CAP.

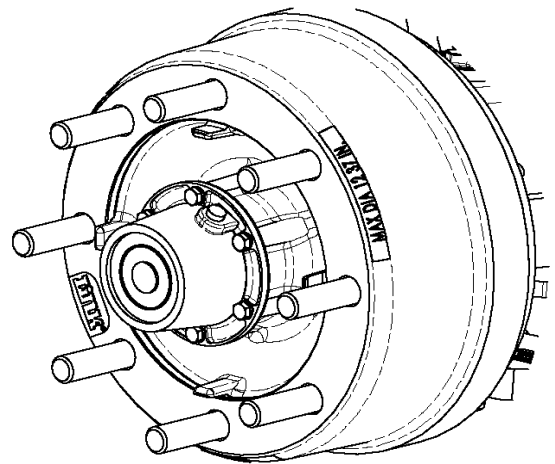

Wherever possible, Link Manufacturing, LTD encourages the use of best practices in the industry in service and support of the products it manufactures. Many of these recommended practices that Link Manufacturing, LTD supports can be found in documentation compiled by The Technology & Maintenance Council (TMC). To obtain copies of the following Recommend Practice (RP's), contact TMC at

TMC/ATA  
2200 Mill Road  
Alexandria, VA 22314

Phone: 703-838-1763  
Website: [tmc.truckline.com](http://tmc.truckline.com)  
Online ordering: [www.truckline.com/store](http://www.truckline.com/store)

TMC RP 222C	User's Guide to Wheels and Rims
TMC RP 607B	Preventative Maintenance and Inspection of S-Cam Foundation Brakes
TMC RP 608B	Brake Drums and Rotors
TMC RP 609B	Self Adjusting and Manual Brake Adjuster Removal, Installation, and Maintenance
TMC RP 618A	Wheel Bearing Adjustment Procedure
TMC RP 622A	Wheel Seal and Bearing Removal, Installation, and Maintenance
TMC RP 631B	Recommendations For Wheel End Lubrication
TMC RP 644A	Wheel End Conditions Analysis Guide
TMC RP 645	Tie Rod End Inspection and Maintenance Procedure
TMC RP 648	Troubleshooting Ride Complaints
TMC RP 651	Steer Axle Maintenance Guidelines
TMC RP 1503	Brake Maintenance Guidelines for Severe Vocational Applications
TMC RP 1515	Auxiliary Axle Maintenance Guidelines For Vocational Vehicles



LINK MANUFACTURING, LTD.  
223 15TH ST. NE, SIOUX CENTER, IA 51250  
1-800-222-6283 [www.linkmfg.com](http://www.linkmfg.com)