

LINK Auxiliary Suspensions

INSTALLATION INSTRUCTIONS

**800A0214
REVERSE LOCK KIT
FOR 20K AUXILIARY SUSPENSION**

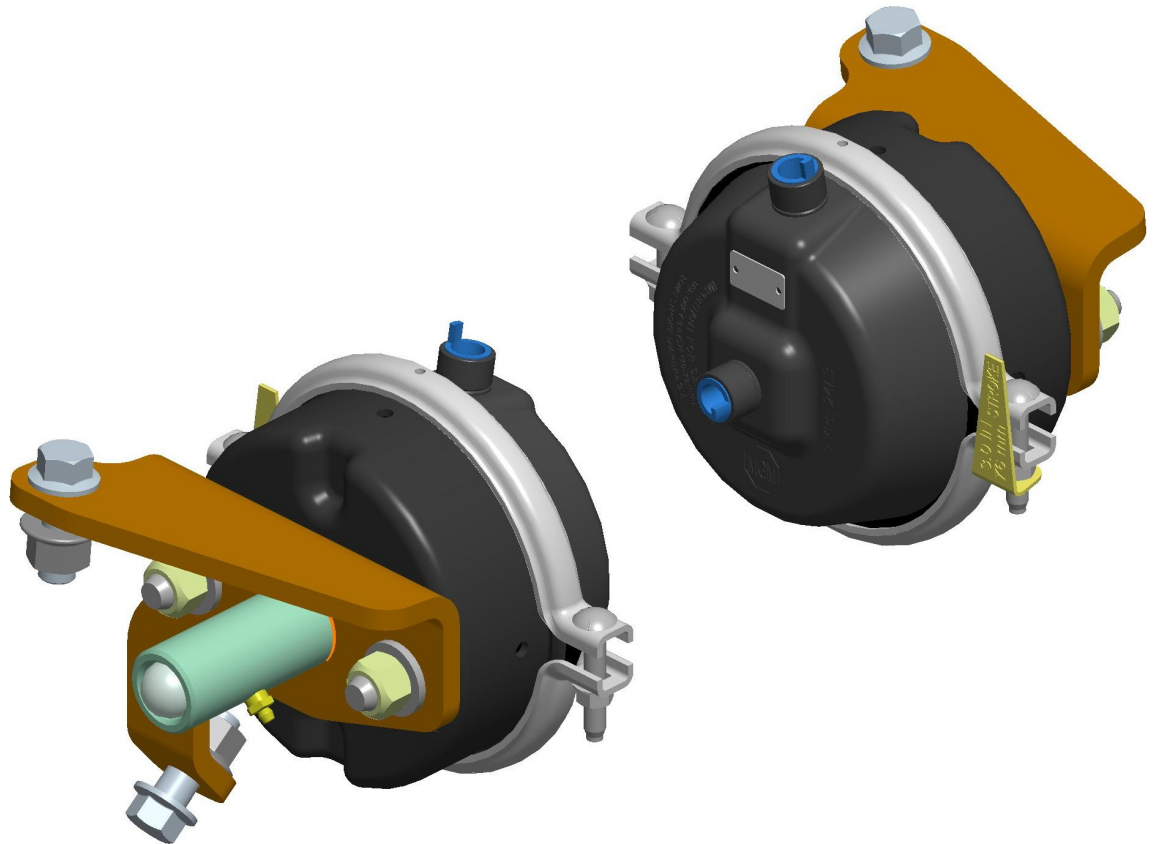

Link Mfg. Ltd.
223 15th St. N.E.
Sioux Center, IA USA
51250-2120
www.linkmfg.com

**QUESTIONS?
CALL CUSTOMER
SERVICE
1-800-222-6283**

IMPORTANT: IT IS IMPORTANT THAT THE ENTIRE INSTALLATION INSTRUCTIONS BE READ THOROUGHLY BEFORE PROCEEDING WITH THE INSTALLATION.





1. INTRODUCTION

Thank you for choosing a Link Auxiliary Suspension. We want to help you get the best results from this suspension and to operate it safely. This instruction contains information to assist in the installation of the reverse lock assemblies for your Link Auxiliary Suspension. This instruction is intended solely for use with this product.

All information in this instruction is based on the latest information available at the time of printing. Link Manufacturing reserves the right to change its products or manuals at any time without notice.

Damaged components should be returned to Link with a pre-arranged Returned Materials Authorization (RMA) number through the Customer Service Department. The damaged component may then be replaced if in compliance with warranty conditions.

2. SAFETY SYMBOLS, TORQUE SYMBOL, and NOTES

 DANGER	DANGER indicates a hazardous situation which if not avoided, will result in death or serious injury.
 WARNING	WARNING indicates a potentially hazardous situation which, if not avoided, could result in death or serious injury.
 CAUTION	CAUTION indicates a potentially hazardous situation which, if not avoided, could result in minor or moderate injury.
 NOTICE	NOTICE indicates a potentially hazardous situation which, if not avoided, may result in property damage.
 TORQUE	TORQUE indicates named fasteners are to be tightened to a specified torque value.
NOTE:	A Note provides information or suggestions that help you correctly perform a task.

3. SAFE WORKING PRACTICES

 **CAUTION** When handling parts, wear appropriate gloves, eyeglasses, ear protection, and other safety equipment.

 **CAUTION** Proper tightening of fasteners is important to the performance and safety of the suspension. Follow all torque specifications throughout the instructions.

4. INSTALLATION GUIDELINES

- 4.1 Put the auxiliary suspension in the lowered position and make sure the truck is on level ground with the parking brake set.
- 4.2 Remove paint on all axle contact points.
- 4.3 Align bolt on bracket with mounting bracket and secure with 16mm fasteners provided as shown.
- 4.4  **TORQUE** 16mm lock nuts to 200 FT-LBS.
- 4.5 Reapply paint to non-painted surfaces.

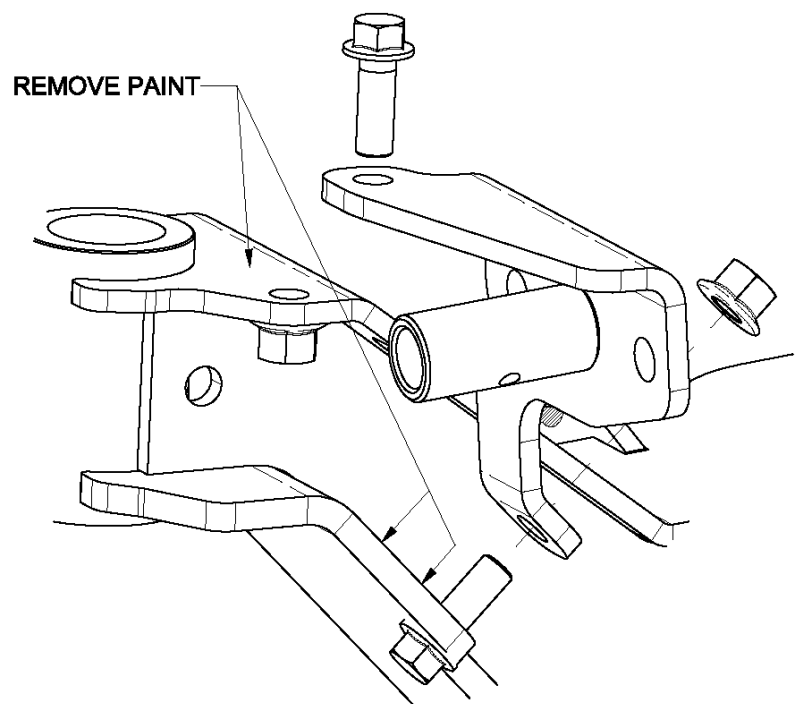

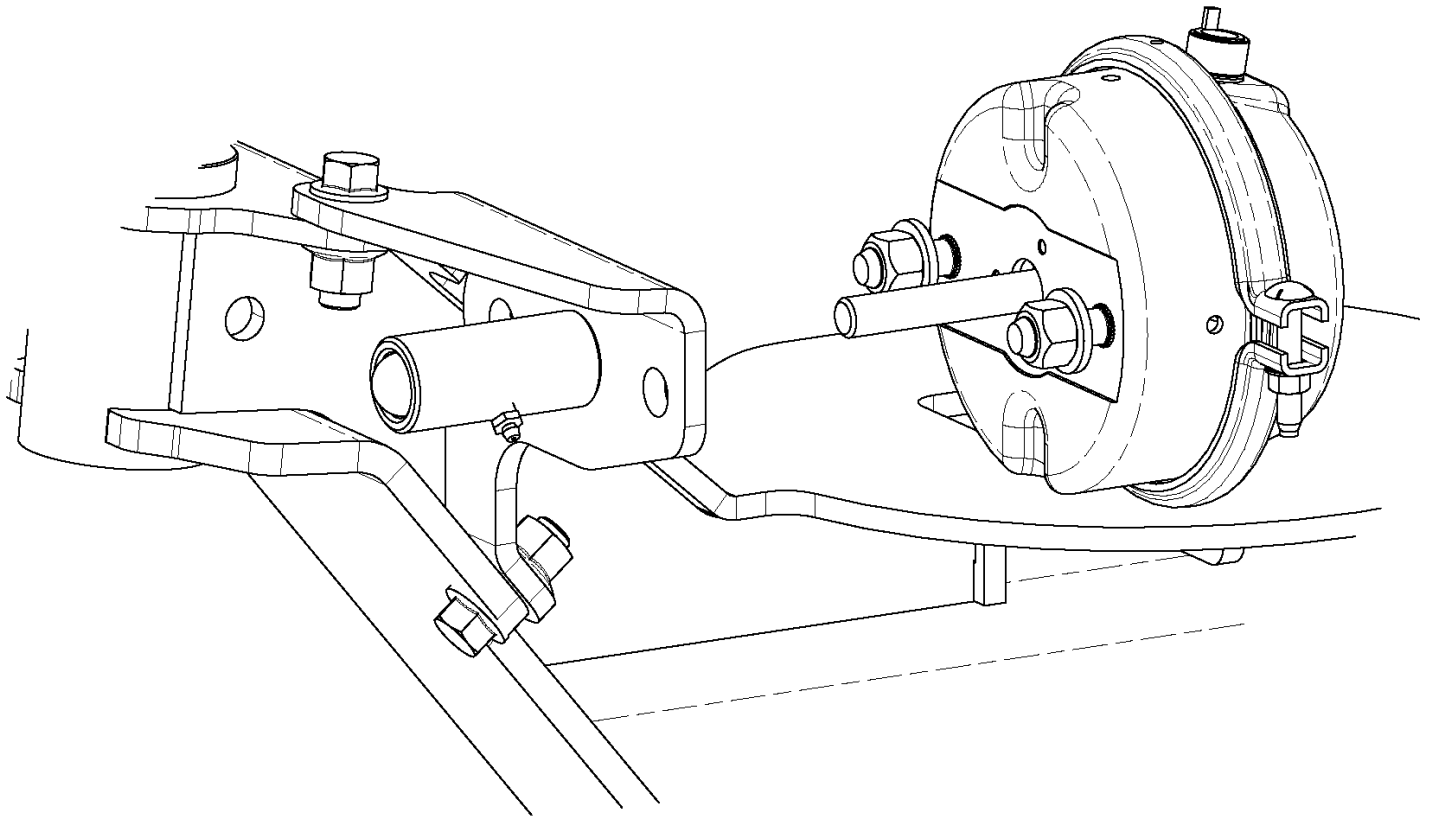

4. INSTALLATION GUIDELINES continued

4.6 Insert the air chamber assembly into the mounting bracket as shown above.

4.7  **TORQUE** 5/8" lock nuts to 150 FT-LBS.

4.8 Insert grease (Multipurpose NLGI 2) into grease zerk until it is barely visible around the Stop Nut of the locking assembly.

4.9 Repeat the steps 4.2 - 4.8 on the opposite end of the axle.

4.10 Plumb the air chamber assemblies into the air line circuits as desired.

5. STEERING LOCK BRACKET INSTALLATION

5.1 Install steering lock bracket onto brake anchor bolts.

5.2 After installation,  **TORQUE** M16 to 218 FT-LBS.

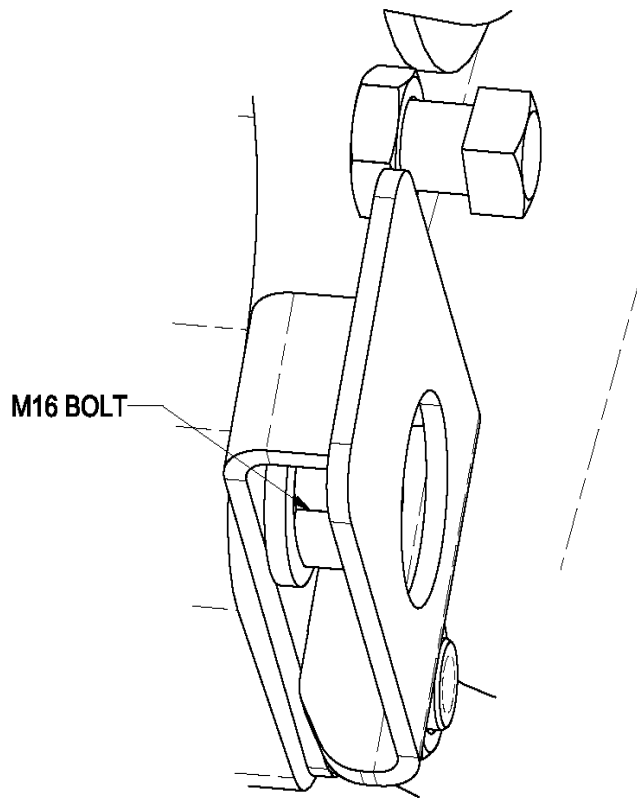

6. OPERATION

- 6.1 Engage the Reverse Lock when the wheels of the Auxiliary Suspension are straight. The Reverse Lock will hold the wheels straight when backing up, but may not force the wheels straight if the lock is engaged with the wheels turned under loaded conditions.
- 6.2 Adjust plunger as needed to ensure contact with knuckle.

