



Link Mfg. Ltd.
223 15th St. N.E.
Sioux Center, IA USA
51250-2120
www.linkmfg.com

**QUESTIONS?
CALL CUSTOMER
SERVICE
1-800-222-6283**

INSTALLATION INSTRUCTIONS

4AS00042 Complete Brake Service Kit For 13.5K Auxiliary Suspensions

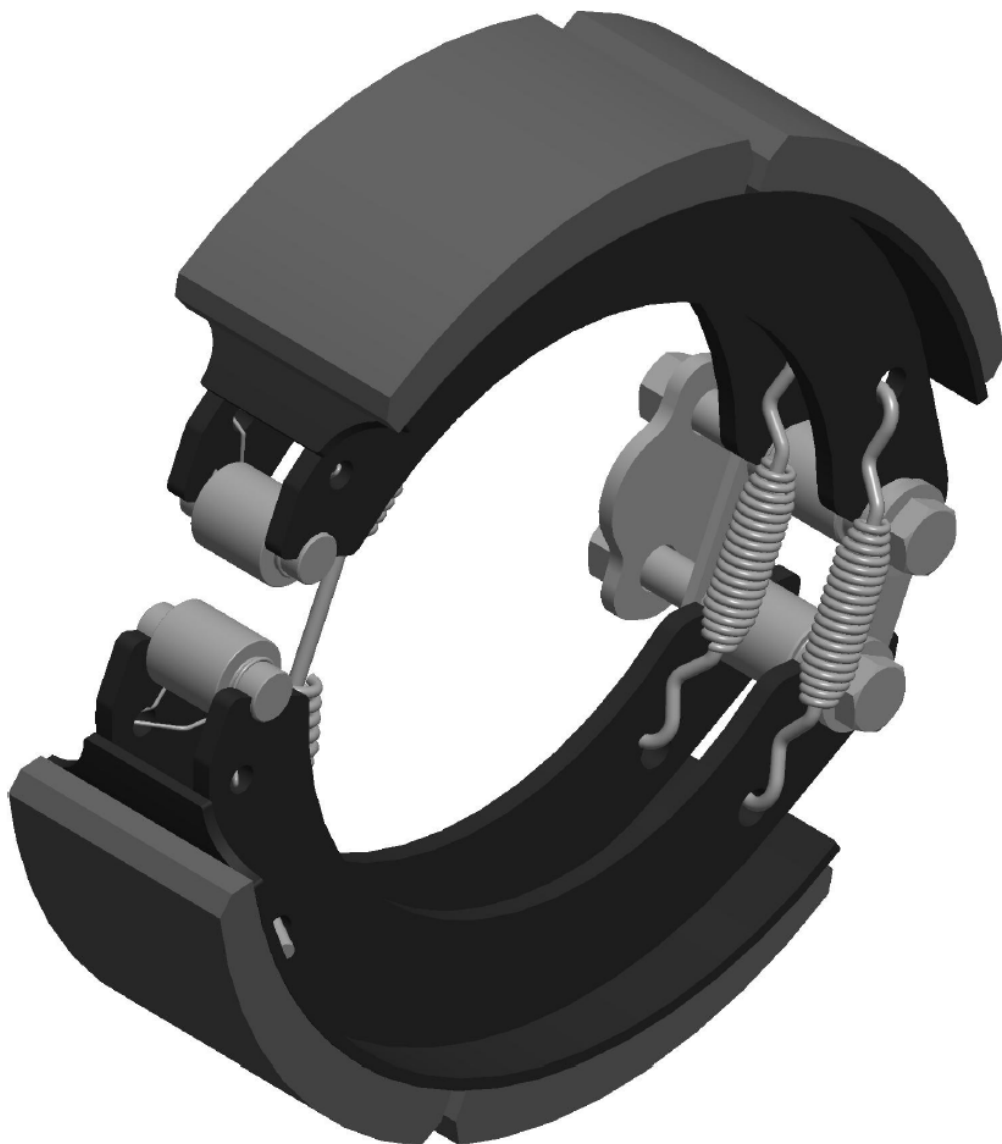

IMPORTANT: IT IS IMPORTANT THAT THE ENTIRE INSTALLATION INSTRUCTIONS BE READ THOROUGHLY BEFORE PROCEEDING WITH THE INSTALLATION.

1. INTRODUCTION





Thank you for choosing a Link Auxiliary Suspension. We want to help you get the best results from this suspension and to operate it safely. This instruction contains information to assist in the installation of the complete brake assembly for your Link Auxiliary Suspension. This instruction is intended solely for use with this product.

All information in this instruction is based on the latest information available at the time of printing. Link Manufacturing reserves the right to change its products or manuals at any time without notice.

Damaged components should be returned to Link with a pre-arranged Returned Materials Authorization (RMA) number through the Customer Service Department. The damaged component may then be replaced if in compliance with warranty conditions.

2. SAFETY SYMBOLS, TORQUE SYMBOL, and NOTES

3. SAFE WORKING PRACTICES

 DANGER	DANGER indicates a hazardous situation which if not avoided, will result in death or serious injury.
 WARNING	WARNING indicates a potentially hazardous situation which, if not avoided, could result in death or serious injury.
 CAUTION	CAUTION indicates a potentially hazardous situation which, if not avoided, could result in minor or moderate injury.
 NOTICE	NOTICE indicates a potentially hazardous situation which, if not avoided, may result in property damage.
 TORQUE	TORQUE indicates named fasteners are to be tightened to a specified torque value.
NOTE:	A Note provides information or suggestions that help you correctly perform a task.

When handling parts, wear appropriate gloves, eyeglasses, ear protection, and other safety equipment.

 **CAUTION**

Proper tightening of fasteners is important to the performance and safety of the suspension. Follow all torque specifications throughout the instructions.

 **CAUTION**

4. BRAKE ANCHOR PIN INSTALLATION

Assemble anchor pins and plates as shown.

 **TORQUE** M16 x 2.0 Fasteners - 200 FT-LBS

NOTE: For clarity purposes hub and bearings are not shown.

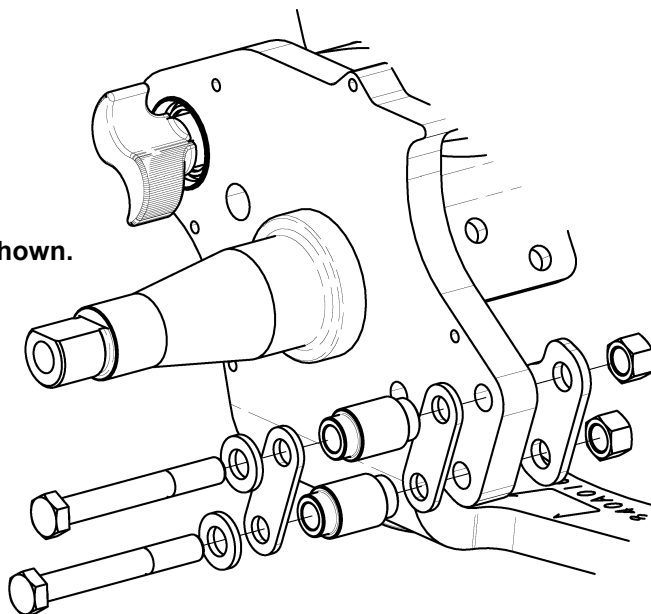

5. CAM ROLLER INSTALLATION

Assemble cam rollers with retention springs as shown.

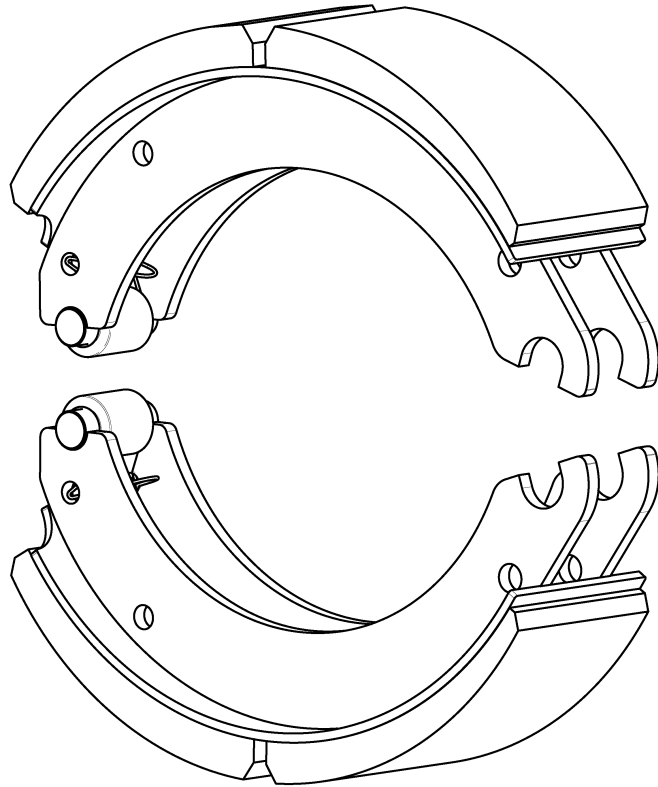

6. BRAKE SHOE SPRING INSTALLATION

Install spring mount bars and brake shoe return spring near cam rollers as shown.

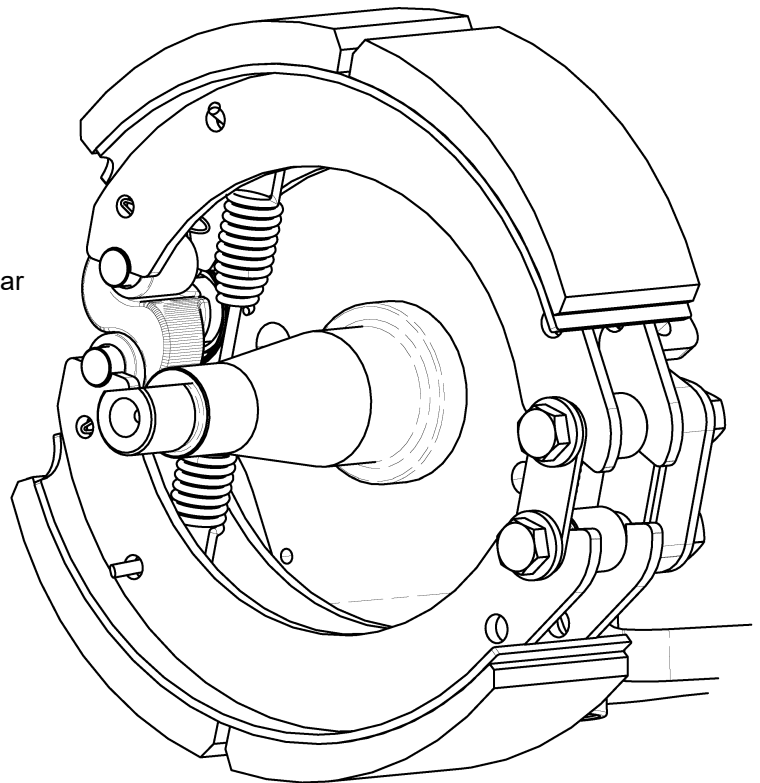

7. INNER LOWER BRAKE SHOE SPRING INSTALLATION

Orient and install lower brake shoe retainer springs near anchor pins as shown..

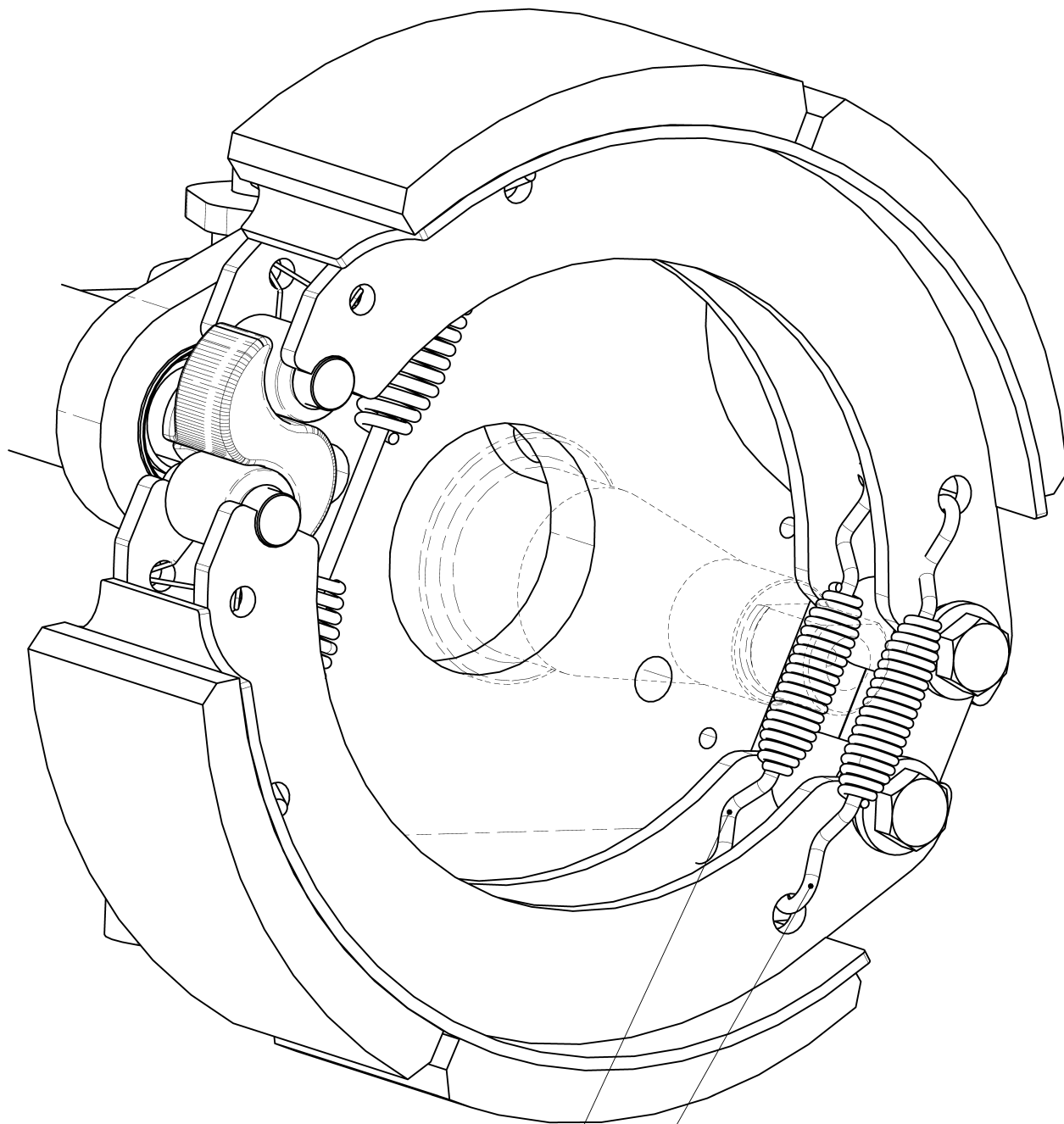

NOTICE

ORIENTATION OF THE INNER SPRING
ON THE INSIDE OF THE BRAKE
SHOE BETWEEN THE SHOE RIBS

NOTICE

ORIENTATION OF THE OUTER
SPRING ON THE OUTSIDE
OF THE BRAKE SHOE RIBS

8. REPEAT STEPS 4 THROUGH 7 ON OPPOSITE SIDE

10. MAKE ANY NECESSARY ADJUSTMENTS TO EACH BRAKE ADJUSTER ON THE NEWLY REPLACED BRAKE ASSEMBLY. IF NECESSARY, REFER TO THE LATEST TMC RP609.