

LINK Auxiliary Suspensions

INSTALLATION INSTRUCTIONS

800A0265 - Duramax Integrated Air With GT Control Module

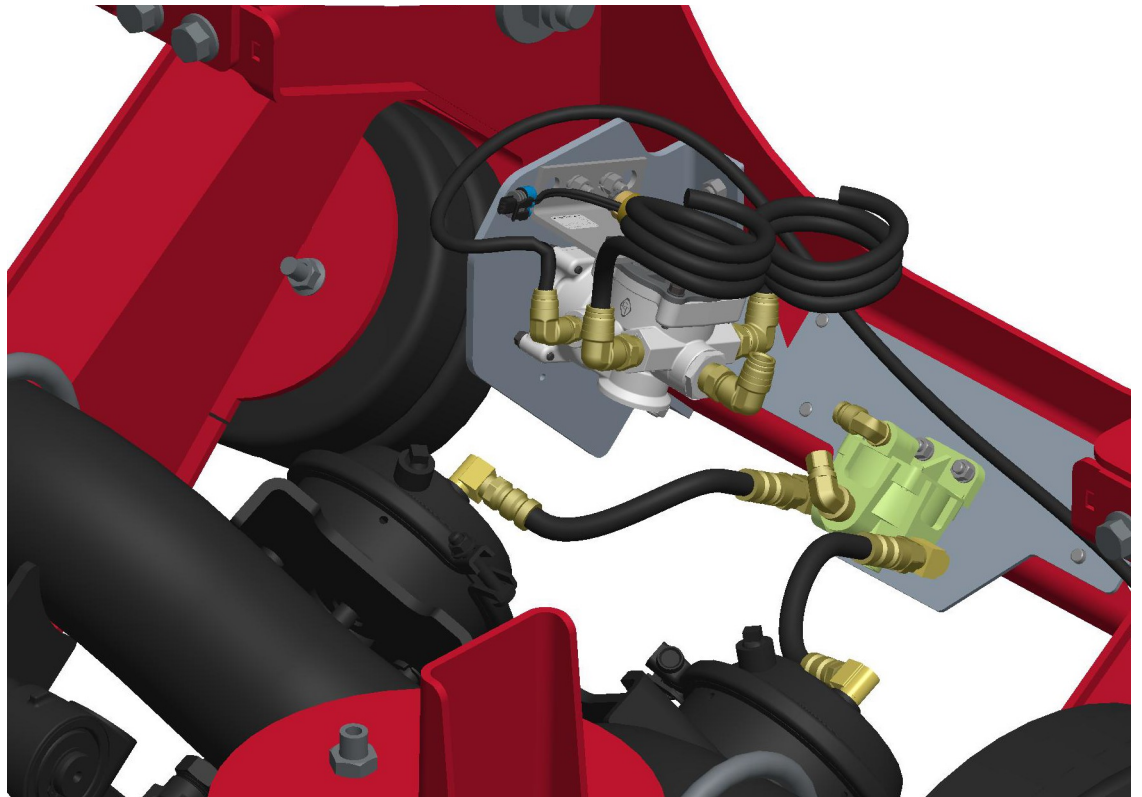

Link Mfg. Ltd.
223 15th St. N.E.
Sioux Center, IA USA
51250-2120
www.linkmfg.com

**QUESTIONS?
CALL CUSTOMER
SERVICE
1-800-222-6283**

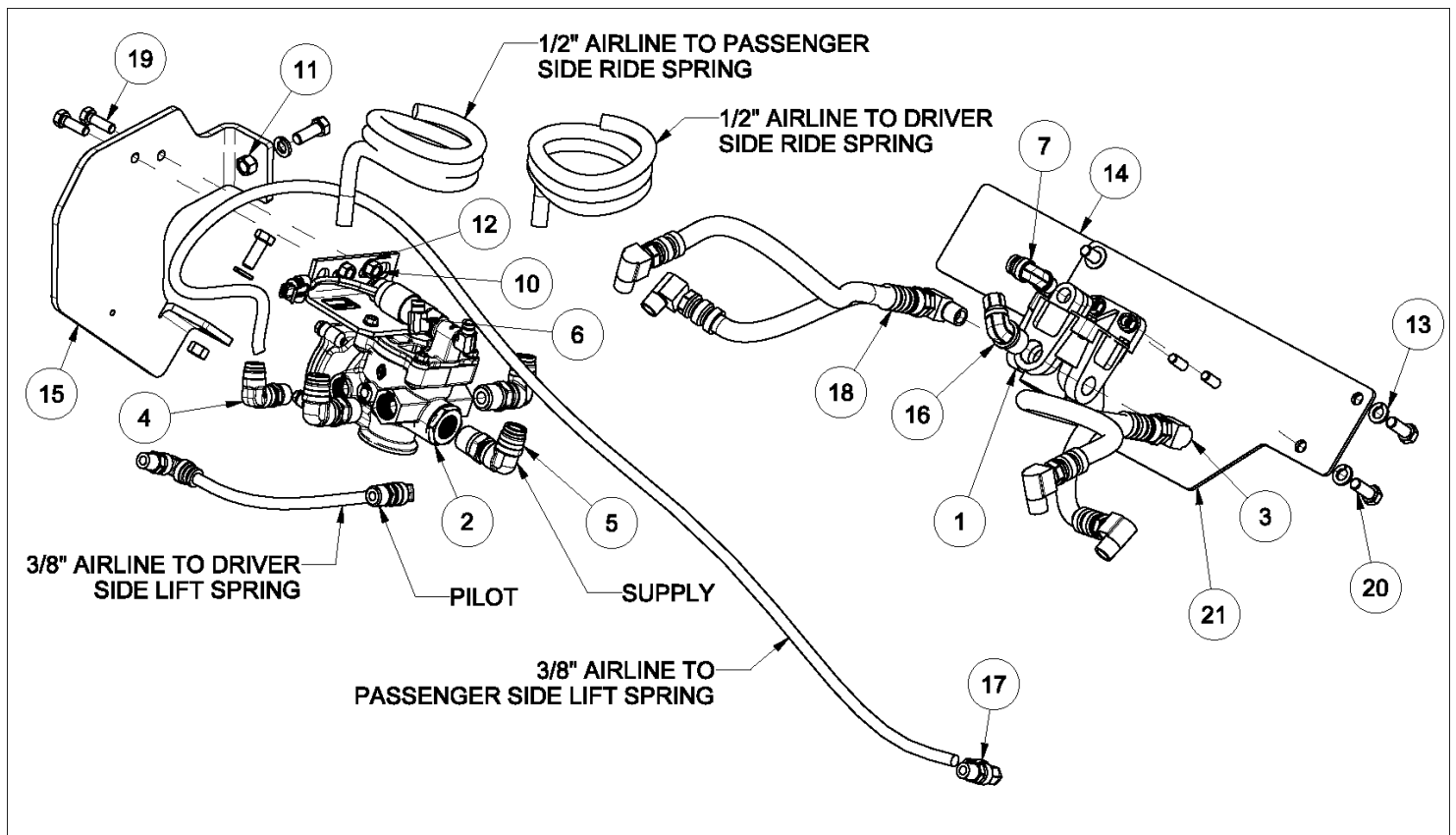

ITEM	PART NUMBER	DESCRIPTION	QTY
1	13010508	RELAY VALVE, RG-2, MIDLAND	1
2	13010571	LIFT AXLE CONTROL MODULE	1
3	13022102	ELBOW, 90 STREET (3/8-NPT)	4
4	13025095	ELBOW-SWIV, 90 - 3/8" TB X 3/8" MNPT DOT	2
5	13025099	ELBOW-SWIV, 90 - 1/2" TB X 1/2" MNPT DOT	3
6	13025100	ELBOW, 1/4 TB 1/8 M-NPT, PUSH-IN DOT	1
7	13025104	ELBOW-3/8 TB 1/4 M-NPT	1
8	13034000	AIRLINE-NYLON, .375 O.D., BULK	6 FT
9	13035000	AIRLINE-NYLON, .500 O.D., BULK	7.5 FT
10	14701000	5/16 UNC HEX NUT (GR B)	4
11	147011200	3/8 UNC HEX NUT (GR B)	2
12	14851000	5/16 LOCK WASHER	4
13	14851200	3/8 LOCK WASHER	6
14	80002131	MOUNT PLATE, BRAKE VALVE	1
15	80002296	BRACKET, VALVE MOUNTING	1
16	13024041	ELBOW-3/8 TB, 1/2 M-NPT	1
17	13025094	ELBOW-SWIV, 3/8 TB X 1/4 M-NPT	2
18	13029972	ASSEMBLY-AIR BRAKE HOSE (26 IN.)	2
19	140B1008	5/16 X 1 UNC HEX CAP SCR (GR 8) O&P	4
20	140B1208	3/8 X 1 UNC HEX CAP SCR (GR 8) O&P	6
21	800A0262	MOUNT PLATE WELDMENT, BRAKE VALVE	1

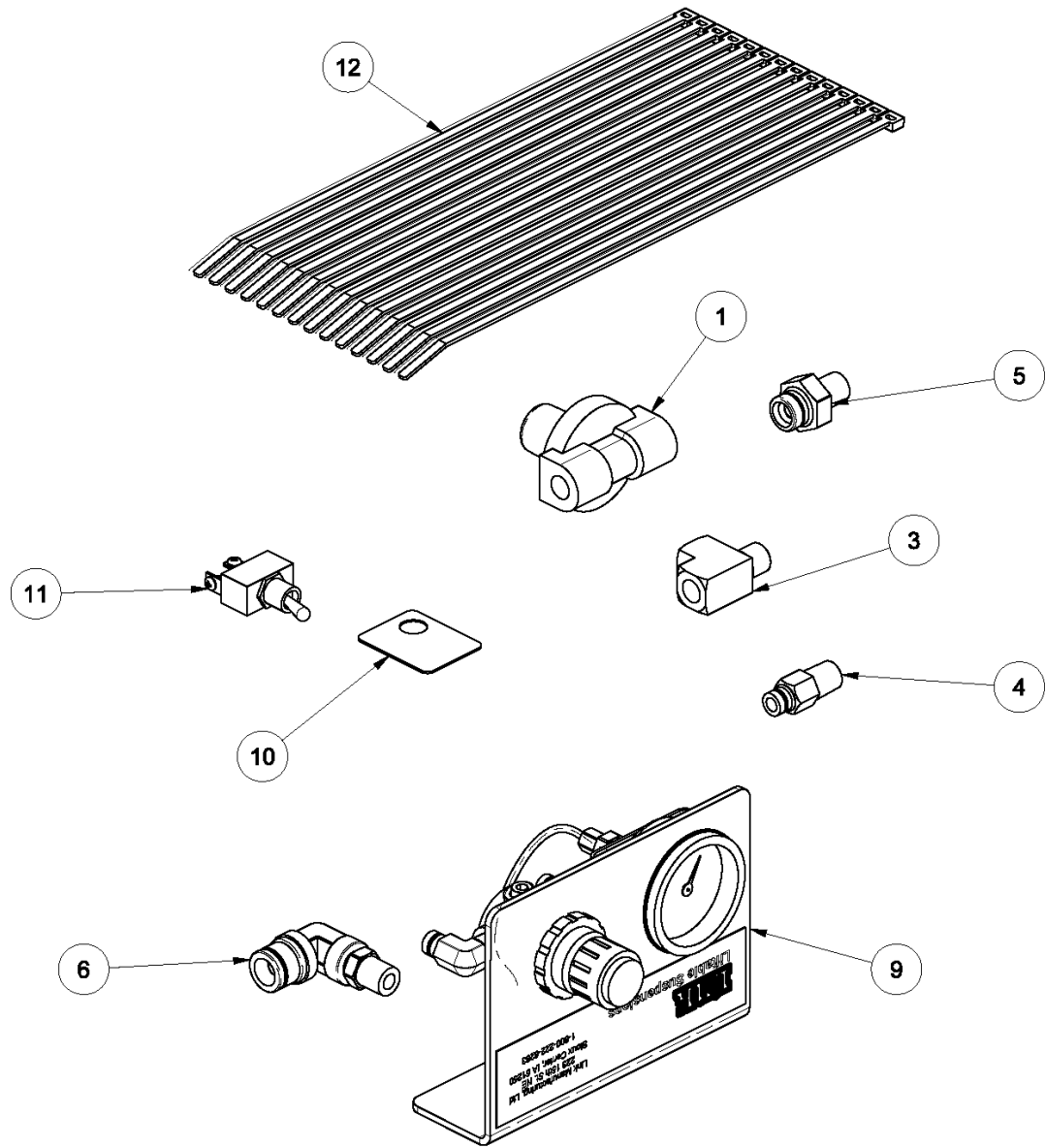

ITEM	PART NUMBER	DESCRIPTION	QTY
1	13010084	VALVE-PRESSURE PROTECTION	1
2	13020090	AIRLINE-NYLON, .250 O.D., BULK	30 FT
3	13022123	STREET TEE, 1/4 F-NPT, M-NPT	1
4	13025046	CONNECTOR, 1/4 TB 1/4 M-NPT	1
5	13025051	CONNECTOR-MALE, 1/2 TB, 1/4 NPT	1
6	13025097	ELBOW- SWIV, 1/2 TB, 1/4 M-NPT	2
7	13034000	AIRLINE-NYLON, 0.375 O.D., BULK	20FT
8	13035000	AIRLINE-NYLON, 0.500 O.D., BULK	25 FT
9	13501018	AIR CONTROL ASSEMBLY	1
10	15001318	PLATE-SWITCH, LIFT	1
11	15050350	SWITCH-TOGGLE	1
12	15060081	NYLON CABLE TIE, 11" LONG	14
13	15092000	CORRUGATED LOOM, 3/8" BULK	10 FT

NOTES:

- 1) Use 1/4", 3/8", and 1/2" DOT airline for all plumbing between fittings as shown per figure 2. Use brass DOT fittings for all plumbing connections. Use 14-gage primary wire for all electrical connections.
- 2) Considerations should be made to route all wiring and airline in protective locations away from any moving parts.
- 3) Cable ties or other fastening devices may be required to secure airline, wire and/or fittings to truck/suspension.
- 4) Apply Permatex #807 or comparable anaerobic pipe thread sealant to fill three exterior pipe threads on brass fittings and tighten 1-1/2 revolutions beyond hand tight.

Non-Steer suspension with lift axle up when ignition is off.

PLUMBING INSTRUCTIONS

FIG. 1

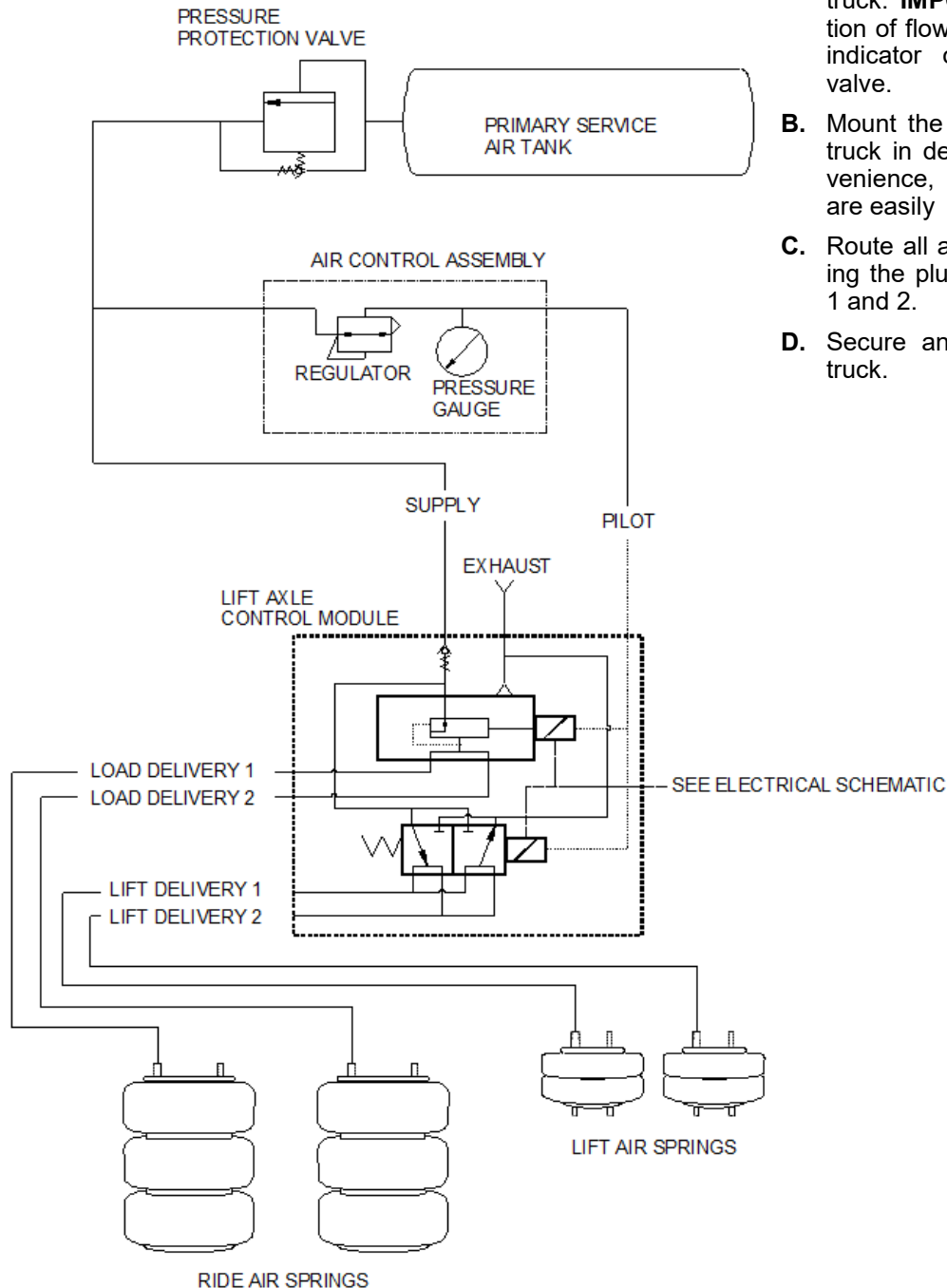

- A. Connect the pressure protection valve directly to the air supply tank on the truck. **IMPORTANT:** Make sure direction of flow for the system matches flow indicator on the pressure protection valve.
- B. Mount the Air Control Assembly to the truck in desired location for driver convenience, making sure the air controls are easily accessible.
- C. Route all airlines to you suspension using the plumbing schematics in Figures 1 and 2.
- D. Secure any loose components to the truck.

ITEM PART DESCRIPTION

1. VALVE-PRESSURE PROTECTION
2. REGULATOR—AIR PRESSURE
3. GAUGE—AIR PRESSURE
4. LIFT AXLE CONTROL MODULE

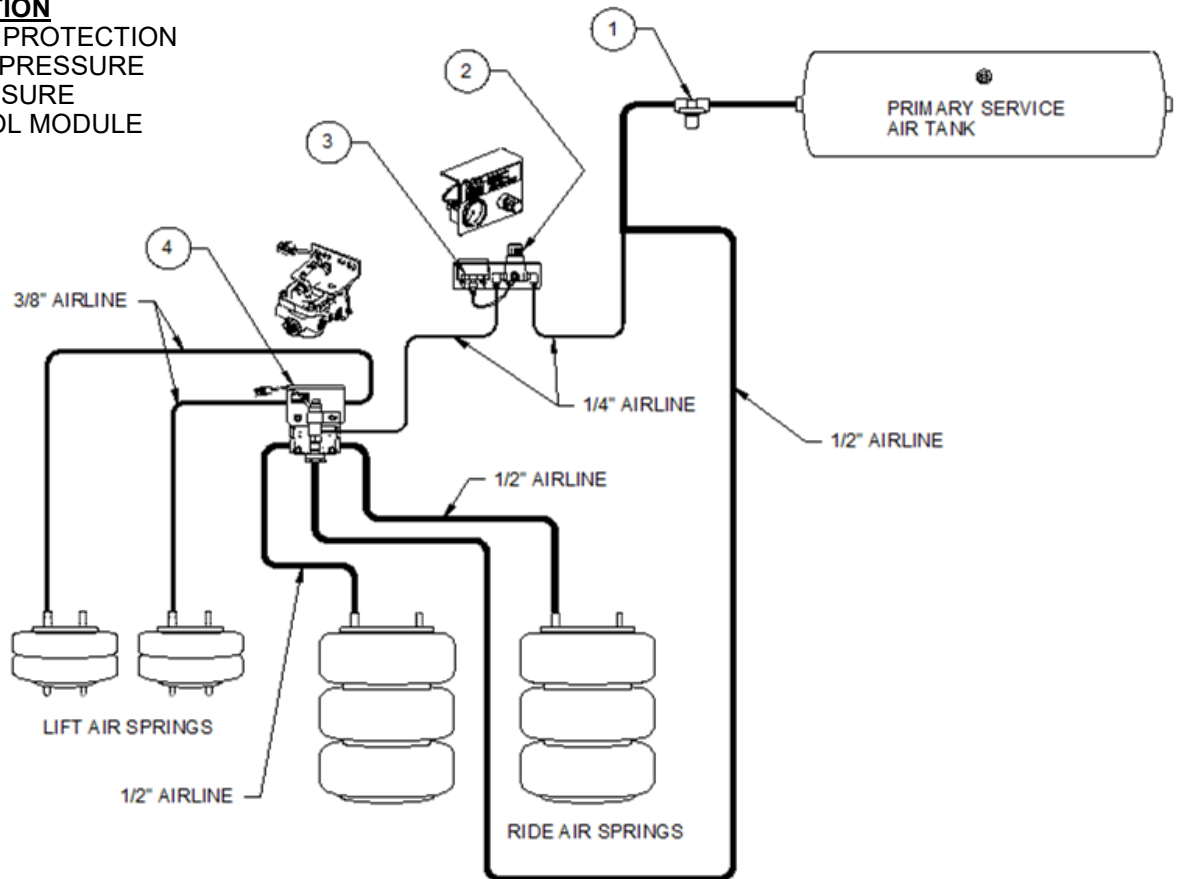

ELECTICAL INSTRUCTIONS

CAUTION: Always disconnect the battery while working with the vehicle's electrical system.

- Make all wiring connections to fuse, truck, and toggle switch as shown in Figure 3. **IMPORTANT:** Make sure that the toggle switch is wired so that the lift axle is down when the switch is on.
- Ground one of the white wires from the solenoid valve. **NOTE:** Make sure the 12VDC source is switched (turns off with the key).
- Mount the toggle switch and toggle switch plate to the interior of the truck in a desired location. **NOTE:** Make sure that lift axle position correlates with "Raise"/"Lower" position on toggle switch plate (tab on toggle switch plate may need to be removed).
- When all electrical connections have been made, reconnect the battery, pressurize the system and tighten any fittings that are leaking.

ELECTRICAL SCHEMATIC

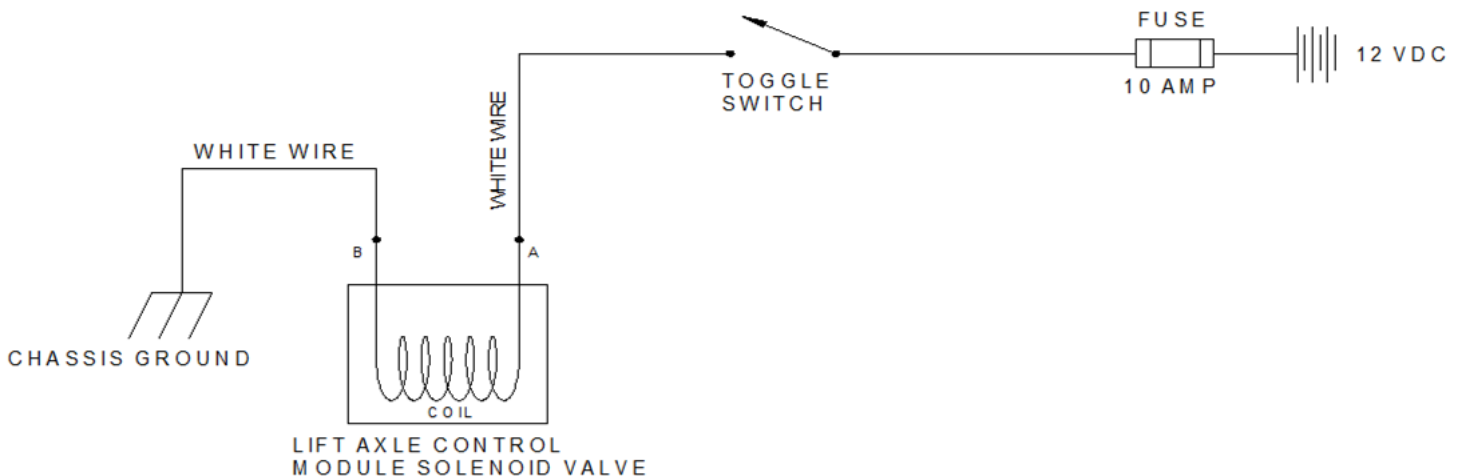



LINK MANUFACTURING, LTD.
223 15TH ST. NE, SIOUX CENTER, IA 51250
1-800-222-6283 www.linkmfg.com