



LINK

LIFTABLE SUSPENSIONS

INSTALLATION INSTRUCTIONS PARTS LIST

AIR CONTROL KIT (13501019)

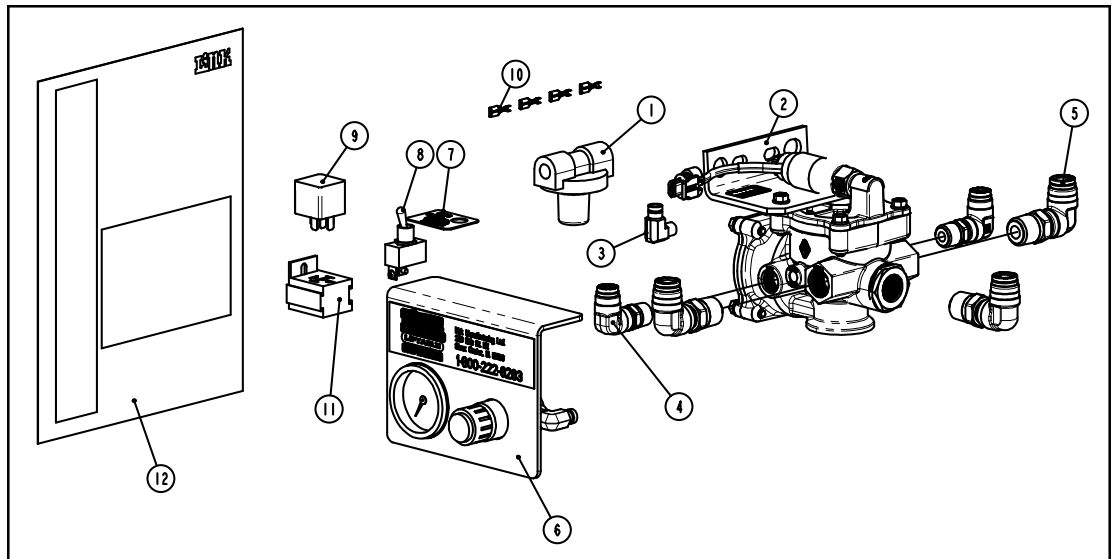

ITEM	PART NUMBER	DESCRIPTION	QTY
1	1301-0084	VALVE-PRESSURE PROTECTION	1
2	13010571	LIFT AXLE CONTROL MODULE	1
3	1302-5100	ELBOW, 1/4 TB 1/8 M-NPT, PUSH-IN DOT	1
4	13025095	ELBOW-SWIV 90 - 3/8" TB X 3/8 MNPT DOT	2
5	13025099	ELBOW-SWIV 90 - 1/2" TB X 1/2 MNPT DOT	3
6	13501018	AIR CONTROL ASSEMBLY	1
7	1500-1318	PLATE-SWITCH, LIFT	1
8	1505-0350	SWITCH-TOGGLE	1
9	1505-0351	RELAY	1
10	1505-0353	CONNECTOR-PUSH-ON, FEMALE	4
11	1505-0354	RELAY BASE	1
12	80001916	MANUAL-INSTALLATION, 13501019	1

OPTIONAL: For quicker and easier installation an additional Installation Kit (Link Mfg. part # 800A0256) provides a complete set of fasteners, connectors, airline, and wire for use with this kit. For details call Link Mfg. Customer Service at 1-800-222-6283.

Link Mfg. Ltd.
223 15th St. N.E.
Sioux Center, IA USA
51250-2120

(712) 722-4874
Fax (712) 722-4876

**QUESTIONS?
CALL CUSTOMER
SERVICE
1-800-222-6283**

NOTES:

- 1) Use 1/4", 3/8", and 1/2" DOT airline for all plumbing between fittings as shown per figure 2. Use brass DOT fittings for all plumbing connections. Use 14-gage primary wire for all electrical connections.
- 2) Considerations should be made to route all wiring and airline in protective locations away from any moving parts.
- 3) Cable ties or other fastening devices may be required to secure airline, wire and/or fittings to truck/suspension.
- 4) Apply Permatex #807 or comparable anaerobic pipe thread sealant to fill three exterior pipe threads on brass fittings and tighten 1-1/2 revolutions beyond hand tight.

Non-Steer suspension with lift axle up when ignition is off.

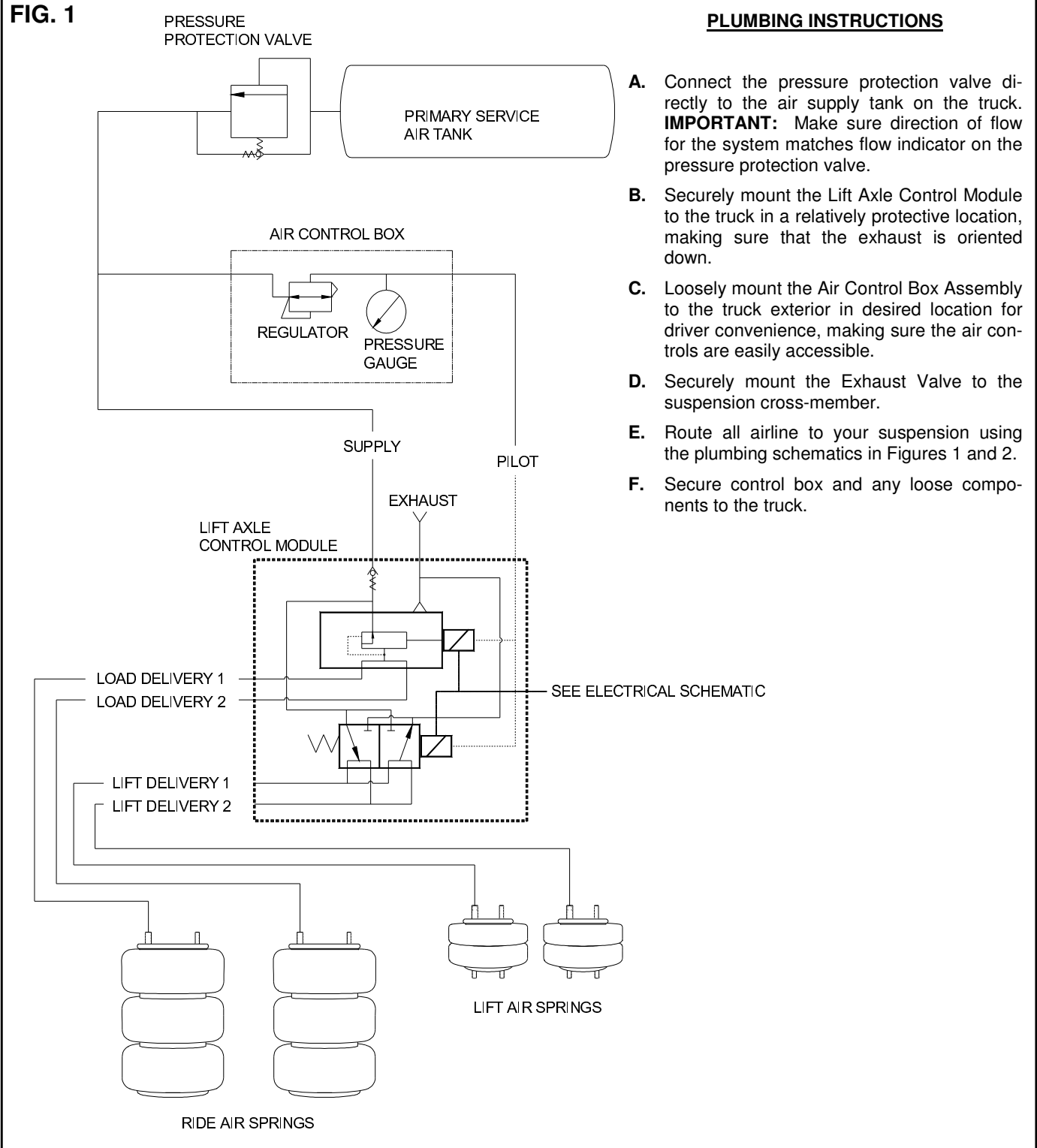

ITEM	PART DESCRIPTION
1	VALVE-PRESSURE PROTECTION
2	REGULATOR—AIR PRESSURE
3	GAUGE—AIR PRESSURE
4	LIFT AXLE CONTROL MODULE

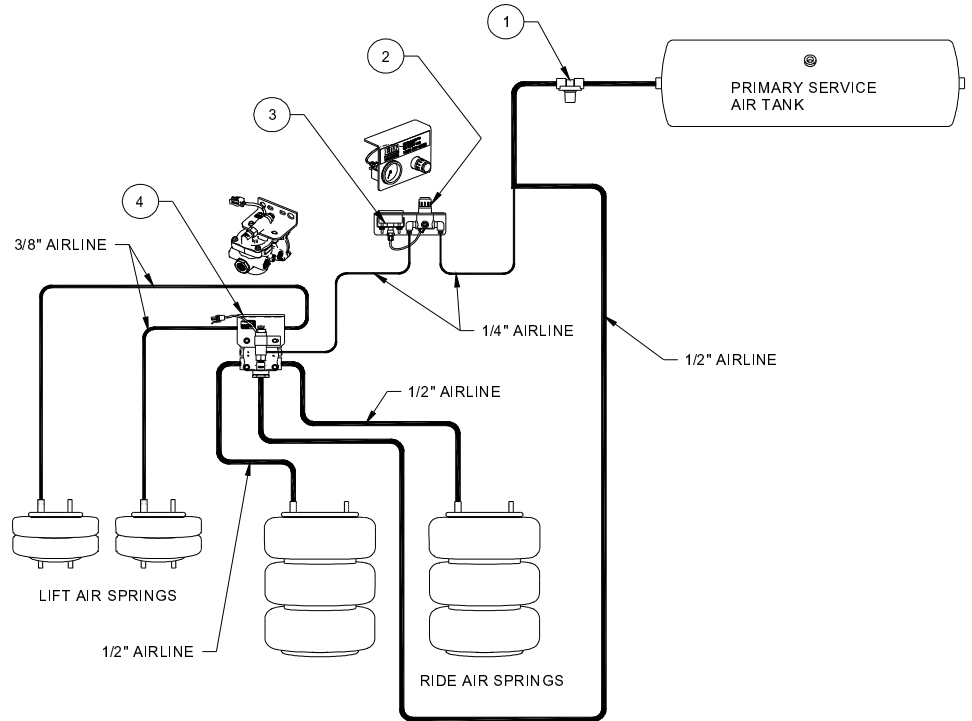

FIG. 2

ELECTRICAL INSTRUCTIONS

CAUTION: Always disconnect the battery while working with the vehicle's electrical system.

- A. Make all wiring connections to fuse, truck, and toggle switch as shown in Figure 3. **IMPORTANT:** Make sure that the toggle switch is wired so that the lift axle is down when the switch is on.
- B. Ground one of the white wires from the solenoid valve. **NOTE:** Make sure the 12VDC source is switched (turns off with the key).
- C. Mount the toggle switch and toggle switch plate to the interior of the truck in a desired location. **NOTE:** Make sure that lift axle position correlates with "Raise"/"Lower" position on toggle switch plate (tab on toggle switch plate may need to be removed).
- D. When all electrical connections have been made, reconnect the battery, pressurize the system and tighten any fittings that are leaking.

ELECTRICAL SCHEMATIC

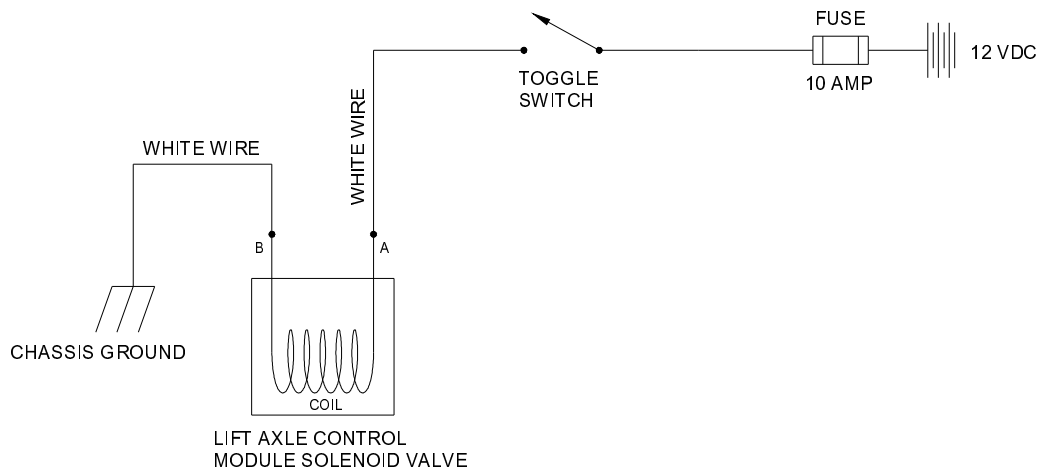
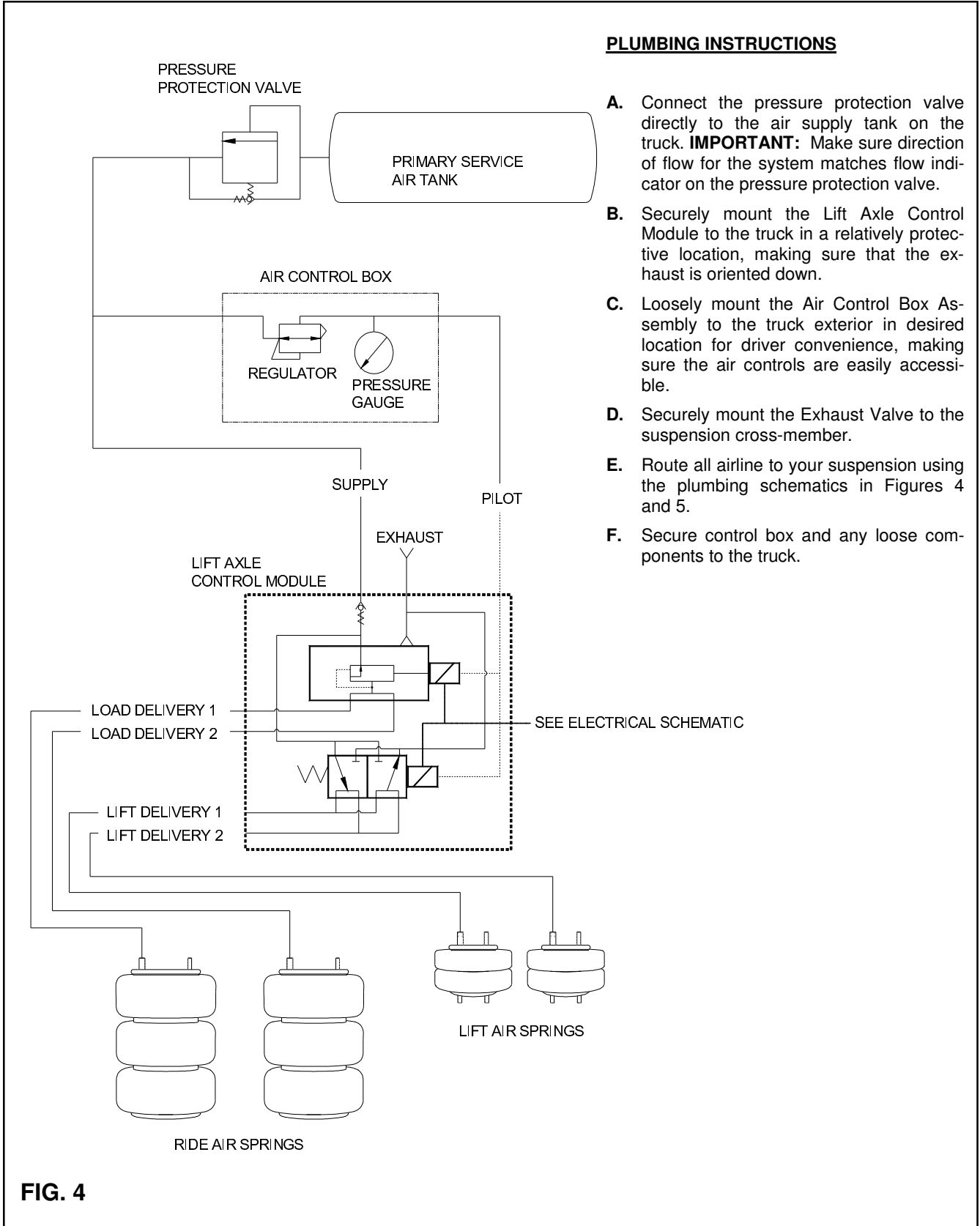

FIG. 3

Steerable suspension with lift axle up when ignition is off.



ITEM	PART DESCRIPTION
1	VALVE-PRESSURE PROTECTION
2	REGULATOR—AIR PRESSURE
3	GAUGE—AIR PRESSURE
4	LIFT AXLE CONTROL MODULE

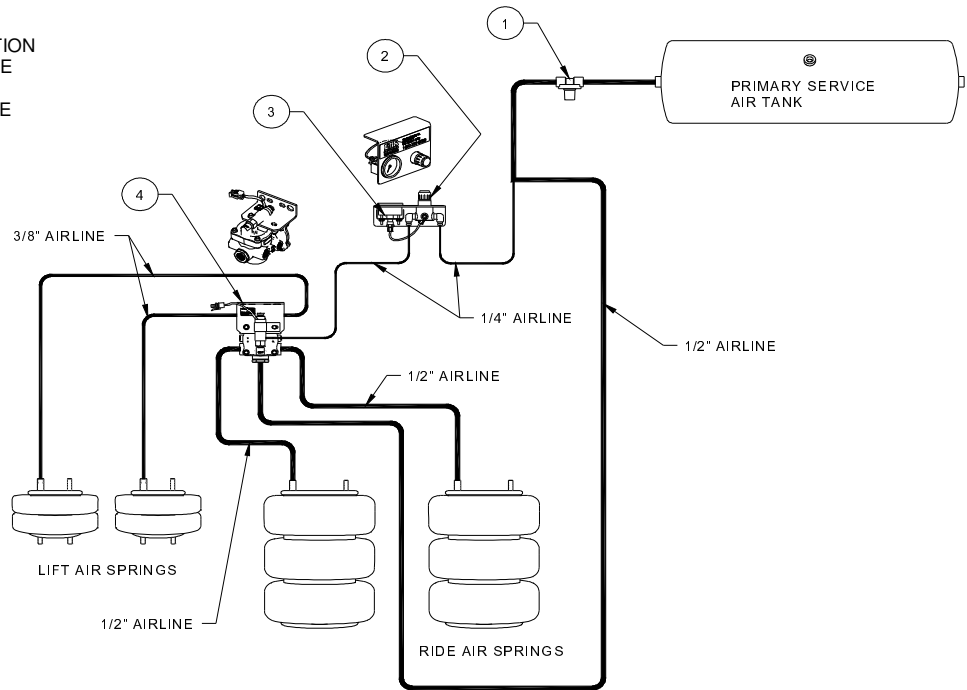

FIG. 5

ELECTRICAL INSTRUCTIONS

CAUTION: Always disconnect the battery while working with the vehicle's electrical system.

- Mount the relay base to the truck in a protective location. **NOTE:** If there is an open slot in the truck's relay panel and you wish to wire your relay through this panel you will not need the supplied relay base.
- Make all wiring connections to fuse, relay, and truck as shown in Figure 6, crimping Push-On Connectors to wires and mounting them in the supplied relay base. **NOTE:** Make sure the 12 VDC source is switched (turns off with the key)
- Make connections to the toggle switch from terminal 87a on the relay, and the blue wire from the solenoid valve.
- Ground the brown and striped green wires from the cable on the solenoid valve. **NOTE:** The striped green wire may also be left unconnected.
- Mount the toggle switch and toggle switch plate to the interior of the truck in a desired location. **NOTE:** Make sure that lift axle position correlates with "Raise"/"Lower" position on toggle switch plate (tab on toggle switch plate may need to be removed).
- When all electrical connections have been made, reconnect the battery, pressurize the system and tighten any fittings that are leaking.

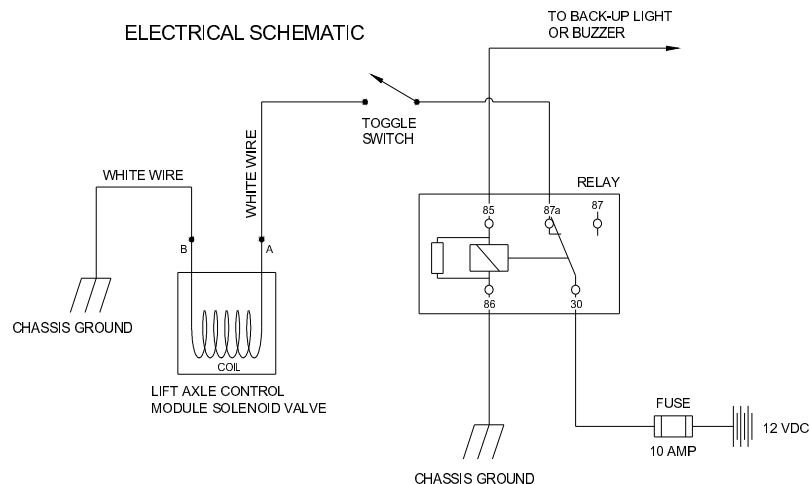

FIG. 6