

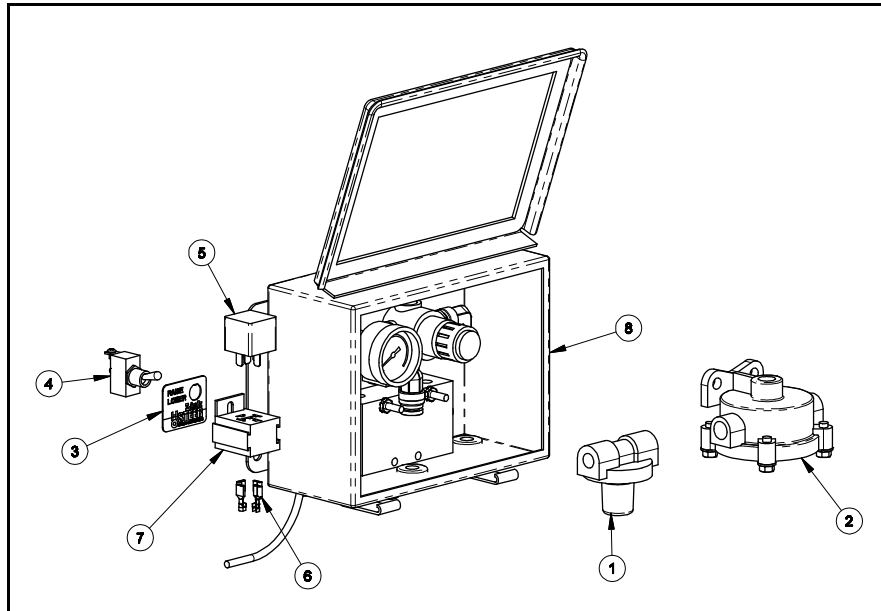

INSTALLATION INSTRUCTIONS

PARTS LIST

AIR CONTROL KIT (800A-0034)



ITEM	PART #	PART DESCRIPTION	QTY
1	1301-0084	VALVE-PRESSURE PROTECTION	1
2	1301-0503	VALVE-EXHAUST	1
3	1500-1318	PLATE-SWITCH, LIFT	1
4	1505-0350	SWITCH-TOGGLE, HI STEER	1
5	1505-0351	RELAY	1
6	1505-0353	CONNECTOR-PUSH-ON, FEMALE	4
7	1505-0354	RELAY BASE	1
8	800A0033	BOX-CONTROL, AIR	1

Link Mfg. Ltd.
223 15th St. N.E.
Sioux Center, IA USA
51250-2120

(712) 722-4874
Fax (712) 722-4876

**QUESTIONS?
CALL CUSTOMER
SERVICE
1-800-222-6283**

OPTIONAL: For quicker and easier installation an additional Installation Kit (Link Mfg. part # 800A-0014) provides a complete set of fasteners, connectors, airline and wire for use with this kit. For details call Link Mfg. Customer Service at 1-800-222-6283.

NOTES:

- 1) If you are not integrating the optional Link Mfg. Installation Kit: use 3/8" DOT airline for all plumbing between fittings; use brass DOT fittings for all plumbing connections; use 14-gage primary wire for all electrical connections.
- 2) Considerations should be made to route all wiring and airline in protective locations away from any moving parts.
- 3) Cable ties or other fastening devices may be required to secure airline, wire and/or fittings to truck/suspension.
- 4) Apply Permatex #807 or comparable anaerobic pipe thread sealant to fill three exterior pipe threads on brass fittings and tighten 1-1/2 revolutions beyond hand tight.
- 5) When solenoid is energized, lift axle is up.

IMPORTANT: When installing your kit use the instructions for the correct option as determined below:

OPTION 1: Kit will be installed on a steerable suspension.

OPTION 2: Kit will be installed on a non-steer suspension.

OPTION 1

PLUMBING INSTRUCTIONS

- A. Connect pressure protection valve directly to the air supply tank on the truck. **IMPORTANT:** Make sure direction of flow for the system matches flow indicator on the pressure protection valve.
- B. Mount the Sealed Air Control Box to the truck exterior in desired location for driver convenience, making sure that air controls are easily accessible.
- C. Securely mount the Exhaust Valve to the suspension cross-member.
- D. Route all airline to your suspension using plumbing schematic in Figures 1 and 2. **IMPORTANT:** Make sure direction of flow for the system matches flow indicator on the regulator.
- E. Secure any loose components to the truck.

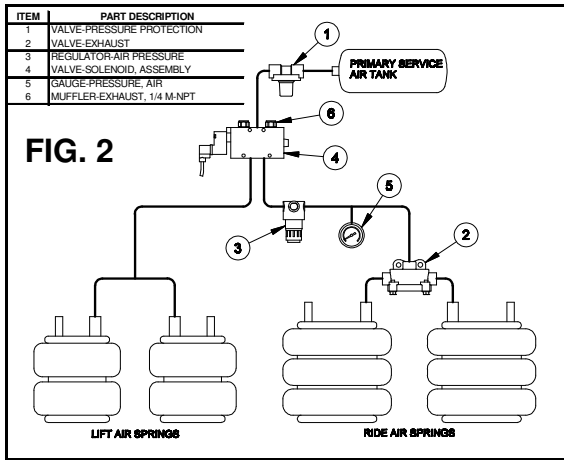
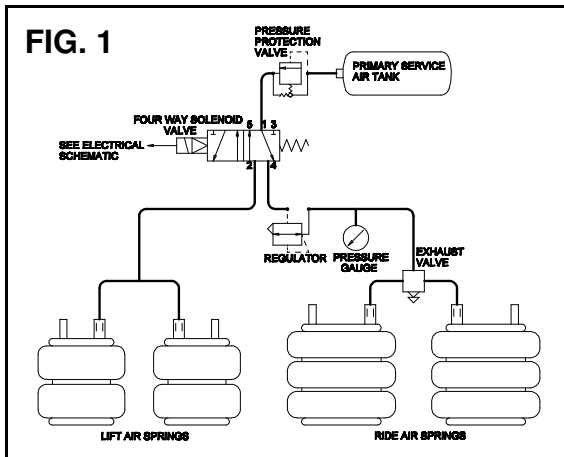

ELECTRICAL INSTRUCTIONS

CAUTION: Always disconnect the battery while working with the vehicle's electrical system.

- A. Mount the relay base to the truck in a protective location. **NOTE:** If there is an open slot in the truck's relay panel and you wish to wire your relay through this panel you will not need the supplied relay base.
- B. Make all wiring connections to fuse, relay, and truck as shown in Figure 3, crimping Push-On Connectors to wires and mounting them in the supplied relay base.
- C. Make connections to the toggle switch from terminal 87, and terminal 30 on the relay. Also connect the blue wire from the solenoid valve to the toggle switch. **NOTE:** Make sure that lift axle position correlates with "Raise"/"Lower" position on toggle switch plate (tab on toggle switch plate may need to be removed).
- D. Ground the brown and striped green wires from the cable on the solenoid valve. **NOTE:** The striped green wire may be also be left unconnected.
- E. Mount the toggle switch and toggle switch plate to the interior of the truck in a desired location. **NOTE:** Make sure that lift axle position correlates with "Raise"/"Lower" position on toggle switch plate (tab on toggle switch plate may need to be removed).
- F. When all electrical connections have been made, reconnect the battery, pressurize the system and tighten any fittings that are leaking.

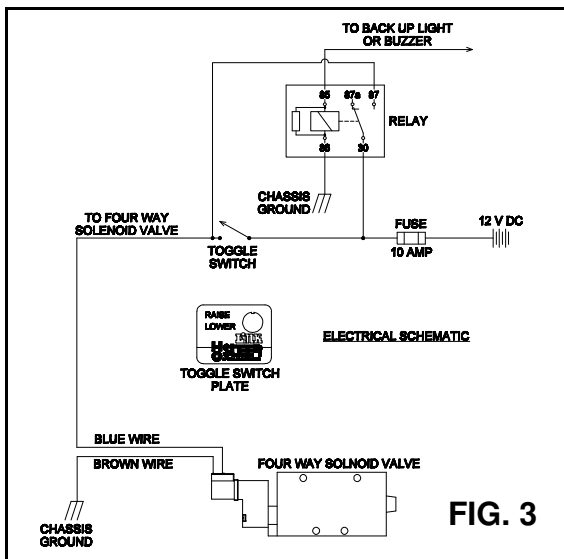

OPTION 2

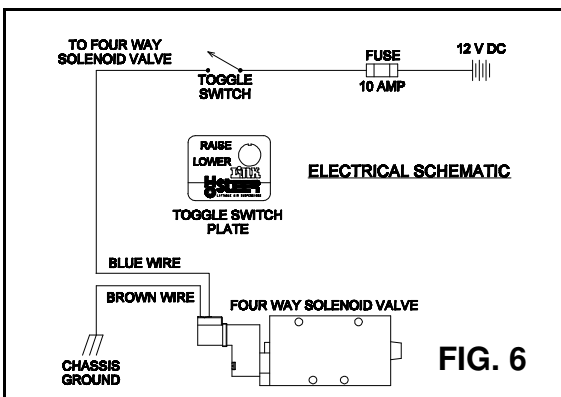
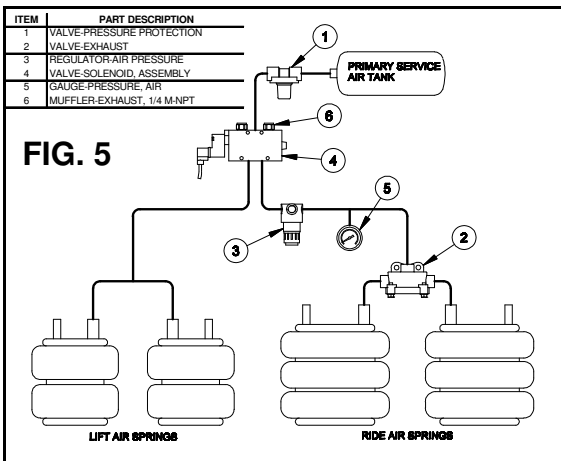
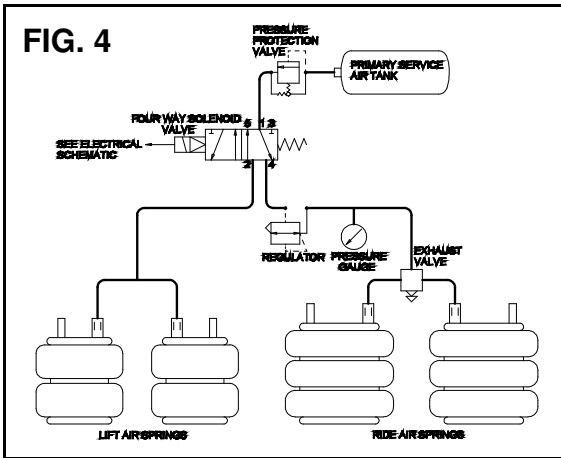

PLUMBING INSTRUCTIONS

- Connect pressure protection valve directly to the air supply tank on the truck. **IMPORTANT:** Make sure direction of flow for the system matches flow indicator on the pressure protection valve.
- Mount the Sealed Air Control Box to the truck exterior in desired location for driver convenience, making sure that the air controls are easily accessible.
- Securely mount the Exhaust Valve to the suspension cross-member.
- Route all airline to your suspension using plumbing schematic in Figures 4 and 5. **IMPORTANT:** Make sure direction of flow for the system matches flow indicator on the regulator.
- Secure any loose components to the truck.

ELECTRICAL INSTRUCTIONS

CAUTION: Always disconnect the battery while working with the vehicle's electrical system.

- Make all wiring connections to fuse, truck, and toggle switch as shown in Figure 6. **IMPORTANT:** Make sure that the toggle switch is wired so that the lift axle is down when the switch is on.
- Ground the brown and striped green wires from the cable on the solenoid valve. **NOTE:** The striped green wire may be also be left unconnected.
- Mount the toggle switch and toggle switch plate to the interior of the truck in a desired location. **NOTE:** Make sure that lift axle position correlates with "Raise"/"Lower" position on toggle switch plate (tab on toggle switch plate may need to be removed).
- When all electrical connections have been made, reconnect the battery, pressurize the system and tighten any fittings that are leaking.