

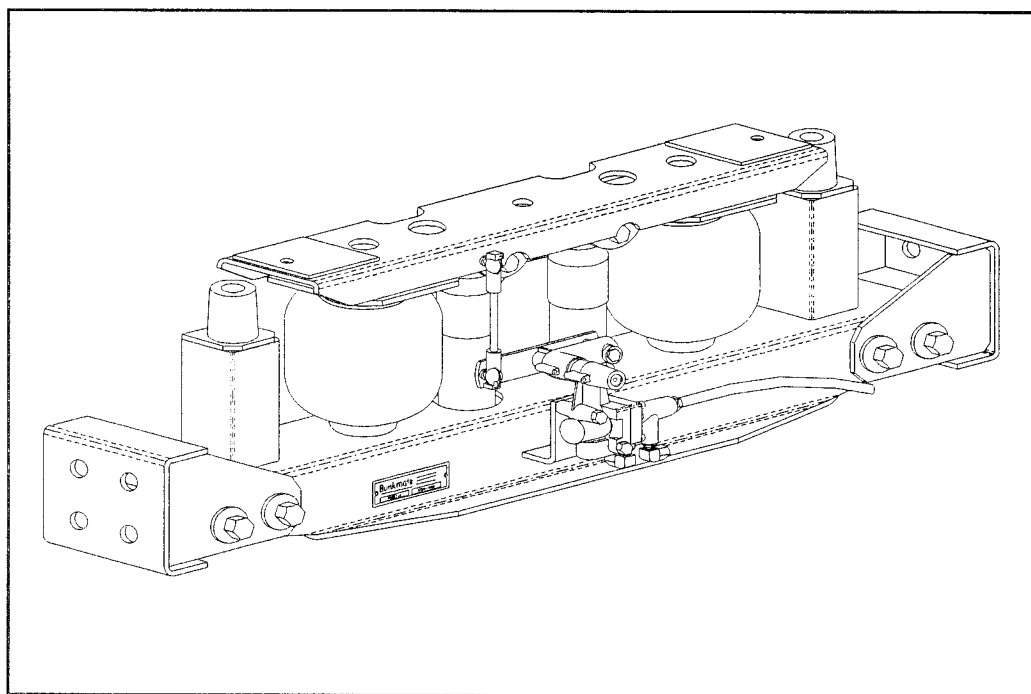

INSTALLATION INSTRUCTIONS PARTS LIST

PBS63-A (2901A000)



Link Mfg. Ltd.
223 15th St. N.E.
Sioux Center, IA USA
51250-2120

(712) 722-4874
Fax (712) 722-4876

**QUESTIONS?
CALL CUSTOMER
SERVICE
1-800-222-6283**

The **BUNKMATE MODEL PBS63-A** fits most **1978 and newer Peterbilt 63" Sleepers**. It replaces the original rear sleeper mount, Peterbilt Part No. 29-00626 (3" tall) or 29-00829 (5" tall).

UNIT WEIGHT: 52.4 LB.

NET WEIGHT ADDED: 30.4 LB.

BUNKMATE MODEL PBS63-A

Review the Parts List on page 3 to become familiar with the different components of the BUNKMATE.

IMPORTANT: Due to many chassis variables caused by installation of special equipment or options, the fit of the PBS63-A BUNKMATE may be affected and should be evaluated before beginning installation.

IMPORTANT: Installation of the BUNKMATE system will cause the sleeper to move freely. Before starting installation, check clearances between the sleeper and any objects the sleeper may contact when it moves (1 1/2 inches of clearance should be sufficient).

A. Remove the rear sleeper mount bolt. Securely prop up the sleeper. Remove the original sleeper mounting support channel and support channel mount brackets. (Fig.1)

B. Remove the Mount Brackets from each end of the BUNKMATE. (No. 3 from the parts list on page 3).

C. Using the 5/8" bolt, supplied by Link Mfg., loosely mount the Unit Top to the sleeper. Making sure that the unit is parallel with the back of the sleeper, mark the location of the 3/8" mount holes in each end of the unit onto the sleeper frame. Remove the BUNKMATE. Drill two 3/8" holes at the positions marked.

D. Loosely bolt the Mount Brackets onto the frame in the correct position for the truck model. (Fig. 2)

E. Slide the BUNKMATE into position (Fig. 3), loosely fasten the Unit Top to the sleeper using the mounting bolts supplied by Link Mfg. (No.'s 18, 19, 20, 28, 29, 30, and 31 on parts list), and loosely bolt the Unit Bottom to the Mount Brackets.

F. Securely fasten the Unit Top to the sleeper. Tighten the Mount Bracket Bolts. Center the Unit Bottom under the Unit Top. **SECURELY TIGHTEN ALL FASTENERS.** Lower the sleeper completely.

G. See page 2 for plumbing instructions and height adjustments.

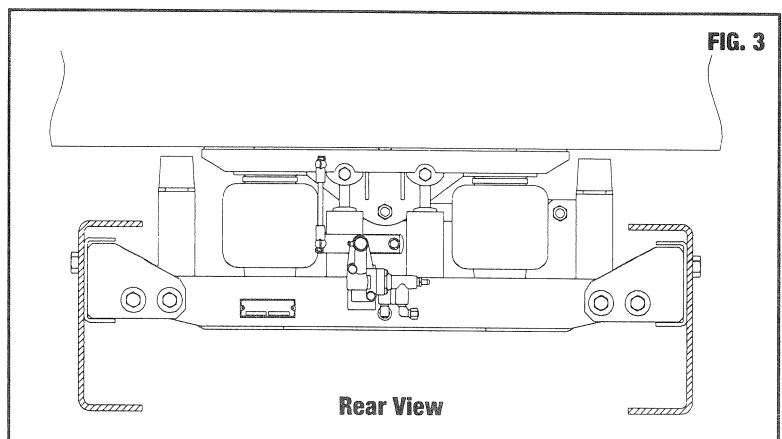
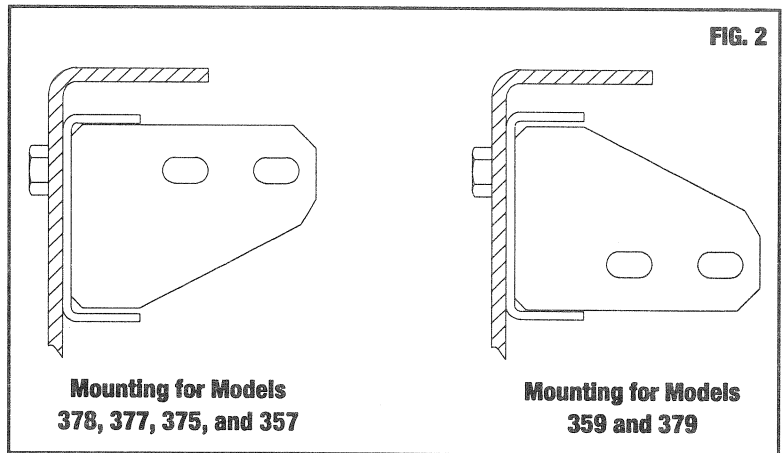
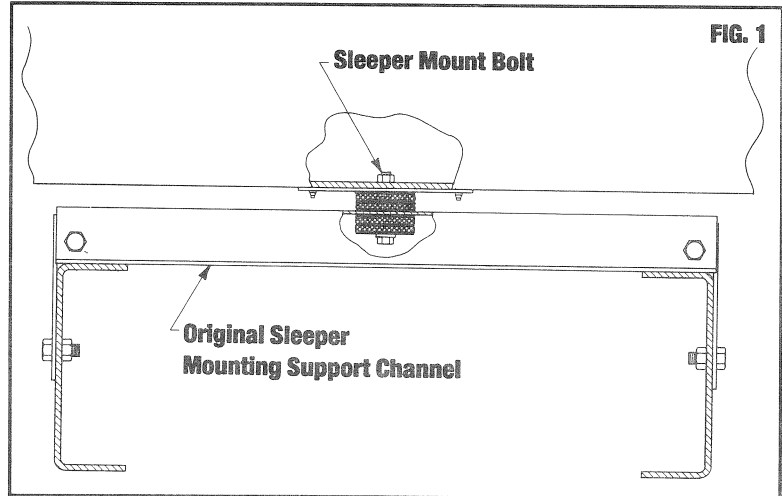

PLUMBING INSTRUCTIONS

WARNING: FOR SAFETY PURPOSES THE BUNKMATE MUST BE SUPPLIED FROM A PRESSURE PROTECTED CIRCUIT. IN THE EVENT OF AN AIR LEAK IN THE CAB SUSPENSION, FAILURE TO PROVIDE A PRESSURE PROTECTED CIRCUIT MAY CAUSE LOSS OF AIR PRESSURE TO VITAL SYSTEMS ON THE VEHICLE.

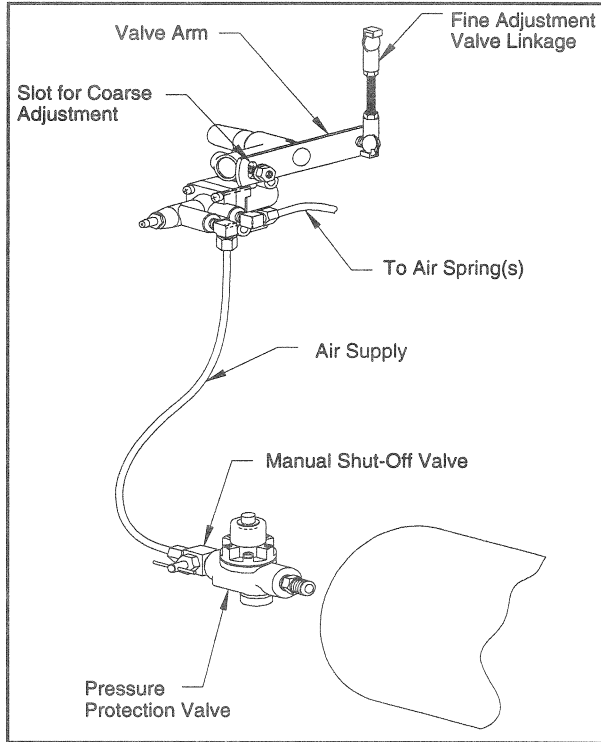

WARNING: LOSS OR APPLICATION OF AIR PRESSURE TO BUNKMATE WILL CAUSE SUDDEN MOVEMENT OF THE CAB. PRIOR TO INSTALLING OR PERFORMING ANY MAINTENANCE, BLOCK UP THE CABMATE TO PREVENT THE POSSIBILITY OF INJURY.

WARNING: CONNECT THE BUNKMATE DIRECTLY TO THE MAIN AIR TANK. YOU WILL NEED AN AIR PRESSURE PROTECTION VALVE IN THE LINE. (INCLUDED IN THE PRESSURE PROTECTION KIT, LINK MFG. PART NO. 1350-0000). DO NOT USE AN AIR PRESSURE REGULATOR!

A. With the tank at 0 p.s.i., remove the existing plug or fitting from the desired port.

B. Apply joint compound to the fittings and install the pressure protection kit. **DO NOT USE TEFLON TAPE.** Be sure that the arrows on the valve are pointing in the direction of air flow and the vent hole is pointed down. **NOTE:** Additional fittings/reducers may be required to attach the hex nipple to the main air tank.

C. Run the 1/4" airline from the shut-off valve to the BUNKMATE. Be sure that the airline has enough clearance so that there are no pinch points that may restrict or cut the airline. Secure the airline using the cable ties supplied by Link Mfg.

D. Tighten all plumbing fittings. Then, with the system at operating pressure (90 to 110 p.s.i.), open the Manual Shut-off Valve to supply air to the BUNKMATE. (There is an approximate 5 second delay in the Height Control Valve.) Check the system for air leaks.

E. Check for proper operation of the height control valve. Disconnect the

valve linkage from the valve arm. Push the valve arm down 45° and hold for 5 seconds, air should be flowing into the air spring(s). Return the valve arm to the neutral position. Push the valve arm up 45° and hold for 5 seconds, air should be evacuating from the air spring(s). Return the valve arm to the neutral position; no air should flow. Reconnect the valve linkage to the valve arm.

HEIGHT ADJUSTMENTS

Measure the design height of the air spring(s). The height should be 5 1/2 inches ± 1/16. To change the height, disconnect one end of the valve linkage and adjust accordingly. Tighten the lock nuts on the valve linkage. The valve arm has a slot which will allow for coarse adjustment also. (See diagram above.)

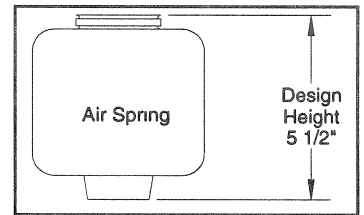

MAINTENANCE

BUNKMATES need no lubrication and little maintenance. The following components should be checked at the time the truck is being serviced. However, immediate corrective action should be taken if a serious malfunction occurs.

COMPONENT	POSSIBLE PROBLEM	CORRECTIVE ACTION	TORQUE
Airlines	Air leaks	Replace airline	Compression Nut Hand Tight + 1 Turn
Fittings	Air leaks	Remove fitting and apply fresh joint compound. Reinstall fitting, but Do Not Overtighten. Do not use Teflon tape.	AIR SPRING MATERIAL Metal Plastic 15 Hand Tight Ft. Lbs. + 1 Turn
Air Springs	A. Improper height B. Air leakage	A. Adjust valve linkage to maintain proper air spring height. B. Replace air spring.	Size Metal Plastic 3/8 25 Ft. Lbs. 4 Ft. Lbs. 1/2 28 Ft. Lbs. 10 Ft. Lbs. 3/4 30 Ft. Lbs. 10 Ft. Lbs.
Height Control Valve*	A. Air leakage from joint between valve halves. B. Air springs will not inflate when weight is added to the cab. C. Air springs will not deflate when weight is removed from the cab.	A. Tighten 4 Phillips head screws. B. Replace valve. C. Replace valve.	30 In. Lbs. 1/4 Mount Fasteners 10 Ft. Lbs.
Shock Absorber	Insufficient dampening effect	Replace shocks	45 Ft. Lbs.
Lateral Control Rod	A. Loose nuts on lateral control rod bolts B. Worn bushings	A. Tighten securely to clamp the inner sleeve. B. Replace lateral control rod.	40 Ft. Lbs.

IMPORTANT: Periodically check the tightness of all fasteners.

* **Note:** If you attempt to disassemble or adjust fittings on the height control valve, it will void your warranty. Contact Link Manufacturing for assistance.

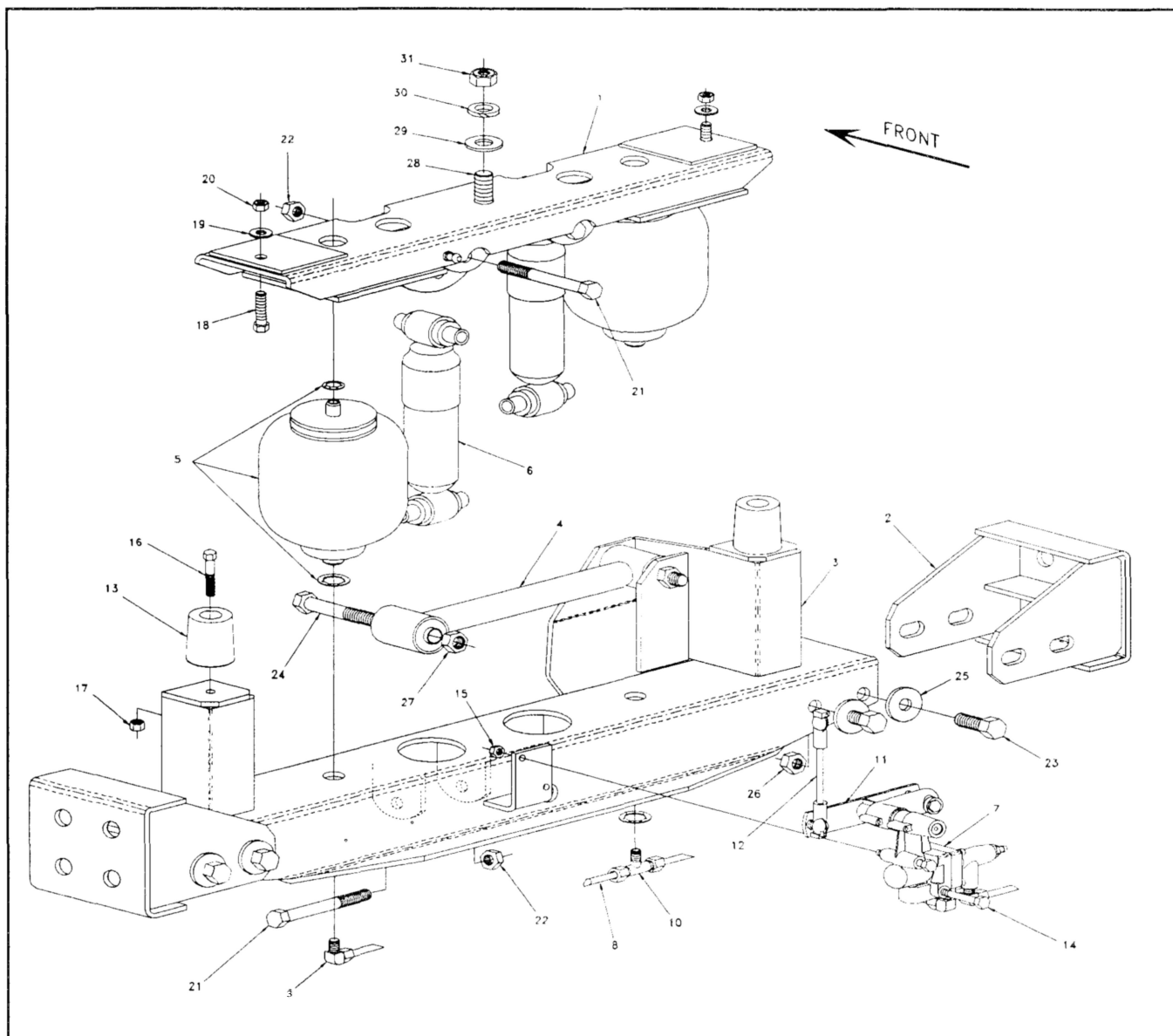

BUNKMATE® MODEL PBS63-A

PARTS LIST

ITEM#	PART#	PART DESCRIPTION	QTY.	ITEM #	PART#	PART DESCRIPTION	QTY.
1	29011000	Unit Top	1	17	14761000	5/16 UNC Lock Nut	2
2	29012000	Unit Bottom	1	18	14011210	3/8 X 1 1/4 UNC Bolt	2
3	29013000	Mount Brackets	2	19	14871200	3/8 Flat Washer	2
4	29932013	Lateral Control Rod	1	20	14761200	3/8 Lock Nut	2
5	1102A030	Air Spring	2	21	14031428	7/16X3 1/2 UNF Bolt	4
6	12011044	Shock Absorber	2	22	14771400	7/16 UNF Lock Nut	4
7	13010012	Height Control Valve	1	23	14011608	1/2X1 UNC Bolt	8
8	13020090	1/4 Airline	1.2'	24	14041624	1/2 X 3 UNF Bolt	2
9	H13980	Male Elbow (1/8 NPT)	1	25	14871600	1/2 Flat Washer	8
10	13021143	Male Branch Tee (1/8 NPT)	1	26	14761600	1/2 UNC Lock Nut	8
11	29900700	Valve Arm	1	27	14771601	1/2 UNF Lock Nut	2
12	15000248	Valve Linkage	1	28	14012012	5/8 X 1 1/2 UNC Bolt	1
13	15000070	Rubber Bumper	2	29	14872000	5/8 Flat Washer	1
14	14010816	1/4X2 UNC Bolt	2	30	14852000	5/8 Lock Washer	1
15	14760800	1/4 UNC Lock Nut	2	31	14702000	5/8 UNC Nut	1
16	14011012	5/16X1 1/2 UNC Bolt	2	Not Shown	13500000	Pressure Protection Kit	1