

Cabmate[®]
Cab Suspension

LINK[®]

Link Mfg. Ltd.
223 15th St. N.E.
Sioux Center, IA USA
51250-2120
www.linkmfg.com

**QUESTIONS?
CALL CUSTOMER
SERVICE
1-800-222-6283**

OWNER'S GUIDE

Autocar Cab Suspension

DC-64

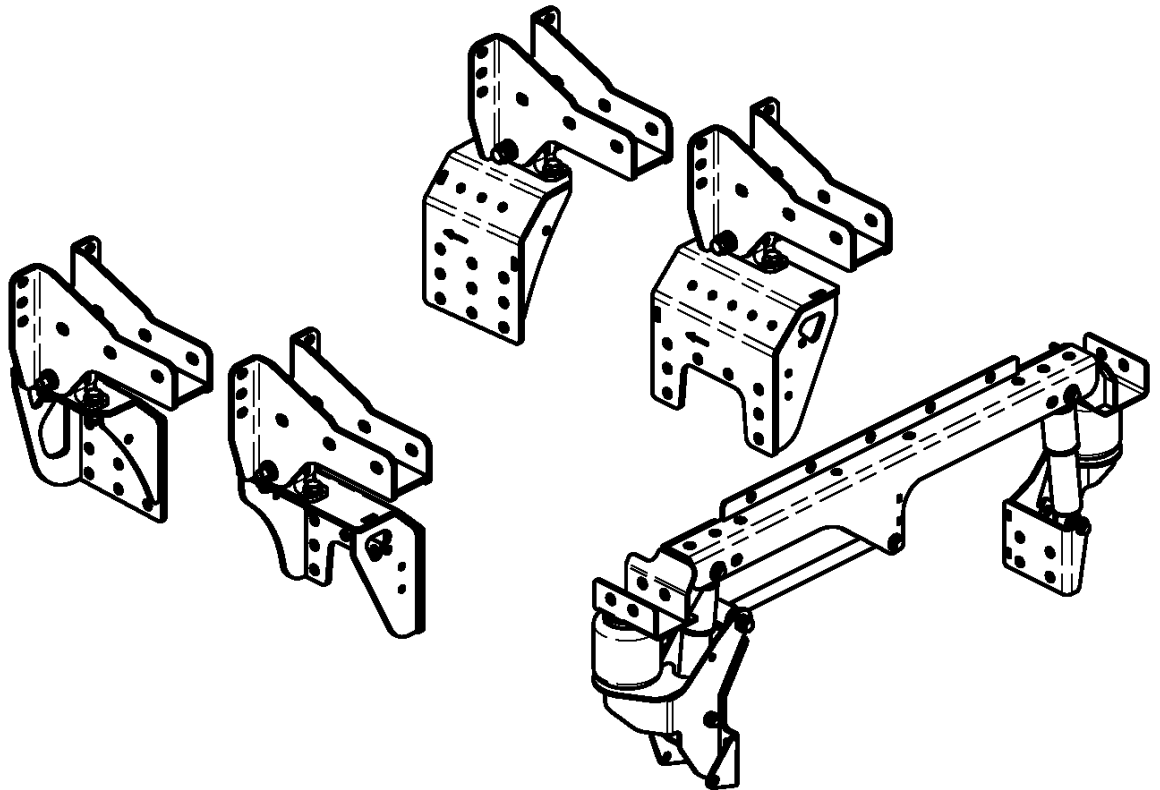

1. PLUMBING INSTRUCTIONS

WARNING: FOR SAFETY PURPOSES THE CABMATE MUST BE SUPPLIED FROM A PRESSURE PROTECTED CIRCUIT. IN THE EVENT OF AN AIR LEAK IN THE CAB SUSPENSION, FAILURE TO PROVIDE A PRESSURE PROTECTED CIRCUIT MAY CAUSE LOSS OF AIR PRESSURE TO VITAL SYSTEMS ON THE VEHICLE.

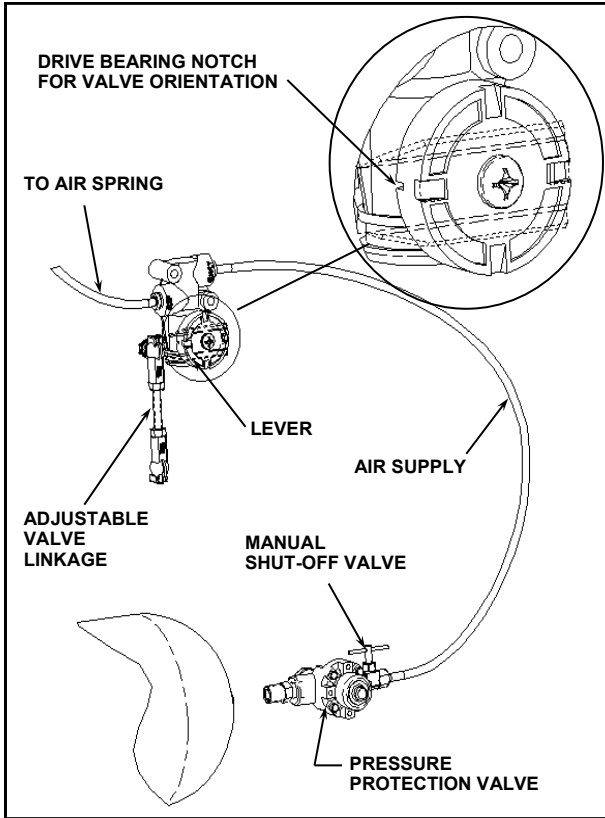

WARNING: LOSS OR APPLICATION OF AIR PRESSURE TO CABMATE WILL CAUSE SUDDEN MOVEMENT OF THE CAB. PRIOR TO INSTALLING OR PERFORMING MAINTENANCE, BLOCK UP THE CABMATE TO PREVENT THE POSSIBILITY OF INJURY.

WARNING: CONNECT THE CABMATE DIRECTLY TO THE MAIN AIR TANK. YOU WILL NEED AN AIR PRESSURE PROTECTION VALVE IN THE LINE. (INCLUDED IN THE PRESSURE PROTECTION KIT. LINK MFG. PART NO. 13500000). DO NOT USE AN AIR PRESSURE REGULATOR!

- A. With the tank at 0 p.s.i., remove the existing plug or fitting from the desired port.
- B. Apply joint compound to the fittings and install the pressure protection kit. DO NOT USE TEFLON TAPE. Be sure that the arrows on the valve are pointing in the direction of air flow and the vent hole is pointed down. NOTE: Additional fittings/reducers may be required to attach the hex nipple to the main air tank.
- C. Run the 1/4" airline from the shut-off valve to the CABMATE. Be sure that the airline has enough clearance so that there are no pinch points that may restrict or cut the airline. Secure the airline using the cable ties supplied by Link Mfg.
- D. Tighten all plumbing fittings. Then, with the system at operating pressure (90 to 110 p.s.i), open the Manual Shut-off Valve to supply air to the CABMATE. Check the system for air leaks.
- E. Check for proper operation of the height control valve. Disconnect the valve linkage from the lever. Push the lever down 45°, air should flow into the air spring(s). Return the lever to the neutral position. Push the lever up 45°, air should exhaust from the air spring(s). Return the lever to the neutral position; no air should flow. Reconnect the valve linkage to the lever.

HEIGHT ADJUSTMENTS

Measure the design height of the air spring(s). The height should be 5.43 inches. To change the height, disconnect one end of the valve linkage and adjust accordingly. Tighten the lock nuts on the valve linkage.

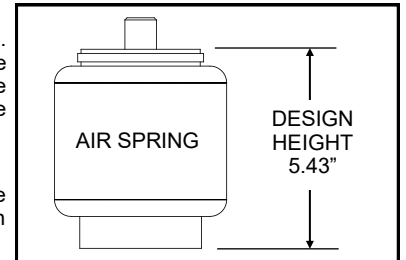

MAINTENANCE

CABMATES need no lubrication and little maintenance. The following components should be checked at the time the truck is being serviced. However, immediate corrective action should be taken if a serious malfunction occurs.

COMPONENT	POSSIBLE PROBLEM	CORRECTIVE ACTION
Airlines	Air leaks	Replace airline
Fittings	Air leaks	Replace fittings.
Air Springs	A. Improper height B. Air leakage	A. Adjust valve linkage to maintain proper air spring height. B. Replace air spring.
Height Control Valve	Air spring(s) will not inflate when weight is added to the cab; OR Air spring(s) will not deflate when weight is removed from the cab.	A. Inspect valve to insure drive bearing notch is located on "SUSP" port side of valve. If not, loosen lever screw (but do not remove completely) and pull lever loose from drive bearing, rotate drive bearing until the bearing notch is in the correct position and resecure lever by tightening lever screw. B. Replace Valve
Shock Absorber	Insufficient dampening effect	Replace shocks
Lateral Control Rod	A. Loose nuts on lateral control rod bolts B. Worn bushings.	A. Tighten securely to clamp the inner sleeve. B. Replace lateral control rod.
Front Mounts	Worn bushings.	Replace front mount bushing assembly.

IMPORTANT: Periodically check the tightness of all fasteners.

2. **WARRANTY** - Refer to our warranty for Link Cabmate Suspensions by going to our website at www.linkmfg.com

SERVICE PARTS AND SERVICE KITS:

27562005 (A6600072-001)	27562015 (A6600079-001)
27562007 (A6600053-001)	27562016 (A6600080-001)
27562008 (A6600052-001)	27562017 (A6600078-001)
27562009 (A6600041-001)	27562019 (A6600083-001)
27562010 (A6600042-001)	27562020 (A6600087-001)
27562011 (A6600050-001)	27562021 (A6600084-001)
27562012 (A6600073-001)	27562022 (A6600084-002)
27562013 (A6600075-001)	27562023 (A6600086-001)

SERVICE ITEMS FOR AUTOCAR CAB SUSPENSION	
ITEM NUMBER	DESCRIPTION
4CM00020	SERVICE KIT - BRACKET, REAR FRAME, LH
4CM00021	SERVICE KIT - BRACKET, REAR FRAME, RH
4CM00022	SERVICE KIT - AIR SPRING
4CM00023	SERVICE KIT - SHOCK ABSORBERS
4CM00024	SERVICE KIT - LATERAL CONTROL ROD
4CM00025	SERVICE KIT - BRACKET, FRONT FRAME, LH
4CM00026	SERVICE KIT - BRACKET, FRONT FRAME, RH
4CM00027	SERVICE KIT - BRACKET, FRONT CAB
4CM00028	SERVICE KIT - MOUNT, FRONT CAB
4CM00029	SERVICE KIT - VALVE AND LINKAGE
4CM00030	SERVICE KIT - BRACKETS, REAR CAB MOUNT, RH
4CM00031	SERVICE KIT - BRACKETS, REAR CAB MOUNT, LH
4CM00032	SERVICE KIT - PIVOT BALL
4CM00033	SERVICE KIT - BRACKETS, REAR CAB MOUNT
4CM00232	SERVICE KIT - BRACKET, FRONT FRAME, LH
4CM00233	SERVICE KIT - BRACKET, FRONT FRAME, RH

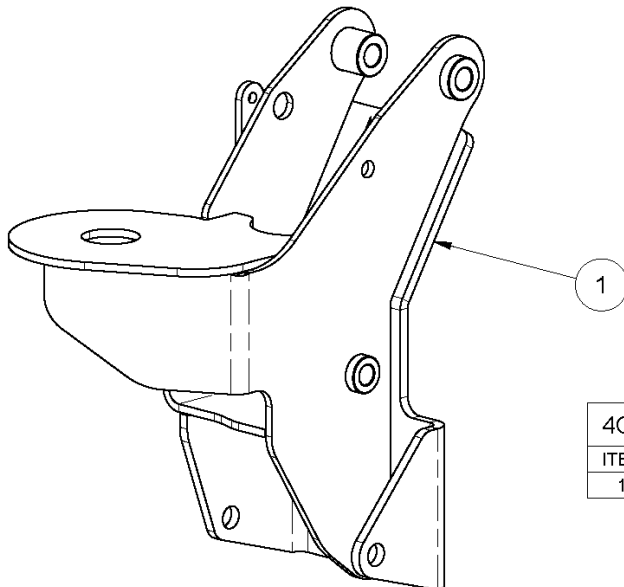

4CM00020 - SERVICE KIT – BRACKET, REAR FRAME, LH		
ITEM	DESCRIPTION	QTY
1	BRACKET-MOUNT, FRAME, LH	1

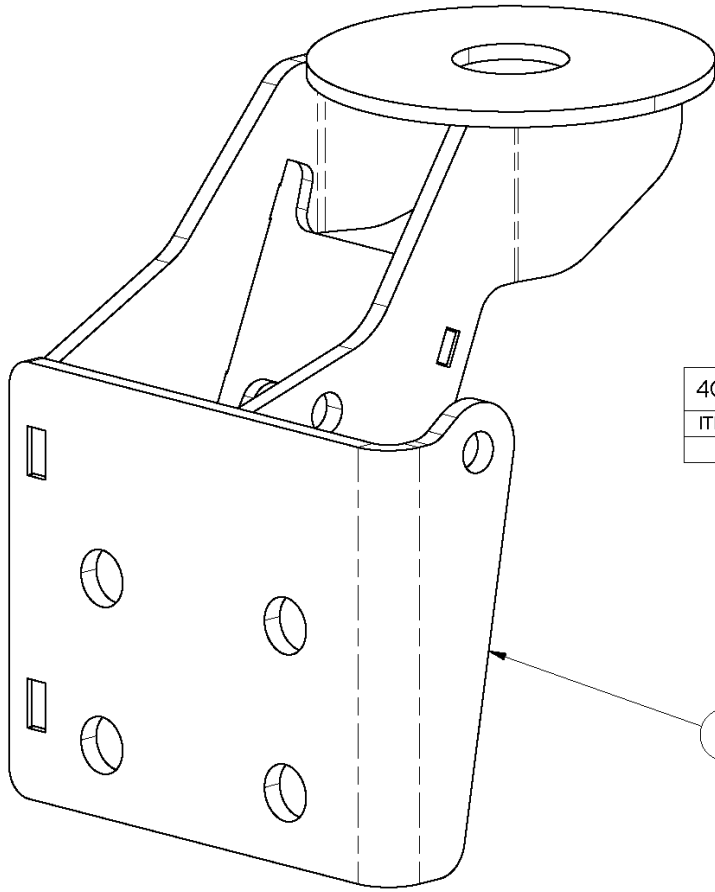

4CM00021 - SERVICE KIT – BRACKET, REAR FRAME, RH		
ITEM	DESCRIPTION	QTY
1	BRACKET-MOUNT, FRAME, RH	1

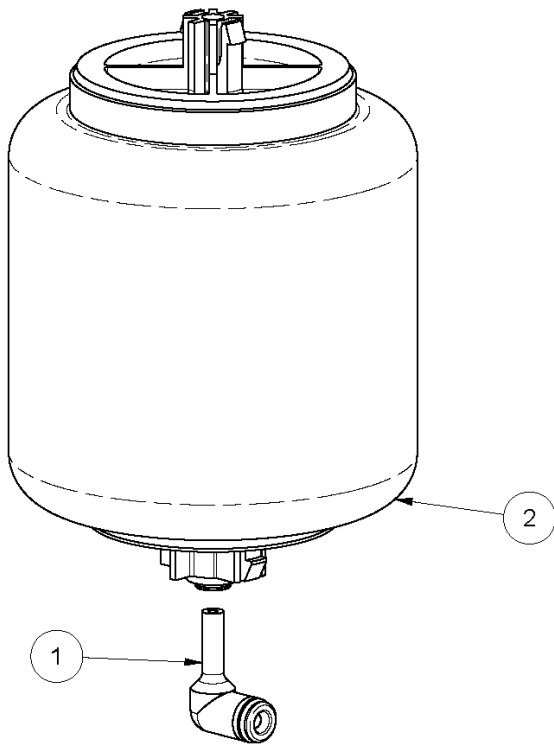

4CM00022 - SERVICE KIT – AIR SPRING		
ITEM	DESCRIPTION	QTY
1	ELBOW-PLUG-IN, 1/4"	1
2	SPRING-AIR	1

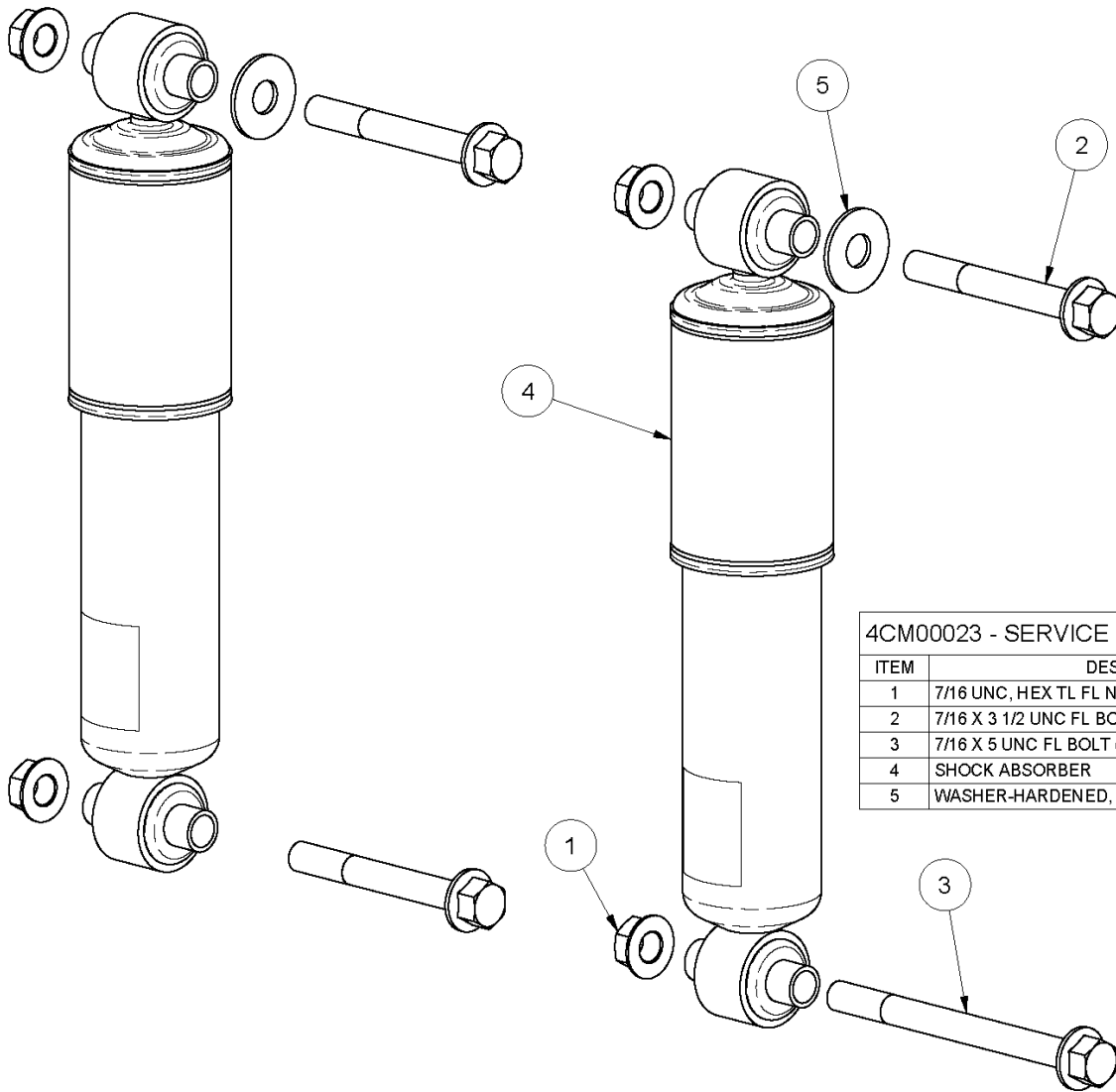

4CM00023 - SERVICE KIT – SHOCK ABSORBERS

ITEM	DESCRIPTION	QTY
1	7/16 UNC, HEX TL FL NUT, GR G, MAGNI 565-BLACK	4
2	7/16 X 3 1/2 UNC FL BOLT (GR 8) MAGNI 565-BLACK	3
3	7/16 X 5 UNC FL BOLT (GR 8) MAGNI 565-BLACK	1
4	SHOCK ABSORBER	2
5	WASHER-HARDENED, 0.4375, MAGNI 565, BLACK	2

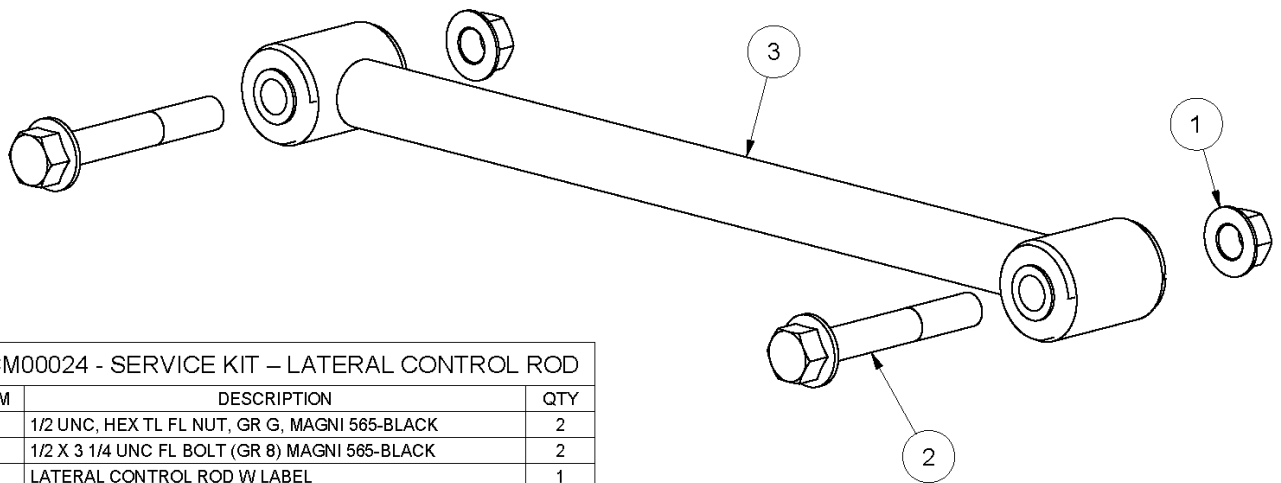

4CM00024 - SERVICE KIT – LATERAL CONTROL ROD

ITEM	DESCRIPTION	QTY
1	1/2 UNC, HEX TL FL NUT, GR G, MAGNI 565-BLACK	2
2	1/2 X 3 1/4 UNC FL BOLT (GR 8) MAGNI 565-BLACK	2
3	LATERAL CONTROL ROD W LABEL	1

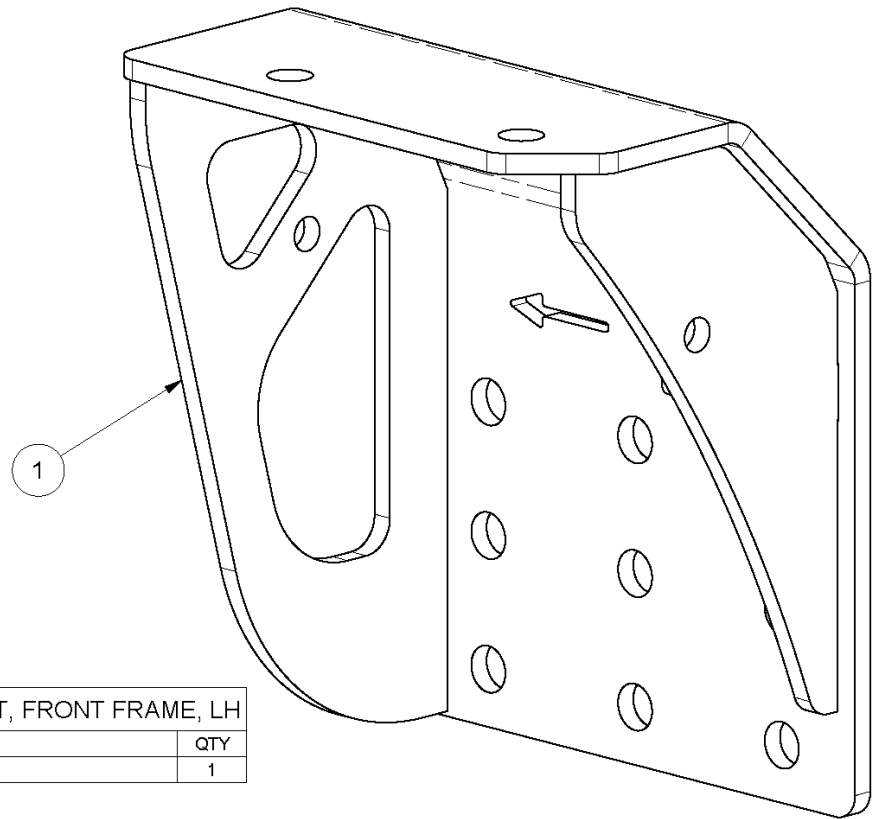

4CM00025 - SERVICE KIT – BRACKET, FRONT FRAME, LH

ITEM	DESCRIPTION	QTY
1	BRACKET-MOUNT, FRAME, LH, FRONT	1

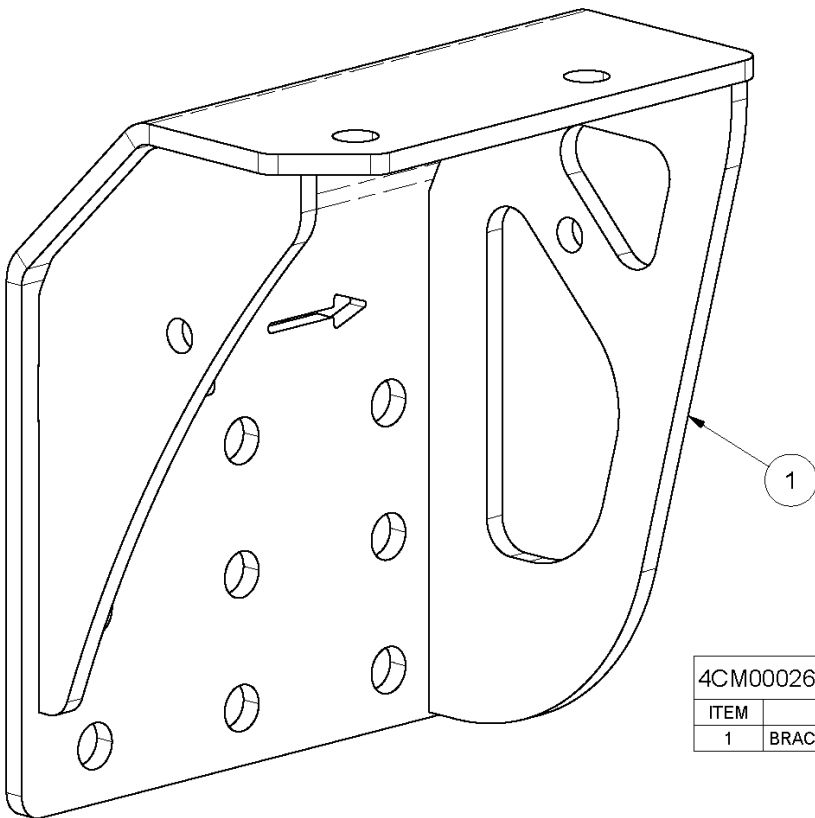

4CM00026 - SERVICE KIT – BRACKET, FRONT FRAME, RH

ITEM	DESCRIPTION	QTY
1	BRACKET-MOUNT, FRAME, RH, FRONT	1

4CM00027 - SERVICE KIT – BRACKET, FRONT CAB		
ITEM	DESCRIPTION	QTY
1	BRACKET-MOUNT, CAB, FRONT	1

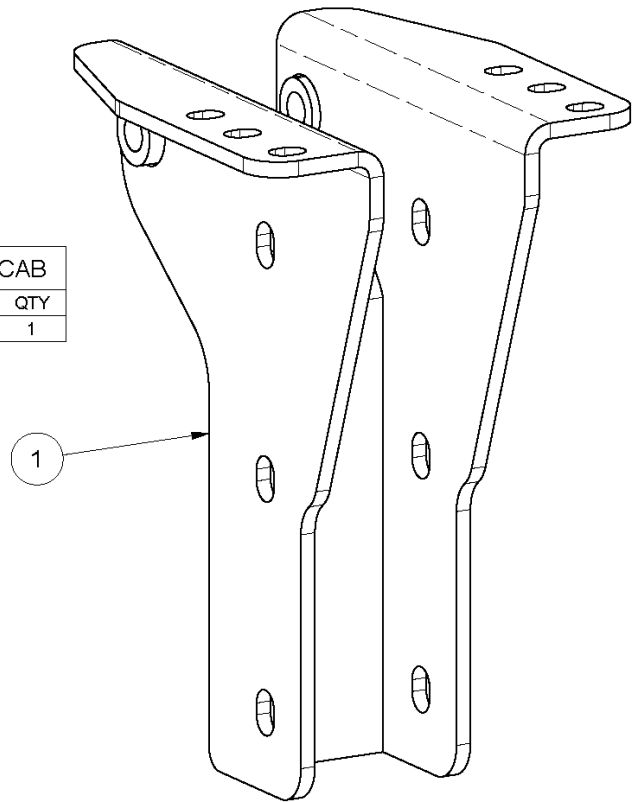

4CM00028 - SERVICE KIT – MOUNT, FRONT CAB		
ITEM	DESCRIPTION	QTY
1	5/8 UNC. HEX TL FL NUT, GR G, MAGNI 565-BLACK	6
2	5/8 X 2 UNC HEX CAP SCR (GR 8), MAGNI 565-BLACK	4
3	5/8 X 5 1/2 UNC FL BOLT (GR 8) MAGNI 565-BLACK	2
4	BUSHING-CAB, FRONT MOUNT	2
5	PLATE-DOUBLER	2
6	WASHER-HARDENED, 16MM, MAGNI 565, BLACK	4

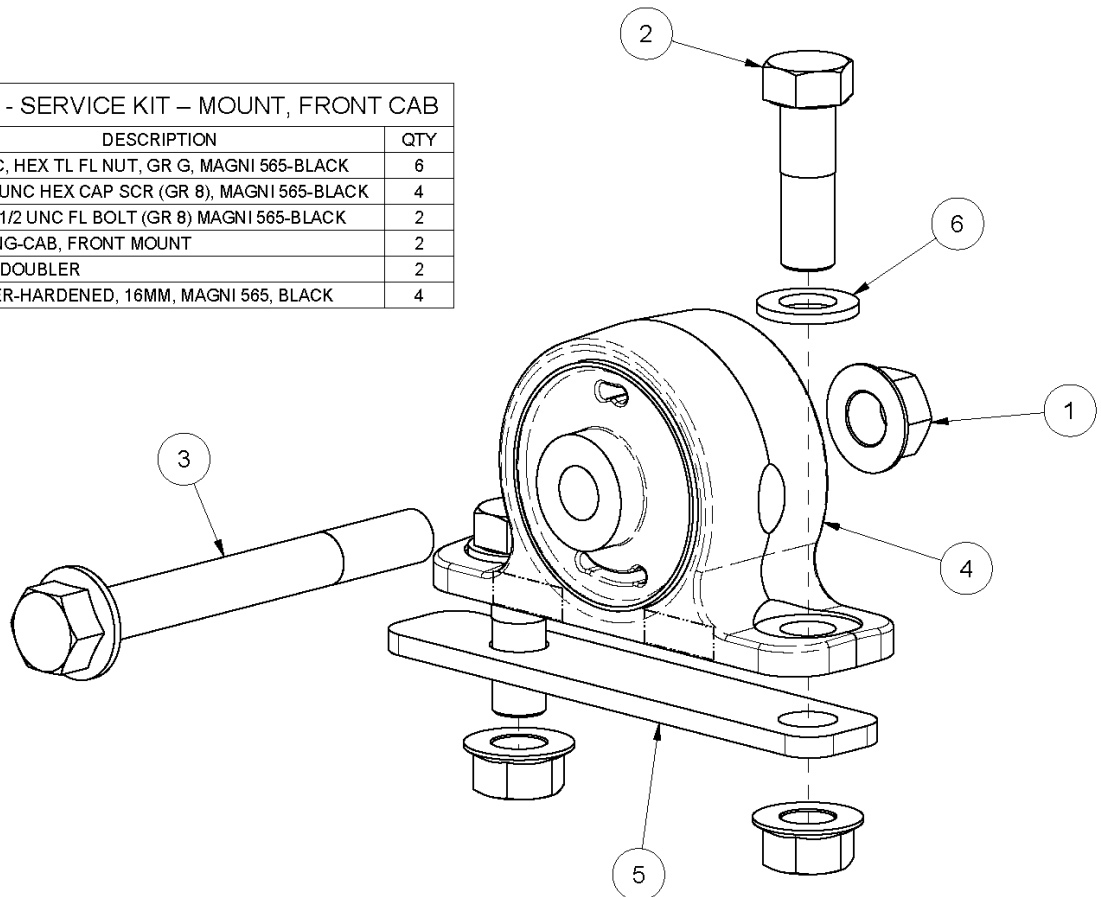

4CM00029 - SERVICE KIT – VALVE AND LINKAGE		
ITEM	DESCRIPTION	QTY
1	BRANCH TEE-PLUG-IN, 1/4"	1
2	HEIGHT CONTROL VALVE	1
3	HEX TOP LOCK NUT, M6 X 1.0, CLASS 8	1
4	LINKAGE-VALVE	1

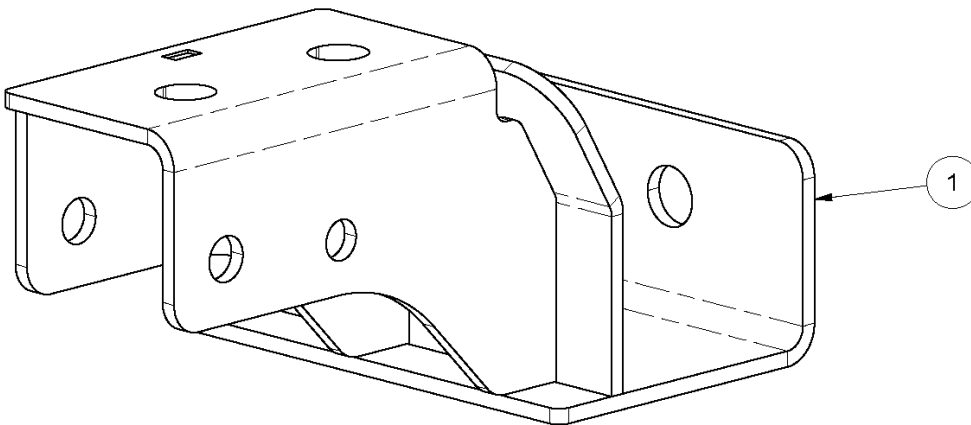
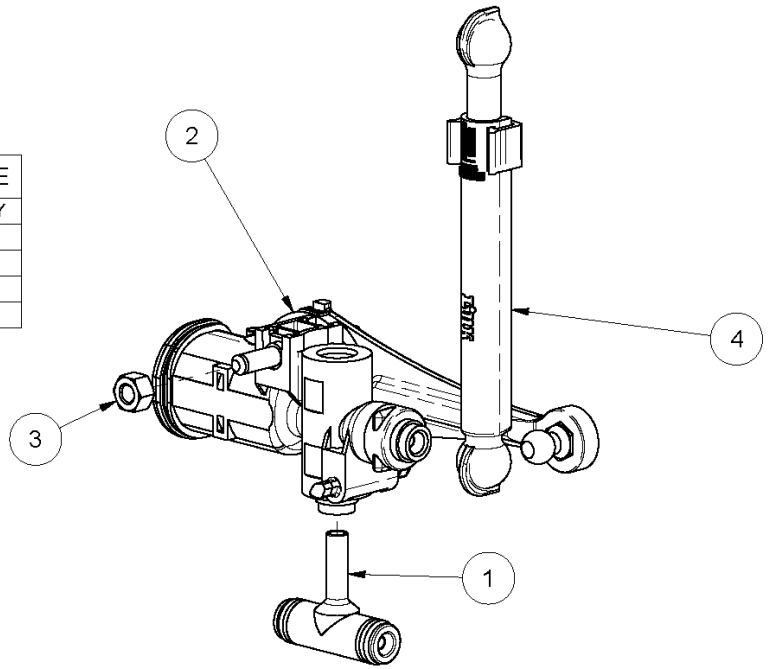

4CM00030 - SERVICE KIT – BRACKETS, REAR CAB MOUNT, RH		
ITEM	DESCRIPTION	QTY
1	BRACKET-MOUNT, CAB, AIRSPRING	1

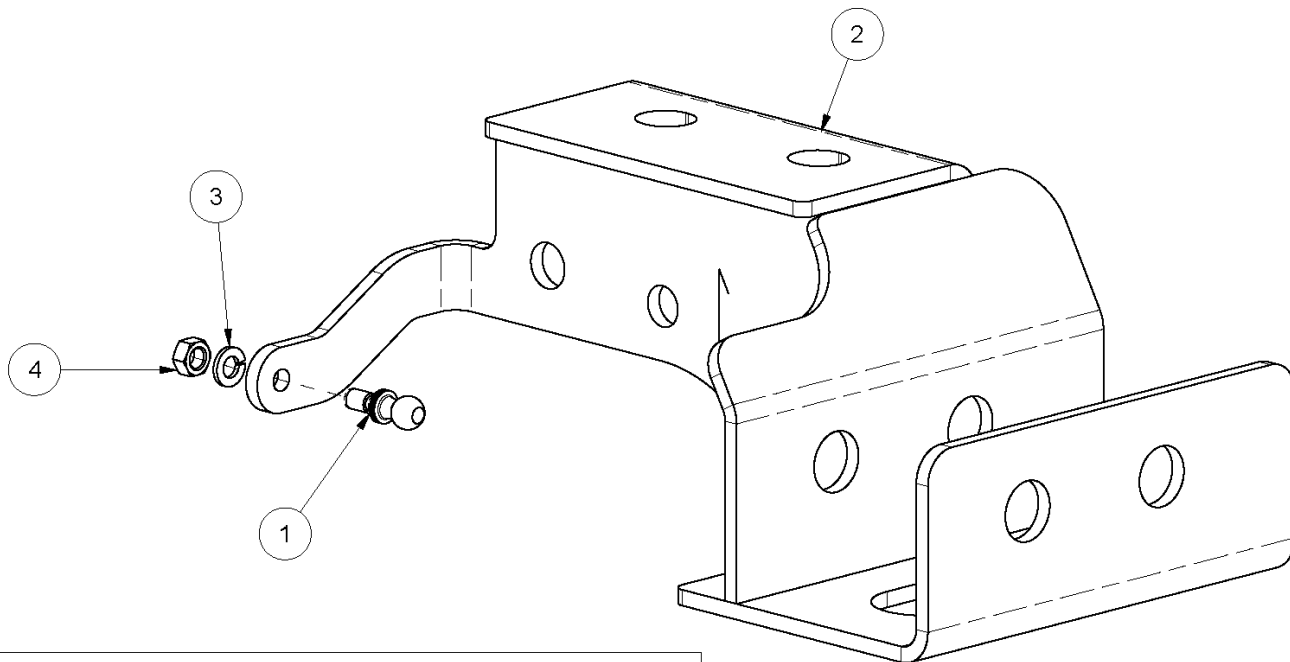

4CM00031 - SERVICE KIT – BRACKETS, REAR CAB MOUNT, LH

ITEM	DESCRIPTION	QTY
1	BALL-PIVOT, THREADED	1
2	BRACKET-MOUNT, CAB, AIRSPRING	1
3	HELICAL SPRING LOCK WASHER, MAGNI 501, M6	1
4	HEX NUT CLASS 8, MAGNI 501, M6 X 1	1

4CM00032 - SERVICE KIT – PIVOT BALL

ITEM	DESCRIPTION	QTY
1	BALL-PIVOT, THREADED	1
2	HELICAL SPRING LOCK WASHER, MAGNI 501, M6	1
3	HEX NUT CLASS 8, MAGNI 501, M6 X 1	1

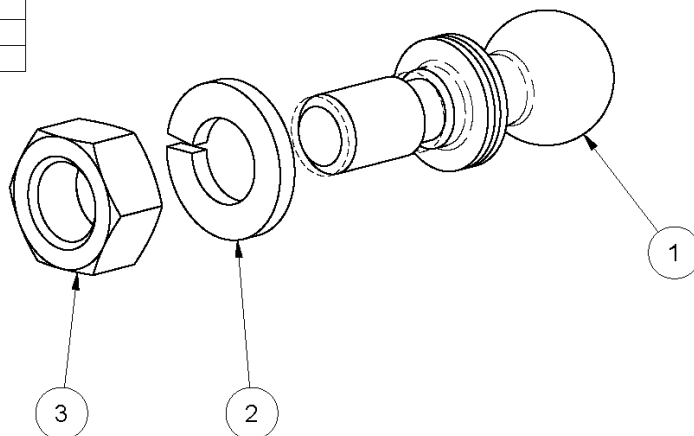

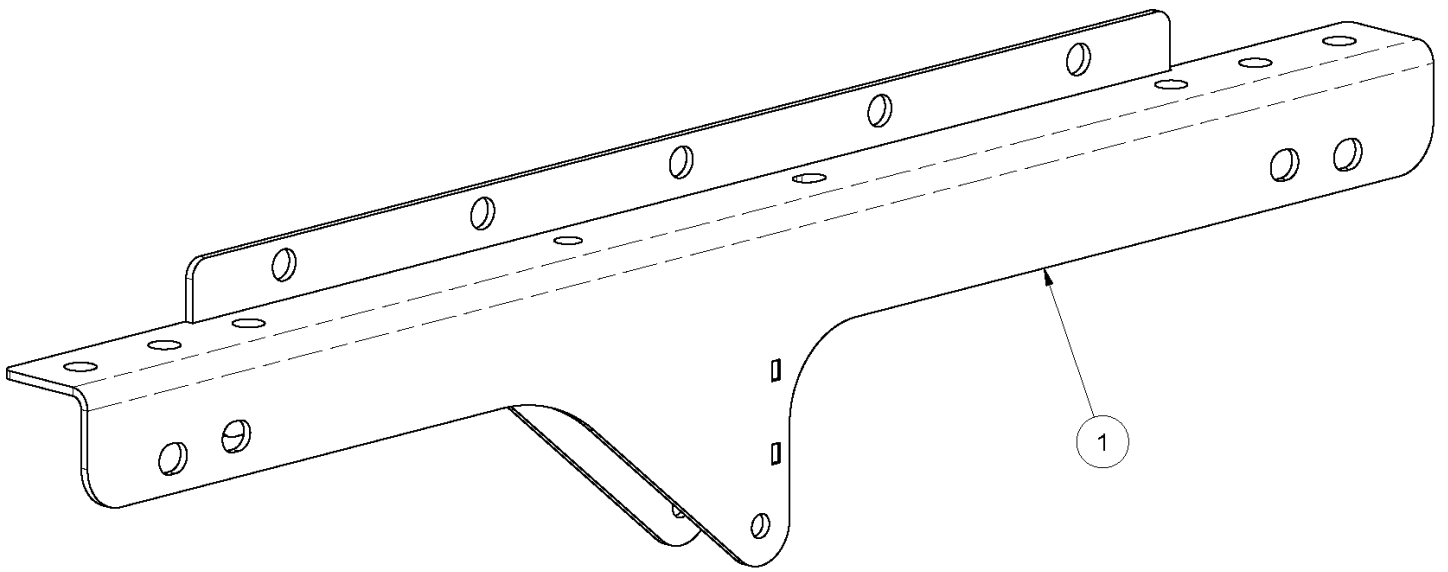

4CM00033 - SERVICE KIT – BRACKETS, REAR CAB MOUNT

ITEM	DESCRIPTION	QTY
1	BRACKET-CROSSMEMBER, CAB	1

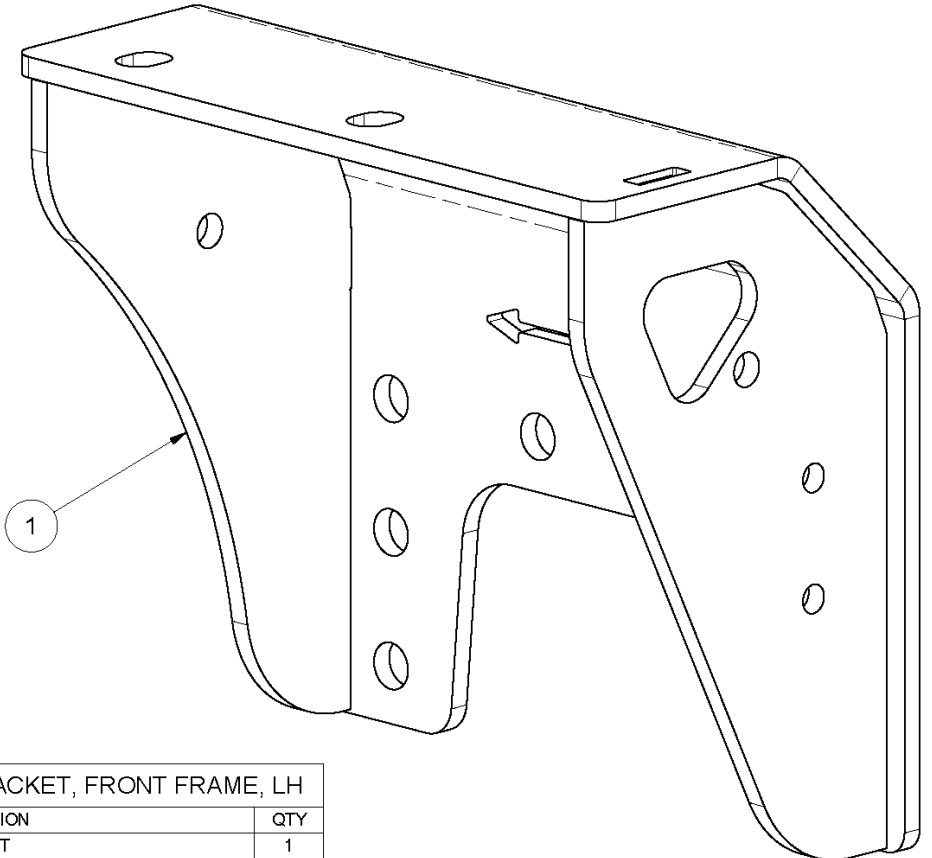

4CM00232 - SERVICE KIT – BRACKET, FRONT FRAME, LH

ITEM	DESCRIPTION	QTY
1	BRACKET-MOUNT, FRAME, LH, FRONT	1

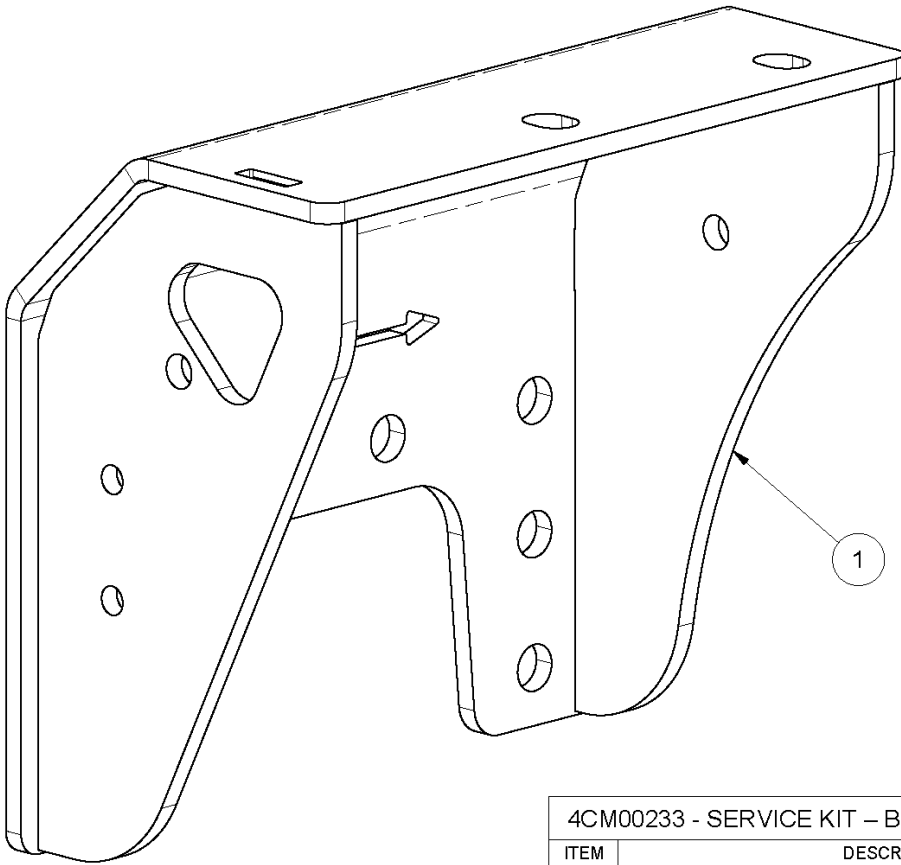

4CM00233 - SERVICE KIT – BRACKET, FRONT FRAME, RH		
ITEM	DESCRIPTION	QTY
1	BRACKET-MOUNT, FRAME, RH, FRONT	1



LINK MANUFACTURING, LTD.
223 15TH ST. NE, SIOUX CENTER, IA 51250
1-800-222-6283 www.linkmfg.com